

# Bartram & Co



Apartment 26, Roman Corner Northampton Road, Towcester, NN12

£895 PCM -

 2  1  1  B  
Council Tax Band: B Service Charge: x Ground Rent: x



# Apartment 26, Roman Corner Northampton Road

Towcester, NN12 6LD

- A Modern Apartment On The Third Floor
- Open Plan Lounge/Kitchen/Diner
- Two Bedrooms With Built-in Cupboards
- A Communal Courtyard For All Tenants
- EPC Energy Rating: B
- In A Sought After Central Location
- 'Parker' Fitted Kitchen With Integrated Appliances
- Stunning Bathroom With A Shower
- Council Tax Band: B
- No Holding Payment Required

A modern open plan one/two bedroom apartment located in an un-rivalled central location, just a few yards from local amenities and open countryside walks. Finished to a high specification, the property boasts a 'Parker' fitted kitchen with a comprehensive range of integrated appliances, engineered oak flooring, and a bathroom with shower. This centrally heated property also has a security intercom system and double-glazed sash windows throughout.



## LOCATION:

## COMMUNAL HALLWAY:

**HALLWAY:** 3'6" x 9'5" (1.067 x 2.860)

**OPEN PLAN LIVING AREA:** 20'11" x 12'8" (6.366 x 3.869)

**BATHROOM:** 6'6" x 6'3" (1.987 x 1.917)

**BEDROOM ONE:** 10'1" max x 9'4" (3.070 max x 2.849)

**DRESSING ROOM/STUDY:** 6'3" x 9'8" (1.914 x 2.952)

## TENANT FEES:



# ROMAN CORNER

Directions





## Floor Plans

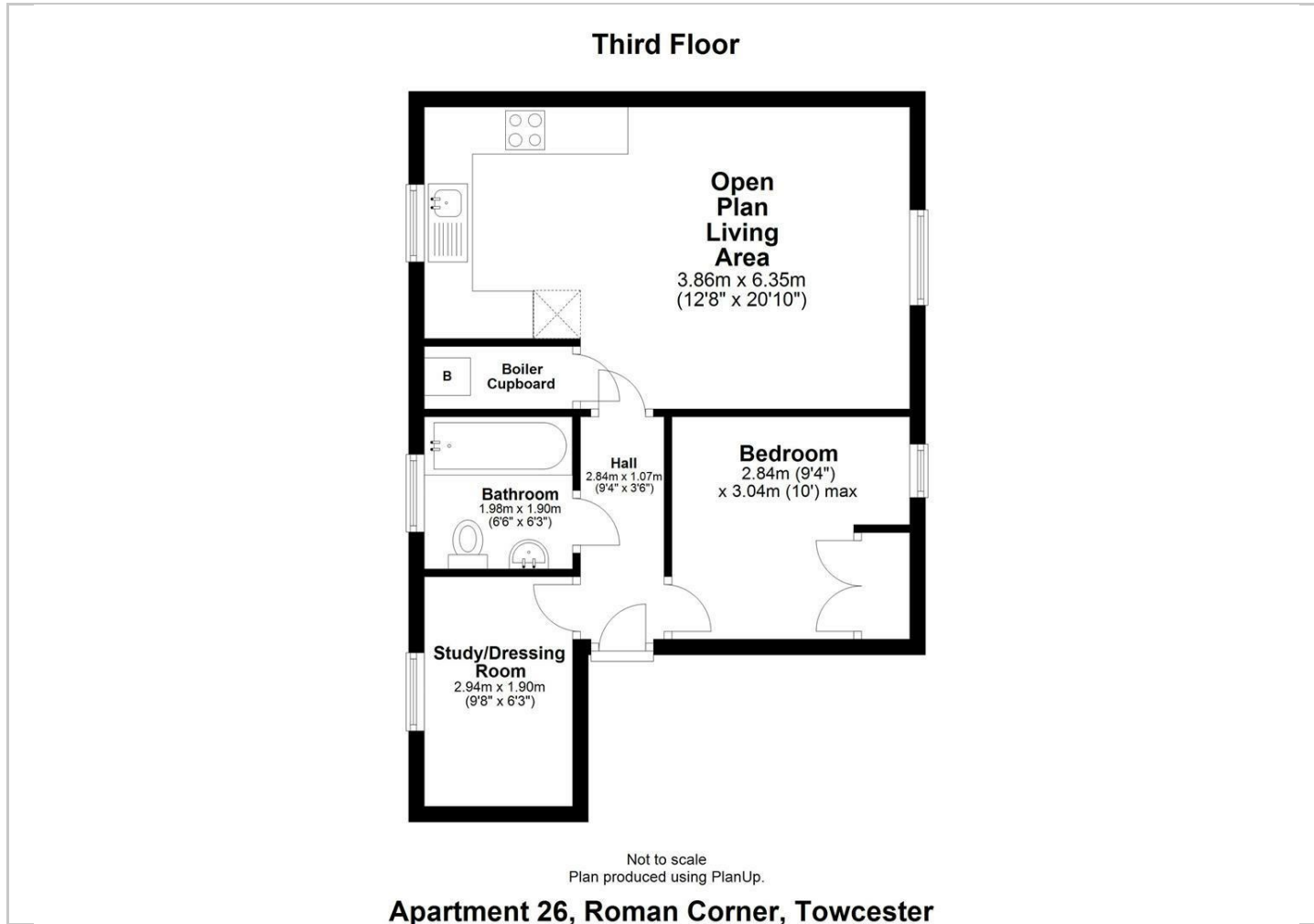

## Viewing

Please contact our Towcester Lettings Office on 01327359164 if you wish to arrange a viewing appointment for this property or require further information.

The particulars are set out as a general outline only for the guidance of intended purchasers or lessees, and do not constitute, any part of a contract. Nothing in these particulars shall be deemed to be a statement that the property is in good structural condition or otherwise nor that any of the services, appliances, equipment or facilities are in good working order. Purchasers should satisfy themselves of this prior to purchasing.

Town Hall, 86 Watling Street East, Towcester, Northamptonshire, NN12 6BS  
Tel: 01327359164 Email: towcesterlettings@bartramandco.co.uk <https://www.bartramandco.co.uk>

## Location Map

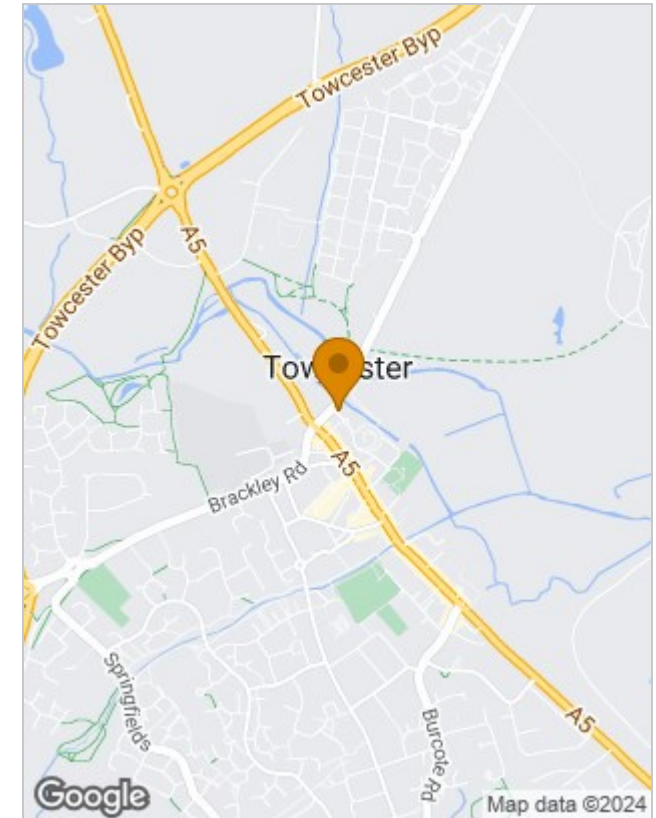

## Energy Performance Graph

