

Bartram & Co



Flat 5, Lawers Court 1 Columbia Place, Milton Keynes, MK9 4BE

£1,200 Per Month -

 1  1  1  B

Council Tax Band: B Service Charge: x Ground Rent: x



£1,200 Per Month

Flat 5, Lawers Court 1 Columbia Place

Milton Keynes, MK9 4BE

- A One Bedroom Apartment
- In A Sought After Central Location
- EPC Energy Rating: B
- Holding Payment: £276.00
- On The First Floor With A Balcony
- With A Secure Underground Parking Space
- Council Tax Band: B

Bartram & Co are pleased to present this one bedroom first floor apartment located at Campbell Park, situated in Central Milton Keynes offering close proximity to the central shopping district, restaurants, bars and all local amenities.



OPEN PLAN LOUNGE/KITCHEN:

BEDROOM ONE:

BATHROOM/SHOWER ROOM:

PARKING:

GARDEN:

TENANT FEES:



Directions

Floor Plans

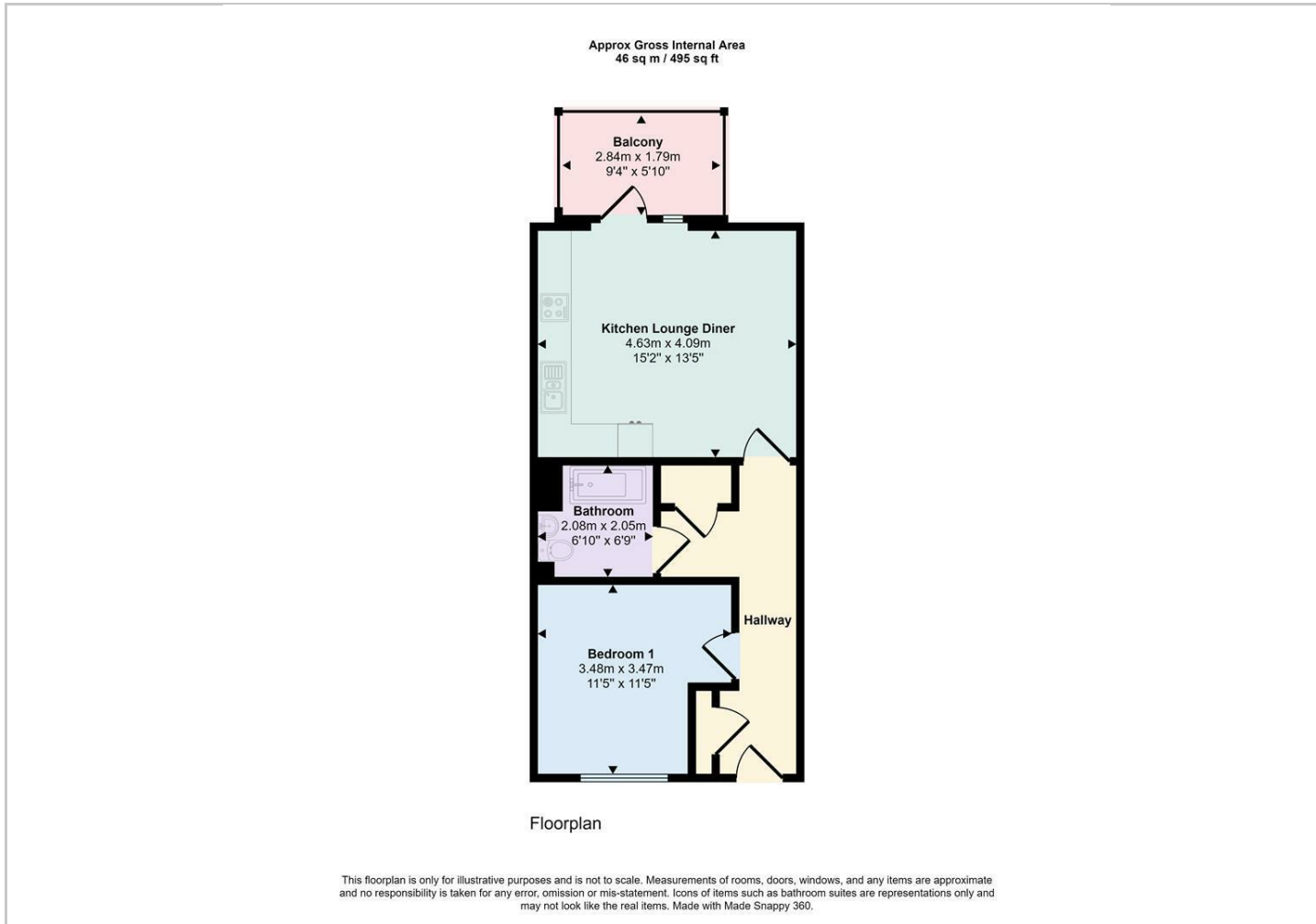

Viewing

Please contact our Towcester Office on 01327 359164 if you wish to arrange a viewing appointment for this property or require further information.

The particulars are set out as a general outline only for the guidance of intended purchasers or lessees, and do not constitute, any part of a contract. Nothing in these particulars shall be deemed to be a statement that the property is in good structural condition or otherwise nor that any of the services, appliances, equipment or facilities are in good working order. Purchasers should satisfy themselves of this prior to purchasing.

Town Hall, 86 Watling Street East, Towcester, Northamptonshire, NN12 6BS
Tel: 01327 359164 Email: towcestersales@bartramandco.co.uk <https://www.bartramandco.co.uk>

Location Map

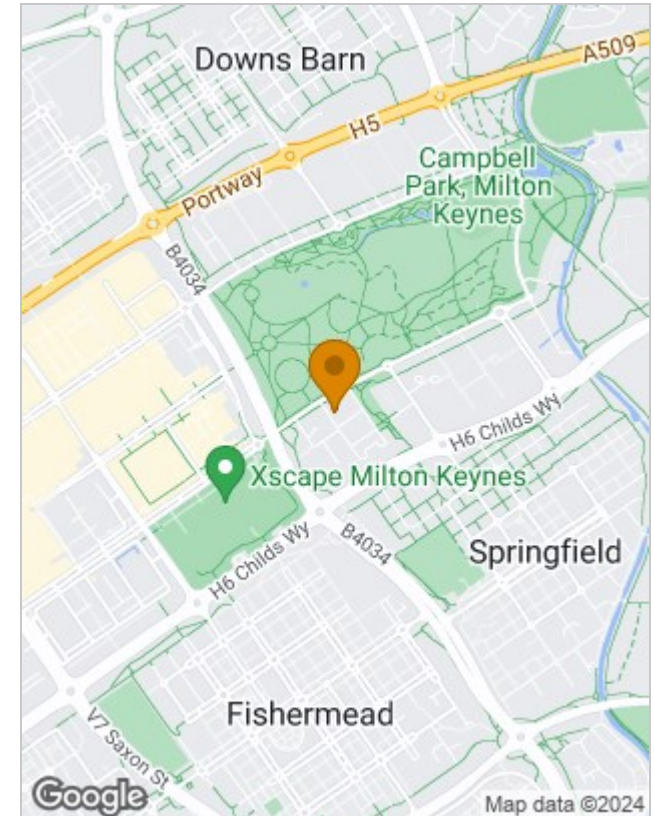

Energy Performance Graph

Energy Efficiency Rating		Current	Potential
<i>Very energy efficient - lower running costs</i>			
(92 plus) A		88	88
(81-91) B			
(69-80) C			
(55-68) D			
(39-54) E			
(21-38) F			
(1-20) G			
<i>Not energy efficient - higher running costs</i>			
England & Wales	EU Directive 2002/91/EC		