

# Bartram & Co



Flat 5, Lawers Court 1 Columbia Place, Campbell Park, MK9 4BE

Asking Price £199,950 - Leasehold

 1  1  1  B

Council Tax Band: B Service Charge: x Ground Rent: x



# Flat 5, Lawers Court 1 Columbia Place

Campbell Park, MK9 4BE

- Balcony
- Open Plan Living
- No Upper Chain
- Secure underground parking space
- One Bedroom Apartment
- City Center Location
- Epc Energy Rating : B

Bartram & Co are pleased to present this one bedroom first floor apartment located in Campbell Park, situated in Central Milton Keynes offering close proximity to the central shopping district, restaurants, bars and all local amenities.

**Bedroom 1:**

**Kitchen/Diner/Sitting Room:**

**Leasehold information:**

**Allocated Parking:**

**TENANT FEES :**

**Directions**



## Floor Plans

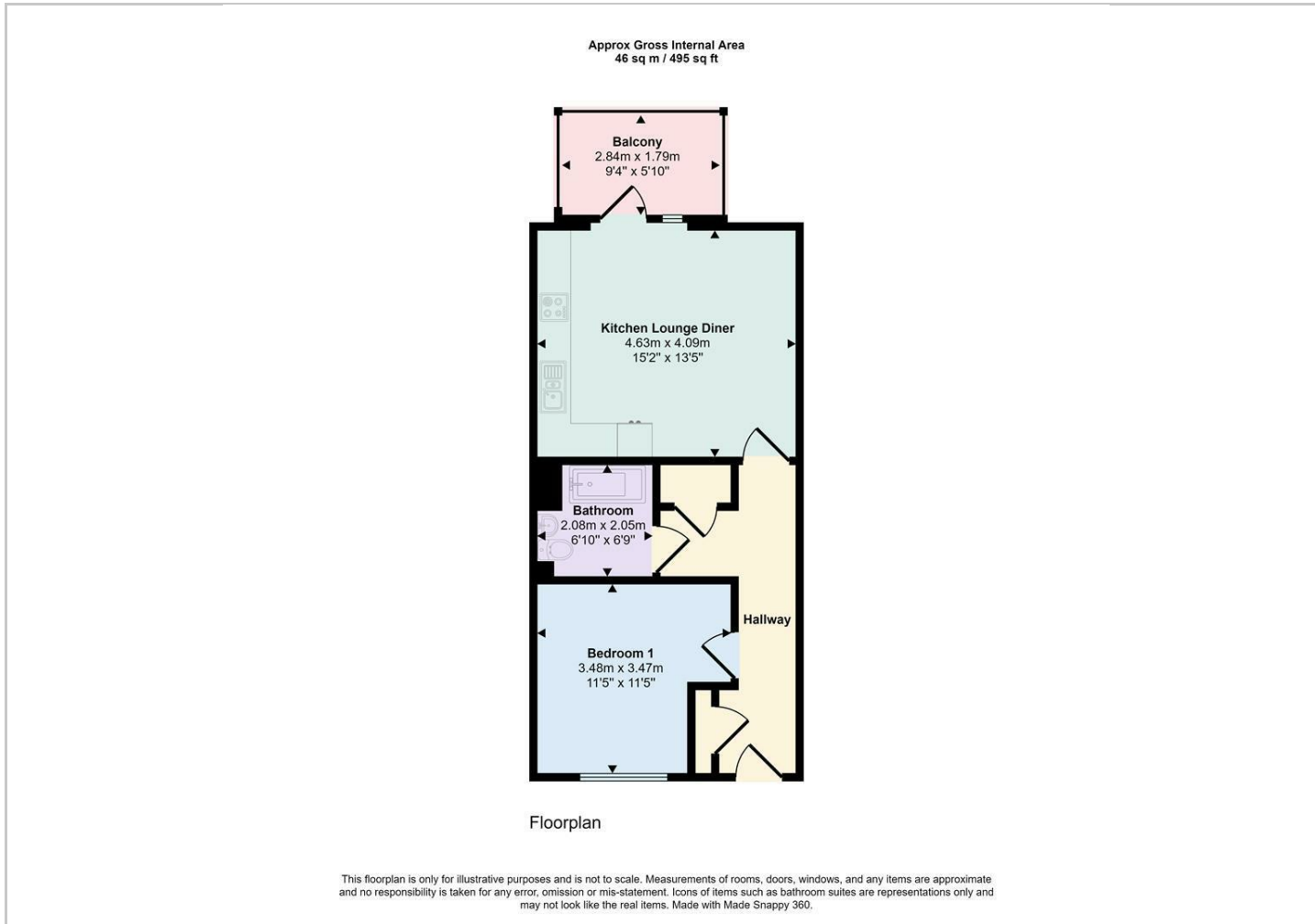

## Viewing

Please contact our Towcester Office on 01327 359164 if you wish to arrange a viewing appointment for this property or require further information.

The particulars are set out as a general outline only for the guidance of intended purchasers or lessees, and do not constitute, any part of a contract. Nothing in these particulars shall be deemed to be a statement that the property is in good structural condition or otherwise nor that any of the services, appliances, equipment or facilities are in good working order. Purchasers should satisfy themselves of this prior to purchasing.

Town Hall, 86 Watling Street East, Towcester, Northamptonshire, NN12 6BS  
Tel: 01327 359164 Email: towcestersales@bartramandco.co.uk <https://www.bartramandco.co.uk>

## Location Map

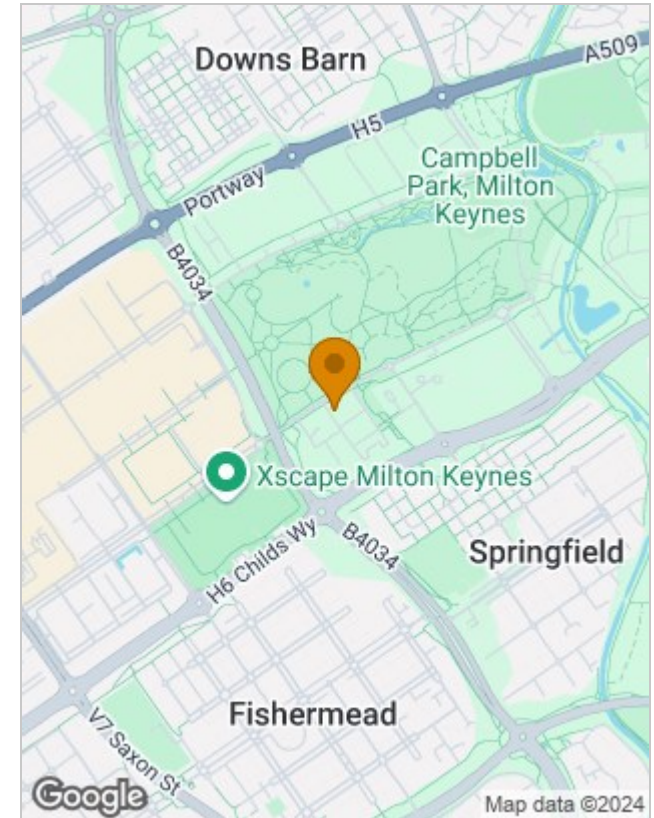

## Energy Performance Graph

