

Hamble Close

Ruislip • Middlesex • HA4 7EP
PCM: £1,800 PCM



coopers
est 1986

An EXTREMELY WELL LOCATED and SPACIOUS 2 bedroom house positioned in a QUIET RESIDENTIAL ROAD only a few minutes walk to Ruislip High Street & Tube Station (Metropolitan & Piccadilly Lines) and a similar distance to West Ruislip Station (Central and Overground Lines). This property briefly comprises; large lounge, kitchen/dining area with patio doors to the private rear garden, 2 good sized bedrooms with fitted wardrobes and a family bathroom. Other benefits include; garage, driveway, double glazing and gas central heating.

Available beginning of August and offered unfurnished.

Located On A Quiet Residential Road

Driveway

Garage

Walking Distance To Ruislip Tube Station

Double Glazing

Large Lounge

Private Rear Garden

Fitted Wardrobes

Unfurnished

Available Date

8th July 2024

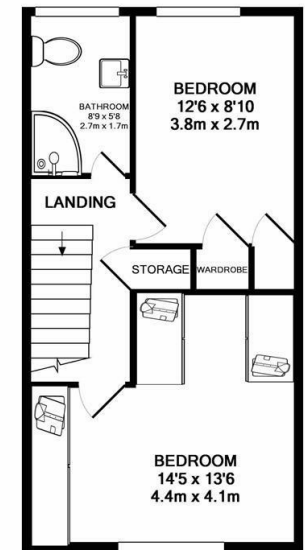
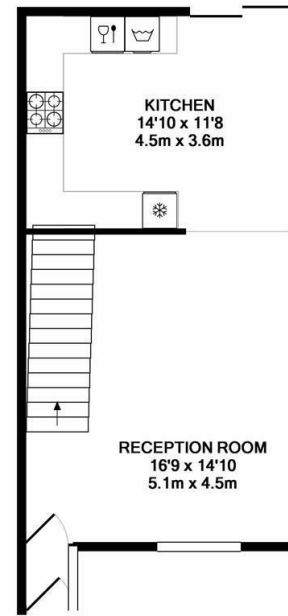

GROUND FLOOR
APPROX. FLOOR
AREA 430 SQ.FT.
(39.9 SQ.M.)

1ST FLOOR
APPROX. FLOOR
AREA 410 SQ.FT.
(38.1 SQ.M.)

TOTAL APPROX. FLOOR AREA 840 SQ.FT. (78.0 SQ.M.)

Whilst every attempt has been made to ensure the accuracy of the floor plan contained here, measurements of doors, windows, rooms and any other items are approximate and no responsibility is taken for any error, omission, or mis-statement. This plan is for illustrative purposes only and should be used as such by any prospective purchaser. The services, systems and appliances shown have not been tested and no guarantee as to their operability or efficiency can be given.
Made with Metropix ©2018



coopers
est 1986

01895 625 625

**126-128 High Street, Ruislip,
Middlesex, HA4 8LL**

rl@coopersresidential.co.uk

CoopersResidential.co.uk

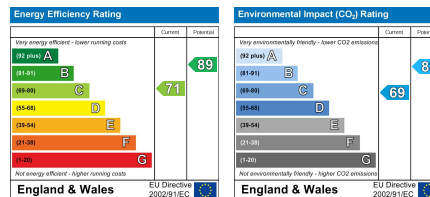

Important Notice: These particulars, whilst believed to be accurate are set out as a general outline only for guidance and do not constitute any part of an offer or contract. Intending purchasers should not rely on them as statements or representation of fact, but must satisfy themselves by inspection or otherwise has the authority to make or give any representation or warranty in respect of the property.