

Cranston Close

Ickenham • Middlesex • UB10 8TH

PCM: £1,350 PCM



coopers
est 1986

Cranston Close is a popular residential cul de sac located within walking distance to both West Ruislip and Ickenham tube stations, on the Central/BR and Metropolitan / Piccadilly lines with easy access into central London, as well as the Chiltern Railway which runs from West Ruislip to Marylebone. There are a selection of shops, restaurants and pubs in Ickenham village which is nearby.

Top floor apartment

Good condition

Popular location

Modern fitted kitchen

Bathroom

Fitted wardrobes

Unfurnished

Moments from West Ruislip Station

Available middle of October

Available Date

15th October 2025

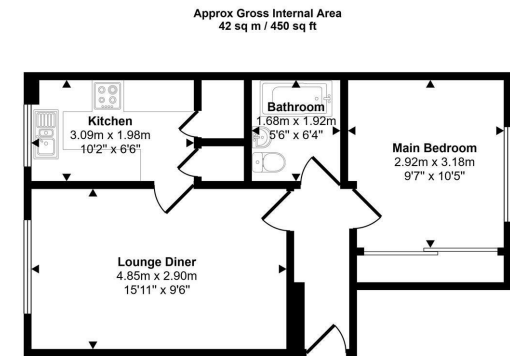

Floorplan

This floorplan is only for illustrative purposes and is not to scale. Measurements of rooms, doors, windows, and any items are approximate and no responsibility is taken for any error, omission or mis-statement. Icons of items such as bathroom suites are representations only and may not look like the real items. Made with Made Snappy 360.

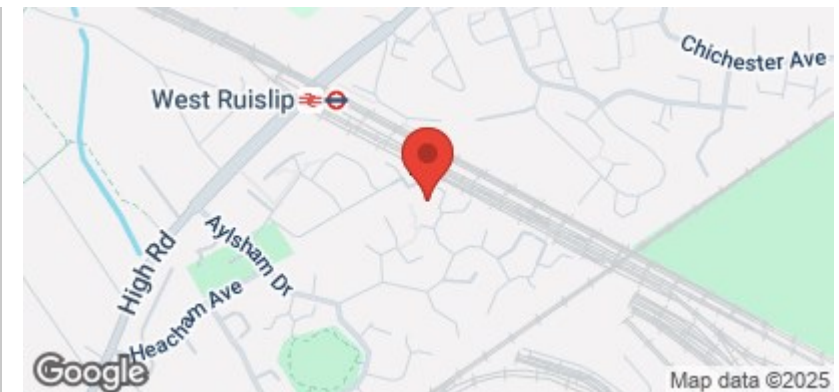

coopers
est 1986

01895 625 625

**126-128 High Street, Ruislip,
Middlesex, HA4 8LL**

rl@coopersresidential.co.uk

CoopersResidential.co.uk

Energy Efficiency Rating		Current	Potential	Environmental Impact (CO ₂) Rating		Current	Potential		
Very energy efficient - lower running costs	(91-100) A	68	73	Very environmentally friendly - lower CO ₂ emissions	(91-100) A				
	(81-90) B				(91-100) A				
	(69-80) C				(81-90) B				
	(55-68) D				(69-80) C				
	(39-54) E				(55-68) D				
	(21-38) F				(39-54) E				
	(1-20) G				(21-38) F				
Not energy efficient - higher running costs				Not environmentally friendly - higher CO ₂ emissions					
England & Wales		EU Directive 2002/91/EC		England & Wales		EU Directive 2002/91/EC			

Important Notice: These particulars, whilst believed to be accurate are set out as a general outline only for guidance and do not constitute any part of an offer or contract. Intending purchasers should not rely on them as statements or representation of fact, but must satisfy themselves by inspection or otherwise has the authority to make or give any representation or warranty in respect of the property.