

Elm Avenue

Ruislip • • HA4 8PE

PCM: £2,700 PCM



coopers
est 1986



Elm Avenue, Ruislip, HA4 8PE
 Main house gross internal area = 1226 sq ft / 113.8 sq m
 Garage gross internal area = 77 sq ft / 7.1 sq m
 Total gross internal area = 1303 sq ft / 121 sq m

Perfectly positioned for Eastcote High Street, excellent transport facilities and a number of local schools, is this four-bedroom semi-detached home offering generous sized interiors throughout, a secluded garden and off-street parking.

The ground floor comprises of an entrance hall and WC, a spacious dual aspect reception room with access to the garden, a modern fitted kitchen and spacious downstairs bedroom. To the first floor there are three generous sized bedrooms and a shower room. Externally the property offers a secluded garden that's laid to lawn with shrub borders. To the front there is a driveway providing off street parking for multiple cars and a garage.

Elm Avenue is ideally located for Eastcote, Ruislip Manor and Ruislip High Street, all of which offer a wide range of shopping facilities, restaurants and coffee houses for you to enjoy.

Four Bedroom Semi Detached House

Spacious Interiors

Immaculate Condition

Neutral Tones Throughout

Large Garage

Secluded Private Garden

Driveway Parking

Close To a Number of Transport Links

1303 sqft

Council Tax Band E

Available Date

17th April 2025

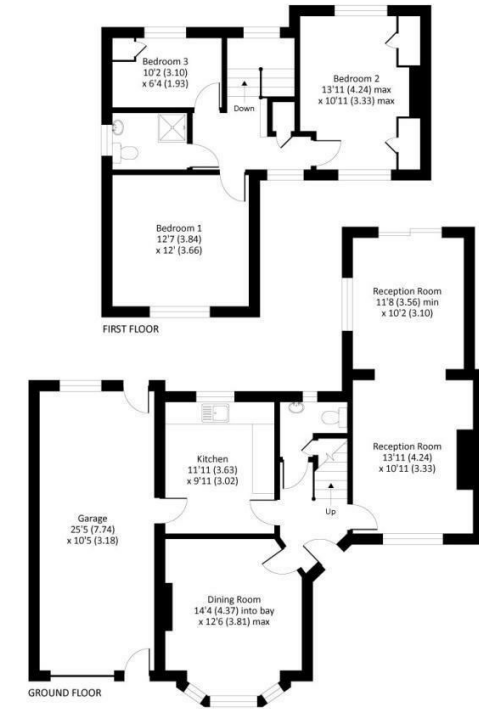

Whilst every attempt has been made to ensure the accuracy of the floor plan contained here, measurements of doors, windows and rooms are approximate and no responsibility is taken for any error, omission or misstatement. These plans are for representation purposes only as defined by RICS Code of Measuring Practice and should not be used as such by any prospective purchaser. Specifically no guarantee is given on the total square footage of the property if quoted on this plan. Any figure given is for initial guidance only and should not be relied on as a basis of valuation. © 2019 nichecom.co.uk | Produced for Gibbs Gillespie | Drawing No 546456



coopers
est 1986

01895 625 625

126-128 High Street, Ruislip,
Middlesex, HA4 8LL

rl@coopersresidential.co.uk

CoopersResidential.co.uk

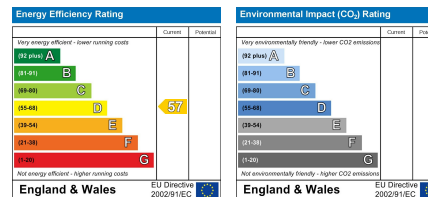

Important Notice: These particulars, whilst believed to be accurate are set out as a general outline only for guidance and do not constitute any part of an offer or contract. Intending purchasers should not rely on them as statements or representation of fact, but must satisfy themselves by inspection or otherwise has the authority to make or give any representation or warranty in respect of the property.