

# Kingswear Road

Ruislip • Middlesex • HA4 6AY

PCM: £1,850 PCM



coopers  
est 1986





An IMMACULATELY PRESENTED two bedroom mid terraced house within CLOSE DISTANCE of both Ruislip Manor and Ruislip Gardens offering CONVENIENT ACCESS to the Metropolitan/Piccadilly/Central lines .

The ground floor briefly comprises GOOD SIZED LOUNGE and a fully fitted kitchen dining area. Upstairs to the first floor are two DOUBLE BEDROOMS and a family bathroom. The garden has a patio area which leads down to lawn and large garage to rear. This wonderful property is set on a quiet residential road and is offered unfurnished.

Immaculately Presented

Close To Ruislip Manor Tube Station

Private Rear Garden

Gas Central Heating

Modern Tiled Family Bathroom

Neutrally Decorated Throughout

Fitted Kitchen

Double Glazing

Unfurnished

**Available Date**

24th May 2025



GROUND FLOOR

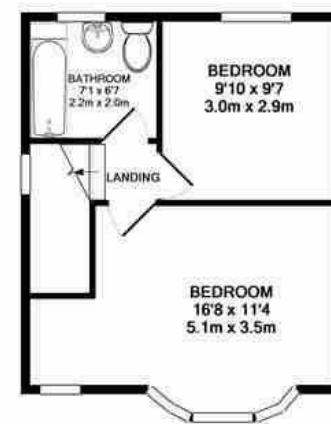

1ST FLOOR

Whilst every attempt has been made to ensure the accuracy of the floor plan contained here, measurements of doors, windows, rooms and any other items are approximate and no responsibility is taken for any error, omission, or mis-statement. This plan is for illustrative purposes only and should be used as such by any prospective purchaser. The services, systems and appliances shown have not been tested and no guarantee as to their operability or efficiency can be given.  
Made with Metropix ©2014



**coopers**  
est 1986

**01895 625 625**

**126-128 High Street, Ruislip,  
Middlesex, HA4 8LL**  
rl@coopersresidential.co.uk

**CoopersResidential.co.uk**

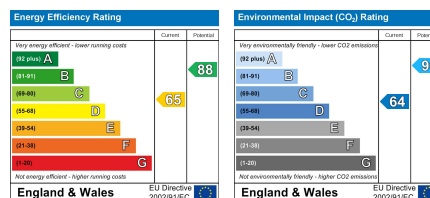

Important Notice: These particulars, whilst believed to be accurate are set out as a general outline only for guidance and do not constitute any part of an offer or contract. Intending purchasers should not rely on them as statements or representation of fact, but must satisfy themselves by inspection or otherwise has the authority to make or give any representation or warranty in respect of the property.