

# Astral House

Ruislip • Middlesex • HA4 6SE  
PCM: £1,650 PCM



coopers  
est 1986

An IMMACULATELY presented two bedroom, two bathroom apartment in Astral House. Upon entrance to the flat there is a MODERN FAMILY BATHROOM. Beyond this there is the LIVING SPACE which has been arranged with a living/dining area and modern kitchen. There is a large master bedroom with fitted wardrobes and en-suite shower room. The second bedroom is also spacious and also benefits from fitted wardrobes. Outside of the property there are allocated parking bays for residents.

Within walking distance of South Ruislip Tube Station (Chiltern and Central Lines) and only a short drive to the A40/M40/M25 motorway junctions.

Offered furnished.

Set in Astral House

Underfloor Heating

Off Street Parking

En-Suite

Spacious

Close To South Ruislip Station

Short Drive To A40 Junction

Double Glazing

Furnished

Available beginning of November

**Available Date**

6th November 2022

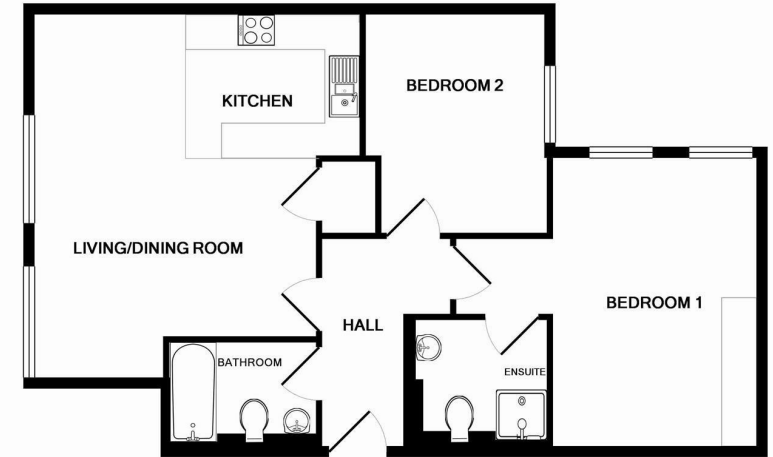

TOTAL APPROX. FLOOR AREA 708 SQ.FT. (65.8 SQ.M.)

Whilst every attempt has been made to ensure the accuracy of the floor plan contained here, measurements of doors, windows, rooms and any other items are approximate and no responsibility is taken for any error, omission, or mis-statement. This plan is for illustrative purposes only and should be used as such by any prospective purchaser. The services, systems and appliances shown have not been tested and no guarantee as to their operability or efficiency can be given  
Made with Metropix ©2015



**coopers**  
est 1986

**01895 625 625**

**126-128 High Street, Ruislip,  
Middlesex, HA4 8LL**

[rl@coopersresidential.co.uk](mailto:rl@coopersresidential.co.uk)

**CoopersResidential.co.uk**

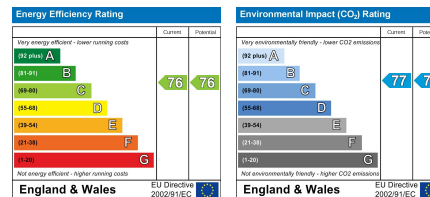

Important Notice: These particulars, whilst believed to be accurate are set out as a general outline only for guidance and do not constitute any part of an offer or contract. Intending purchasers should not rely on them as statements or representation of fact, but must satisfy themselves by inspection or otherwise has the authority to make or give any representation or warranty in respect of the property.