

Osbourne Court

Ruislip • Middlesex • HA4 7DA
PCM: £1,800 PCM



coopers
est 1986



Coopers are delighted to offer to the market this SUPERBLY PRESENTED and LARGER THAN AVERAGE two bedroom EXECUTIVE APARTMENT set in a HIGHLY SOUGHT after development situated just a stones throw away from Ruislip High Street and station. Accommodation comprises of entrance hallway leading to MODERN fitted kitchen, separate SPACIOUS reception room, master bedroom with wardrobes and ENSUITE, CONTEMPORARY family bathroom and second bedroom. This IMMACULATE property also has the benefits of gas central heating, double glazing and residents parking.

Available end of September, unfurnished.

Spacious

Ensuite

Superb location in Ruislip

Modern

Stunning kitchen area

First floor

Private parking

Moments walk from Ruislip Station

Unfurnished

Available end of September

Available Date

25th September 2024

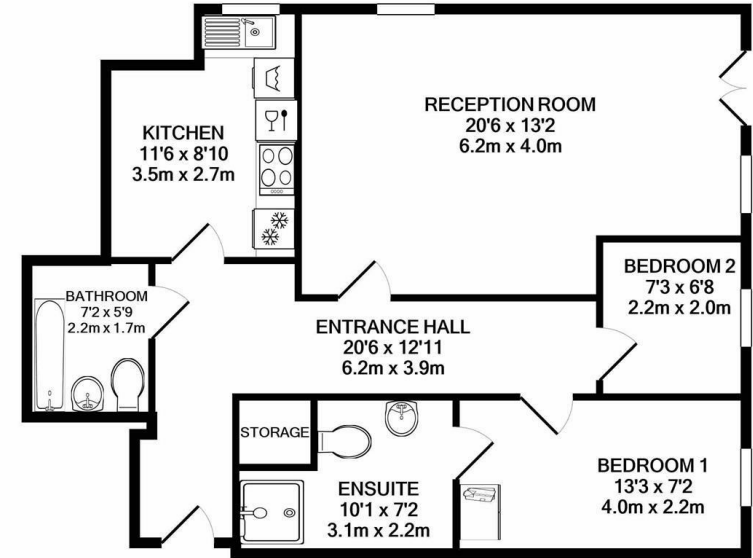

TOTAL APPROX. FLOOR AREA 732 SQ.FT. (68.0 SQ.M.)

Whilst every attempt has been made to ensure the accuracy of the floor plan contained here, measurements of doors, windows, rooms and any other items are approximate and no responsibility is taken for any error, omission, or mis-statement. This plan is for illustrative purposes only and should be used as such by any prospective purchaser. The services, systems and appliances shown have not been tested and no guarantee as to their operability or efficiency can be given
Made with Metropix ©2020



coopers
est 1986

01895 625 625

126-128 High Street, Ruislip,
Middlesex, HA4 8LL
rl@coopersresidential.co.uk

CoopersResidential.co.uk

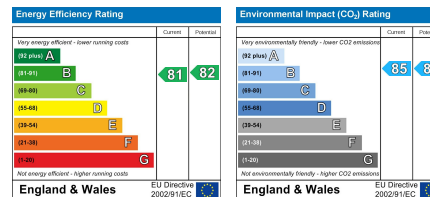

Important Notice: These particulars, whilst believed to be accurate are set out as a general outline only for guidance and do not constitute any part of an offer or contract. Intending purchasers should not rely on them as statements or representation of fact, but must satisfy themselves by inspection or otherwise has the authority to make or give any representation or warranty in respect of the property.