

Milman Close

Pinner • Middlesex • HA5 3LF

PCM: £1,700 PCM



coopers
est 1986

SUPERBLY presented two DOUBLE bedroom first floor flat located in a POPULAR purpose built block off Pinner High Street with its array of shopping, restaurants and Tube Station (met line). This SPACIOUS, MODERN property comprises of: Two double bedrooms, lounge, modern kitchen with utility area, bathroom with shower, gas central heating, double glazing and residents parking.

Available in August, part furnished.

Moments from Pinner High Street
Walking distance to Pinner Station

Spacious

Prime location

Amenities

Modern kitchen

First floor

Residents parking

Part furnished

Available end of August

Available Date

23rd August 2024

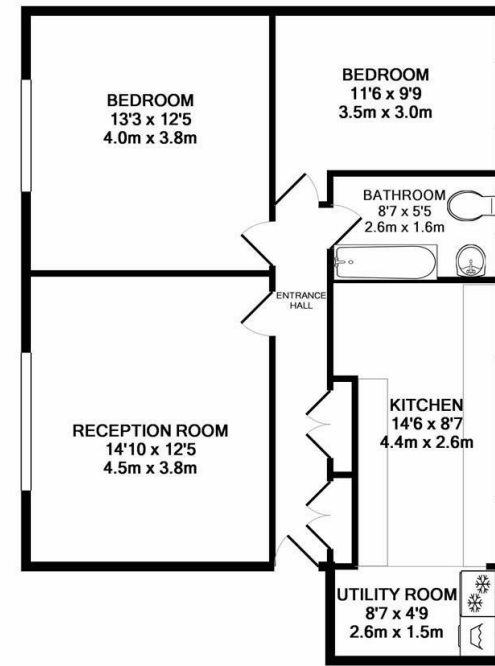

TOTAL APPROX. FLOOR AREA 713 SQ.FT. (66.2 SQ.M.)

Whilst every attempt has been made to ensure the accuracy of the floor plan contained here, measurements of doors, windows, rooms and any other items are approximate and no responsibility is taken for any error, omission, or mis-statement. This plan is for illustrative purposes only and should be used as such by any prospective purchaser. The services, systems and appliances shown have not been tested and no guarantee as to their operability or efficiency can be given
Made with Metropix ©2019



coopers
est 1986

01895 625 625

126-128 High Street, Ruislip,
Middlesex, HA4 8LL
rl@coopersresidential.co.uk

CoopersResidential.co.uk

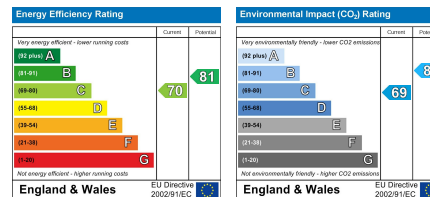

Important Notice: These particulars, whilst believed to be accurate are set out as a general outline only for guidance and do not constitute any part of an offer or contract. Intending purchasers should not rely on them as statements or representation of fact, but must satisfy themselves by inspection or otherwise has the authority to make or give any representation or warranty in respect of the property.