

Royal Court

Ruislip • Middlesex • HA4 8AT
PCM: £1,975 PCM



coopers
est 1986

Well presented three bedroom first floor apartment forming part of this popular gated development ideally located for Ruislip High Street, Eastcote Village and Metropolitan & Piccadilly Line Tube Stations. This executive flat comprises of: Three bedrooms (en-suite to master), lounge with Juliet balcony, kitchen with appliances, bathroom, gated residence parking and communal gardens.

Available furnished.

Three bedrooms

South after gated development

Spacious

Modern kitchen

Parking

Within catchment of fantastic schools

Juliet balcony

First floor

Easy access to Ruislip High Street

Available middle of August

Available Date

13th July 2024



781 sq.ft. (72.6 sq.m.) approx.

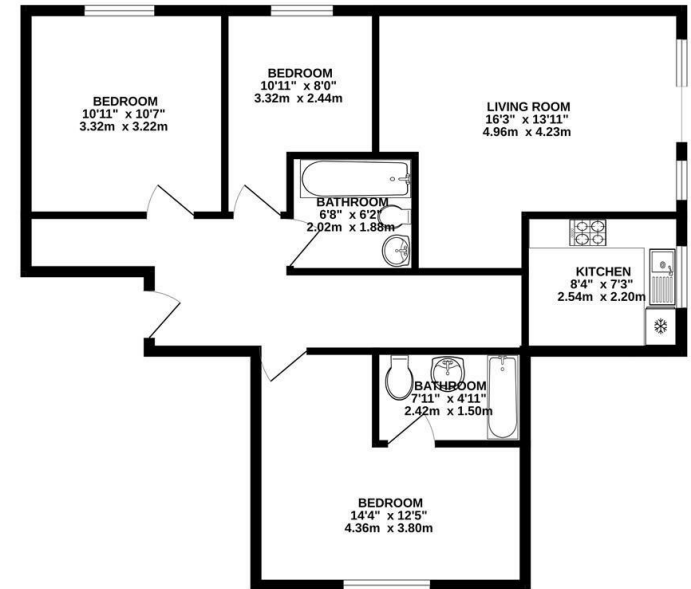

TOTAL FLOOR AREA: 781 sq.ft. (72.6 sq.m.) approx.
 Whilst every attempt has been made to ensure the accuracy of the floorplan contained here, measurements of floor, window, doors and other items are approximate and no responsibility is taken for any error. Dimensions are approximate. This is not to be used as a basis for any prospective purchase. The services, systems and appliances shown have not been tested and no guarantee is given as to their operability or efficiency can be given.
 Made with Metropix ©2024



coopers
est 1986

01895 625 625

126-128 High Street, Ruislip,
Middlesex, HA4 8LL

rl@coopersresidential.co.uk

CoopersResidential.co.uk

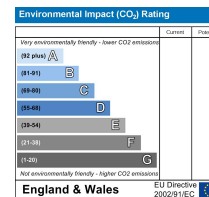
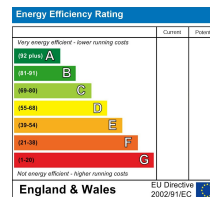

Important Notice: These particulars, whilst believed to be accurate are set out as a general outline only for guidance and do not constitute any part of an offer or contract. Intending purchasers should not rely on them as statements or representation of fact, but must satisfy themselves by inspection or otherwise has the authority to make or give any representation or warranty in respect of the property.