



Mort Bank Cottage Rampside

Barrow-In-Furness, LA13 0PX

Offers Over £360,000



Mort Bank Cottage Rampside

Barrow-In-Furness, LA13 0PX

Offers Over £360,000



Stunning bay views within a tranquil coastal setting, this extended home features contemporary finishes and a kitchen which would make anyone envious. On the fringes of the village of Rampside, the occupier can enjoy the best of country living whilst also being within easy access of Barrow and Ulverston.

Step inside this beautiful, contemporary home, on the fringes of a peaceful village location with stunning coastal views. As you enter, you are welcomed by a spacious hallway with modern finishes. The modern, fully-equipped kitchen is a chef's dream, with sleek countertops, high-end appliances, and plenty of storage. Whether preparing a family meal or hosting a dinner party, this kitchen is both functional and stylish boasting a central feature island, instant hot water and filtered water tap, wifi controlled ovens, dishwasher, washing machine, tumble dryer, wine cooler and American style fridge freezer. From the kitchen you will find a cosy reception area which could be a snug, study or play room. Towards the rear of the home, you'll find a living room with views of Morecambe Bay. The expansive family room, with large windows framing the picturesque coastal views is the perfect spot to relax and unwind, with plenty of room for seating, creating a welcoming atmosphere for family and guests. Adjacent you will find a useful WC.

Moving upstairs, you'll discover three bedrooms. The master bedroom enjoys lovely views of the coastline, making waking up a daily treat. The second and third are both to the front aspect and tastefully finished. The luxurious four-piece bathroom is your own private retreat. With a low level bath, separate shower, and modern fixtures, it's the perfect place to relax and unwind after a long day.

The beautiful garden are a perfect space for entertaining or simply enjoying the fresh coastal air. Whether it's gardening, dining al fresco, or enjoying a cup of coffee in the morning sun, the garden offers plenty of potential. Convenience is key with off-road parking for multiple vehicles.

Kitchen

18'8" x 14'2" (5.71 x 4.34)

Living Room

11'10" x 11'11" (3.62 x 3.64)

Family Room

19'7" x 12'11" (5.97 x 3.94)

Snug/Study

9'6" x 11'9" (2.92 x 3.59)

Master Bedroom

15'4" x 11'9" (4.69 x 3.59)

Bedroom Two

7'5" x 11'5" (2.28 x 3.49)

Bedroom Three

8'2" x 5'1" (2.51 x 1.56)

Bathroom

7'10" x 9'6" (2.41 x 2.91)



- Ideal Family Home
- Close to Amenities
 - Stunning Views
 - No Onward Chain
- Gas Central Heating

- Sought-after Location
- Neutral Decor Throughout
 - Off Road Parking
- Double & Triple Glazing
- Council Tax Band - C



Road Map

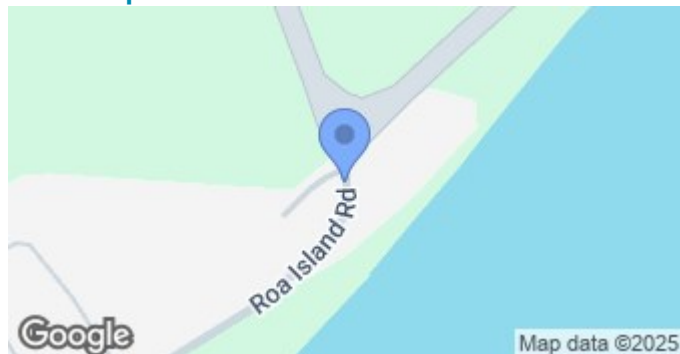

Terrain Map



Floor Plan

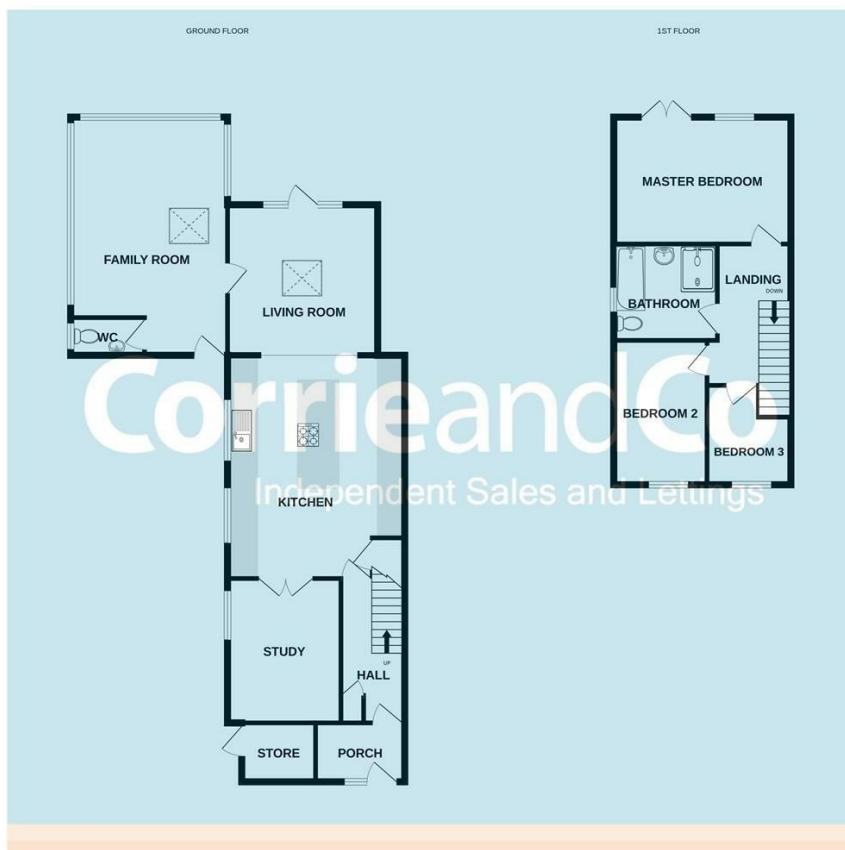

Whilst every attempt has been made to ensure the accuracy of the floorplan contained here, measurements of doors, windows, rooms and any other items are approximate and no responsibility is taken for any error, omission or mis-statement. This plan is for illustrative purposes only and should be used as such by any prospective purchaser. The services, systems and appliances shown have not been tested and no guarantee as to their operability or efficiency can be given.
Made with Metropix ©2025

Corrie and Co aim to sell your property, at the best possible price, in the shortest possible time. We have developed a clear marketing strategy, over many years, to ensure your property is exposed to all social media platforms, Rightmove, Zoopla and our own Corrie and Co website.

We also offer:

- Professional Photography
- Full promotion, throughout all our branches
- Experienced, qualified, friendly staff
- Full viewing service with feedback

To ensure your move is stress free, we can help with Mortgage advice. We work alongside local Solicitors, offering competitive conveyancing services.

We are local, family run business who are wholly independent which means we can recommend services to most suit your needs. Our aim is to provide quality advice and expertise at all times, so you can make an informed decision.

