

CorrieandCo

INDEPENDENT SALES & LETTING AGENTS



76 Southport Drive

Barrow-In-Furness, LA14 3LS

Offers In The Region Of £199,950



76 Southport Drive

Barrow-In-Furness, LA14 3LS

Offers In The Region Of £199,950



Boasting excellent views over the neighbouring cricket pitch and towards the Lakeland fells, this three bedroom semi-detached home offers well proportioned living, a contemporary and stylish kitchen and private garden plus more. The location of the property allows the occupier to enjoy the many conveniences that Walney Island has to offer including local beaches, nature reserves and pubs while also being within striking distance of major employers. Early viewings are advised.

To the front of the home, you will find a garden and driveway with space for off road parking for at least two cars.

An entrance porch leads to the hallway which provides access to the living room, kitchen and staircase. The living room boasts a large bay window allowing natural light to flood through the space. The central feature of the room is the feature gas fireplace with cream marble hearth and wood surround. The room has been decorated in a tasteful style and fitted with Oak effect laminate flooring. The dining room is open to the living room via an archway and finished in a co-ordinating style. The kitchen has been fitted with a good range of light grey concrete effect base cabinets with high gloss white wall cabinets and Carrera marble style work surfaces with upstands. The floors have been finished in a grey Herringbone style and the integrated appliances include an electric single oven, four ring induction hob and microwave.

To the first floor you will find three bedrooms and a bathroom. The first and second bedrooms are good size doubles with the Master benefitting from a bay window. The third bedroom is a single which boasts views over the cricket fields and towards the Lakeland fells. The three-piece bathroom suite comprises a low-level bath with thermostatic shower and glass screen, close couple WC and pedestal sink with full low maintenance cladding to the walls.

The rear garden is an area to enjoy privacy, peace and tranquillity. The space has been laid mostly to lawn with a good size patio and timber shed for storage.

Porch

6'4" x 3'11" (1.95 x 1.20)

Entrance Hall

10'0" x 5'10" (3.06 x 1.80)

Living Room

12'4" x 11'8" (3.76 x 3.56)

Dining Room

12'3" x 10'7" (3.75 x 3.25)

Kitchen

10'0" x 7'2" (3.05 x 2.20)

First Floor Landing

6'9" x 5'10" (2.08 x 1.79)

Bedroom One

12'5" x 10'11" (3.79 x 3.34)

Bedroom Two

11'1" x 10'0" (3.38 x 3.07)

Bedroom Three

6'11" x 6'10" (2.13 x 2.09)

Bathroom

6'9" x 6'8" (2.06 x 2.05)



- Open Views to Rear
- Gardens Front and Rear
 - Modern Finishes
 - Island Location
 - Gas Central Heating
- Off Road Parking
- Contemporary Kitchen
- Close to BAE Systems
 - Double Glazing
 - Council Tax Band - B



Road Map

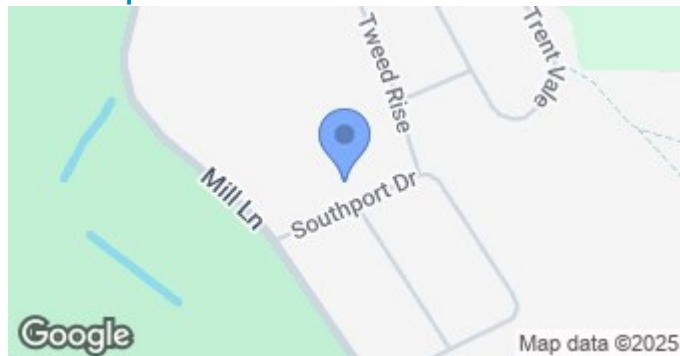

Terrain Map

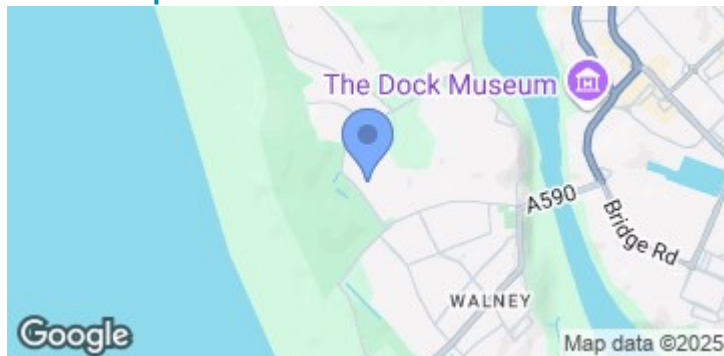

Floor Plan

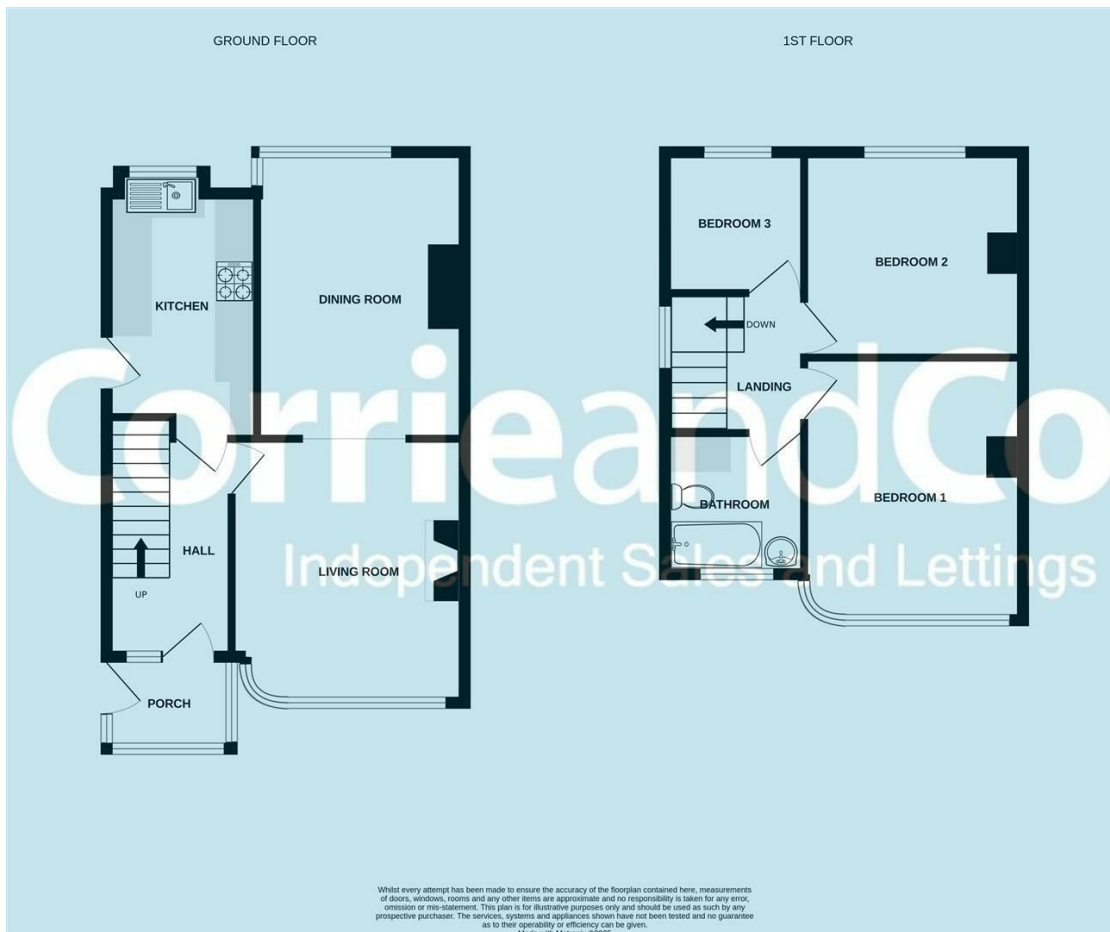

Corrie and Co aim to sell your property, at the best possible price, in the shortest possible time. We have developed a clear marketing strategy, over many years, to ensure your property is exposed to all social media platforms, Rightmove, Zoopla and our own Corrie and Co website.

We also offer:

- Professional Photography
- Full promotion, throughout all our branches
- Experienced, qualified, friendly staff
- Full viewing service with feedback

To ensure your move is stress free, we can help with Mortgage advice. We work alongside local Solicitors, offering competitive conveyancing services.

We are local, family run business who are wholly independent which means we can recommend services to most suit your needs. Our aim is to provide quality advice and expertise at all times, so you can make an informed decision.

