

CorrieandCo

INDEPENDENT SALES & LETTING AGENTS



14 Lime Street

Barrow-in-Furness, LA14 5EF

Price Guide £105,000



14 Lime Street

Barrow-in-Furness, LA14 5EF
Price Guide £105,000



This three bedroom terraced house is ideally situated in a convenient location close to a range of amenities. Perfect for various types of buyers, from first-time homeowners to investors, this property boasts neutral decor throughout, offering a blank canvas for personalisation. With no onward chain, this house promises a smooth and swift move-in process. Its prime location and ready-to-move-in status make it a highly attractive option for those seeking a comfortable and convenient living experience.

As you enter the property, you arrive into a hallway which provides access to the front lounge/bedroom and rear reception. These have both been neutrally decorated. The rear lounge boasts a feature fireplace. The kitchen leads off from the rear reception and has been fitted with wall and base units with laminate work surfaces. The ground floor bathroom has been fitted with a three piece suite comprising of a low level flush WC, pedestal sink and a bath with an over bath shower attachment.

From the rear lounge is access to the first floor and offers three good sized bedrooms all neutrally decorated and carpeted throughout.

Reception One/Bedroom

10'1" x 8'3" (3.08 x 2.53)

Reception Two

11'10" x 12'0" (3.63 x 3.68)

Kitchen

5'11" x 9'11" (1.81 x 3.04)

Bathroom

5'6" x 7'4" (1.70 x 2.24)

Bedroom One

10'1" x 10'7" (3.09 x 3.23)

Bedroom Two

12'2" x 8'9" (3.71 x 2.68)

Bedroom Three

6'0" x 9'9" (1.83 x 2.99)



- Neutral Décor Throughout
 - Close to Transport
 - Rear Yard
 - No Chain
 - Council Tax Band - A
- Ideal For a Range of Buyers
 - Close to Amenities
 - Currently an Air B&B
 - Double Glazed
 - Gas Central Heating



Road Map

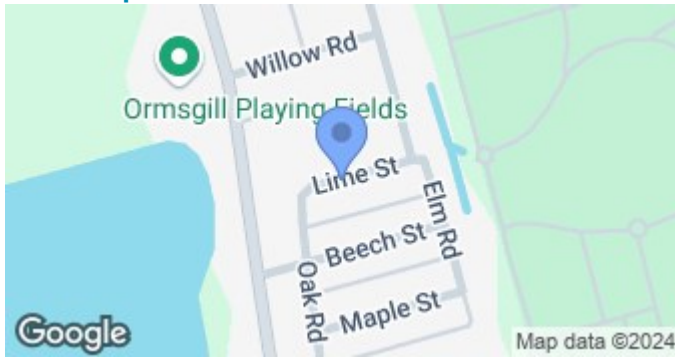

Terrain Map

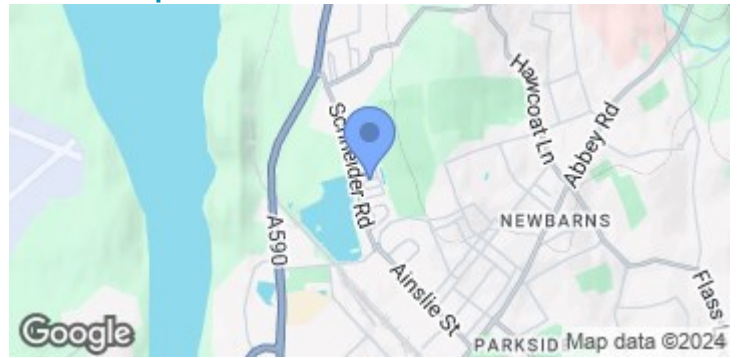

Floor Plan

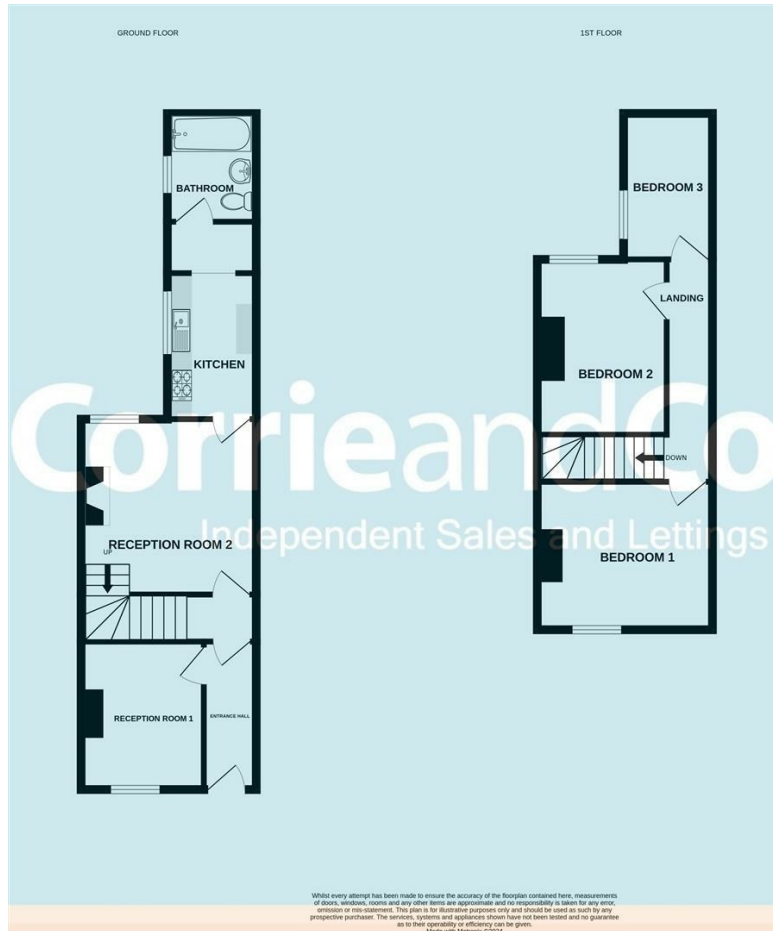

Whilst every attempt has been made to ensure the accuracy of the floorplan contained here, measurements of floors, windows, rooms and any other items are approximate and no responsibility is taken for any error, omission or mis-statement. This plan is for illustrative purposes only and should be used as such by any prospective purchaser. The services, systems and appliances shown here have not been tested and no guarantee as to their operability or efficiency can be given.
Made with Mapbox ©2024

Corrie and Co aim to sell your property, at the best possible price, in the shortest possible time. We have developed a clear marketing strategy, over many years, to ensure your property is exposed to all social media platforms, Rightmove, Zoopla and our own Corrie and Co website.

We also offer:

- Professional Photography
- Full promotion, throughout all our branches
- Experienced, qualified, friendly staff
- Full viewing service with feedback

To ensure your move is stress free, we can help with Mortgage advice. We work alongside local Solicitors, offering competitive conveyancing services.

We are local, family run business who are wholly independent which means we can recommend services to most suit your needs. Our aim is to provide quality advice and expertise at all times, so you can make an informed decision.

