

CorrieandCo

INDEPENDENT SALES & LETTING AGENTS

gallery

Water Lily Chinese Takeaway

Water Lily
Chinese Takeaway
Tel: 831 877

The Gallery 41 Cavendish Street

Barrow-In-Furness, LA14 1SF

£15,000 Per Annum



The Gallery 41 Cavendish Street



Description

Located in this established retail area in the heart of Barrow town centre. The property benefits from a retail area, stores, cloakroom and rooms to the first floor and two further rooms to the second floor.

- Three Storey Shop
- Spacious Premises
- Rateable Value - £7,800
- Heart of Barrow Town Centre
- Open Plan Retail Space





Floor Plan

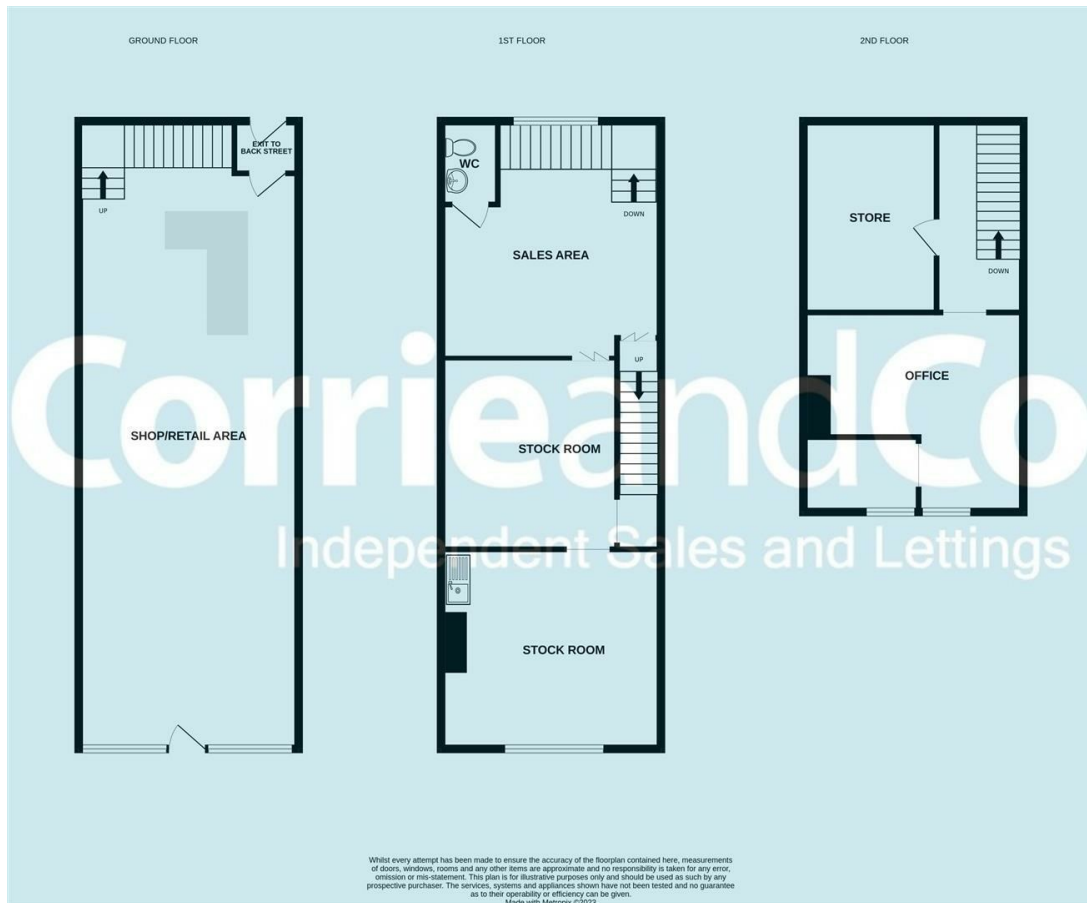

Area Map

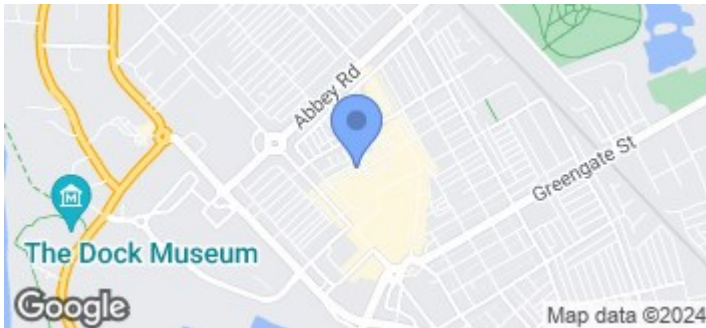

Hybrid Map

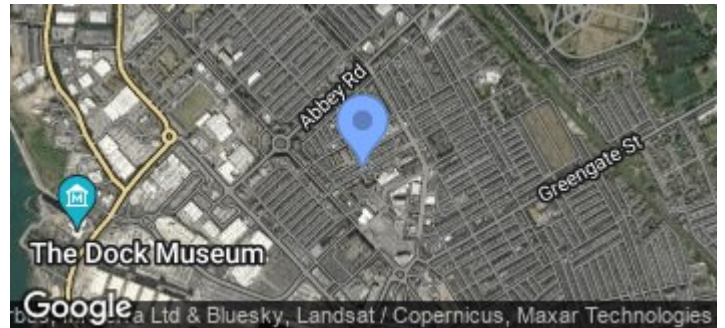

Corrie and Co aim to sell your property at the best possible price in the shortest possible time. We have developed a clear marketing strategy to ensure that your property is fully exposed to the local, regional and national market place and we are confident that we can provide a marketing service second to none. Our Sales Team offer:

- Full colour contemporary sales literature with floorplans
- A full programme of local / regional advertising and promotion on the Corrie and Co and Rightmove websites
- 24/7 promotion in our Barrow, Ulverston and Millom offices
- Professional viewing service and prompt feedback
- Experienced, friendly staff
- Eye catching 'For Sale' board

To ensure your move is looked after, we can help you with an Energy Performance Certificate and arrange a free mortgage and finance review. We also provide a competitive No Sale – No Fee conveyancing service with well known and trusted local solicitors. Our valuation and sales advice is impartial, completely free with no obligation.

Unlike many High Street Estate Agency chains, Corrie and Co are wholly independent and can therefore recommend the mortgage and lender that is most suitable for your needs. Our aim is to provide quality advice and expertise at all times so that you can make an informed decision every step of the way.

Energy Efficiency Rating		Current	Target
100-109	A		
81-100	B		
62-80	C		
43-61	D		
25-42	E		
10-24	F		
1-9	G		
<small>100-109: Most energy efficient - lower running costs 1-9: Most energy inefficient - higher running costs</small>			
<small>England & Wales EU Directive 2002/91/EC</small>			

Environmental Impact (CO ₂) Rating		Current	Target
100-109	A		
81-100	B		
62-80	C		
43-61	D		
25-42	E		
10-24	F		
1-9	G		
<small>100-109: Most environmentally friendly - lower CO₂ emissions 1-9: Most environmentally unfriendly - higher CO₂ emissions</small>			
<small>England & Wales EU Directive 2002/91/EC</small>			