



11 St Mary's Drive

Ulverston, LA12 9FG

Offers In The Region Of £475,000



4



2



1



B



11 St Mary's Drive

Ulverston, LA12 9FG

Offers In The Region Of £475,000



Welcome to your dream home! This modern build 4-bedroom detached residence offers everything your family needs for comfortable living. Spacious and airy, with room for everyone to have their own space. A generously sized garden awaits, perfect for outdoor activities, entertaining and hosting, as well as convenient parking right at your doorstep, ensuring ease and security for your vehicles. Situated in a convenient location, you'll find all the amenities you need just a stone's throw away, from shops to schools to recreational facilities. With its spacious layout, modern conveniences, and proximity to amenities, this home is perfect for families looking for a place to call their own.

Step into the epitome of modern living with this double-fronted detached modern build home, boasting off-road parking and a garage. Let's take a guided tour through its impressive features:

As you approach, notice the convenience of off-road parking and a garage, providing ample space for vehicles and storage. Enter through the front door into a spacious entrance hall, where natural light pours in, creating an inviting ambiance from the moment you step inside. To the left, discover a cosy family lounge adorned with a fireplace, offering warmth and comfort for gatherings or quiet evenings in. Venture further into the heart of the home, where you'll find a modern kitchen/living/diner, the perfect space for cooking, dining, and relaxation. There is also a utility room and ground floor WC, adding convenience to daily routines. Ascend the staircase to the first floor, where four bedrooms await. The master bedroom boasts an en suite, providing a private sanctuary for relaxation and rejuvenation. Additionally, discover a separate four-piece family bathroom, designed for luxury and comfort, offering a tranquil retreat after a long day.

Step outside to the sizeable rear garden, featuring a lush lawn and patio area. This outdoor oasis is perfect for enjoying alfresco dining, entertaining guests, or simply basking in the sunshine.

With its spacious layout, modern amenities, and outdoor living space, this new build home offers the perfect combination of style and functionality. Don't miss the opportunity to make it your own. Schedule a viewing today and envision the possibilities of living in this stunning residence!

Entrance Hall

10'0" x 9'2" (3.071 x 2.805)

Living Room

16'1" x 11'11" (4.917 x 3.657)

Kitchen

10'3" x 10'2" (3.142 x 3.111)

Living/Dining Room

19'10" x 10'9" (6.062 x 3.278)

Utility

7'0" x 6'9" (2.146 x 2.073)

Ground Floor WC

6'9" x 4'7" (2.075 x 1.409)

Bedroom One

13'4" x 10'1" (4.067 x 3.096)

En Suite

9'3" x 3'10" (2.830 x 1.185)

Bedroom Two

10'6" x 9'6" (3.216 x 2.918)

Bedroom Three

12'8" x 8'9" (3.884 x 2.688)

Bedroom Four

9'9" x 8'9" (2.994 x 2.668)

Family Bathroom

9'1" x 7'7" (2.772 x 2.334)

Landing

16'7" x 3'8" (5.080 x 1.133)



- Ideal Family Home
- Close to Amenities
- Useful Utility with WC
- Spacious Rear Garden
- Garage and Off Road Parking
- Modern Decor Throughout
- En Suite to the Master Bedroom
- Council Tax Band - E



Road Map

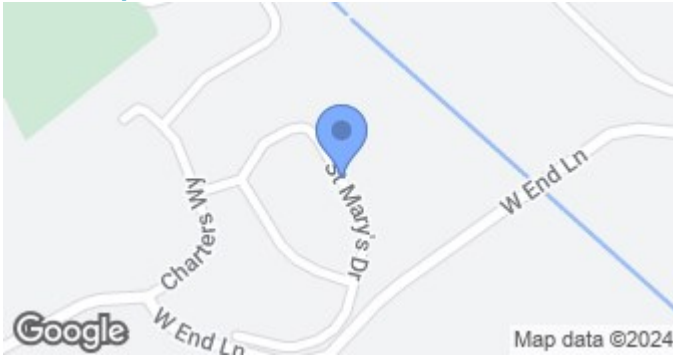

Terrain Map



Floor Plan

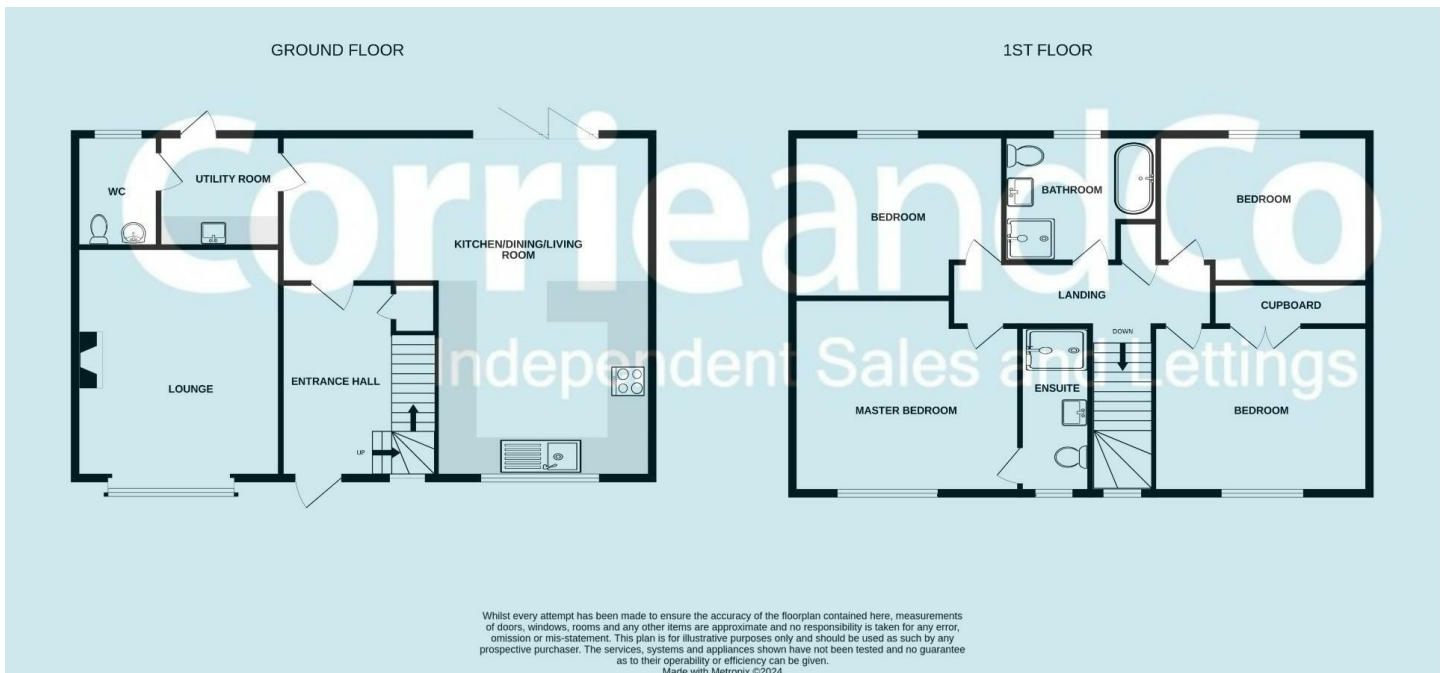

Corrie and Co aim to sell your property, at the best possible price, in the shortest possible time. We have developed a clear marketing strategy, over many years, to ensure your property is exposed to all social media platforms, Rightmove, Zoopla and our own Corrie and Co website.

We also offer:

- Professional Photography
- Full promotion, throughout all our branches
- Experienced, qualified, friendly staff
- Full viewing service with feedback

To ensure your move is stress free, we can help with Mortgage advice. We work alongside local Solicitors, offering competitive conveyancing services.

We are local, family run business who are wholly independent which means we can recommend services to most suit your needs. Our aim is to provide quality advice and expertise at all times, so you can make an informed decision.

