



A CHARMING THREE BEDROOM SEMI-DETACHED FAMILY HOME

Roy Road, Northwood, Middlesex, HA6 1EH

ROBSONS

Roy Road, Northwood, Middlesex, HA6 1EH

**SEMI-DETACHED • THREE BEDROOMS •
SPACIOUS OPEN-PLAN KITCHEN/DINING
ROOM • MODERN AND STYLISH
THROUGHOUT • SOUTH-FACING REAR
GARDEN • DRIVEWAY PARKING • SHORT
WALK TO TOWN AND STATION**

Description

Positioned on one of Northwood's most popular residential roads in the heart of old Northwood moments from the centre of town is this delightful semi-detached three bedroom family home. The property is set back from the road offering off street parking and has a south-facing private rear garden.

Internally, the property has been skilfully modernised and extended to provide spacious and modern living spaces set over two floors and retains the character and period of the build.

Internal viewing is essential to appreciate the quality and position of this lovely Northwood home.





Northwood provides a range of shopping facilities including Waitrose supermarket, a variety of restaurants and other amenities with the Metropolitan Line station providing access to Baker Street and the City. There is a plethora of state and private schooling together with a wide choice of recreational facilities, which include golf courses and fitness centres. The M1, M40 and M25 motorways are also accessible.

NB this property is situated within the proximity of the ULEZ, if your vehicle does not comply charges may apply.

Additional Information

Tenure: Freehold

Local Authority: London Borough of Hillingdon

Council Tax Band: F

Energy Efficiency Rating: D

For additional information, please refer to www.robsonswb.com or call us on: 01923 835355.



Approximate Gross Internal Area
 Ground Floor = 65.0 sq m / 700 sq ft
 First Floor = 47.4 sq m / 510 sq ft
 Total = 112.4 sq m / 1,210 sq ft

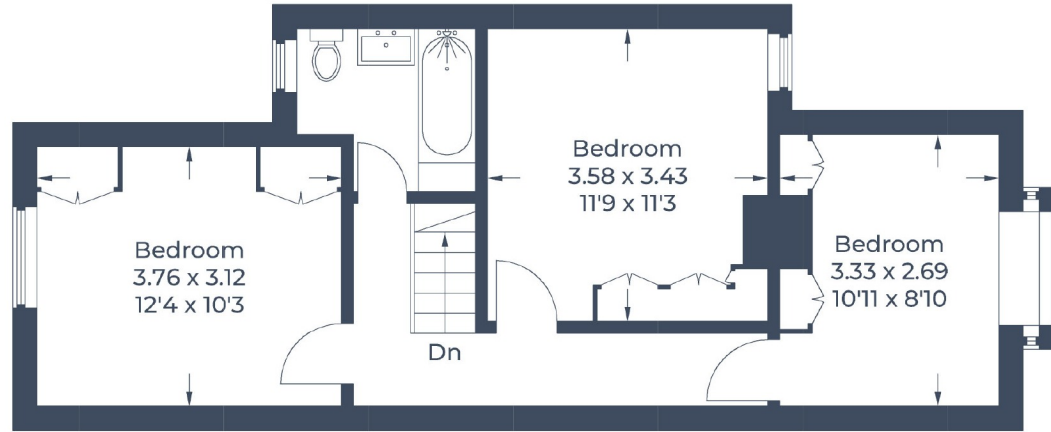

First Floor

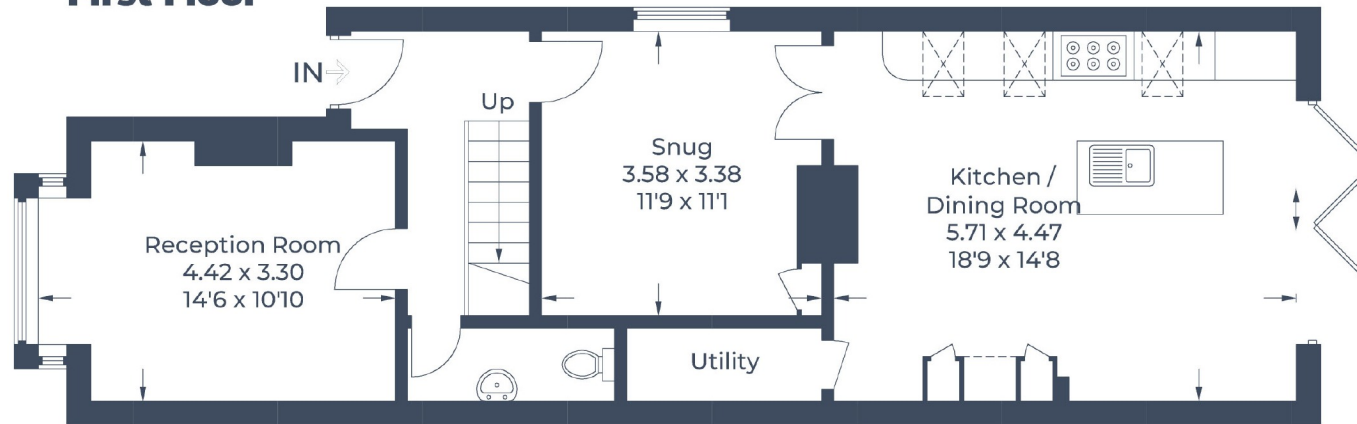

Ground Floor

Illustration for identification purposes only,
 measurements are approximate, not to scale.
 © CJ Property Marketing Produced for Robsons

ROBSONS

7 Clive Parade, Northwood, HA6 2QF
 Tel: 01923 835355 Email: northwood@robsonswb.com
www.robsonswb.com

SCAN TO VISIT



OUR WEBSITE

Important notice: Robsons, their clients and any joint agents give notice that 1: They are not authorised to make or give any representations or warranties in relation to the property either here or elsewhere, either on their own behalf or on behalf of their client or otherwise. They assume no responsibility for any statement that may be made in these particulars. These particulars do not form part of any offer or contract and must not be relied upon as statements or representations of fact. 2: Any areas, measurements or distances are approximate. Plot sizes and dimensions are taken from Promap and are approximate. The text, photographs and plans are for guidance only and are not necessarily comprehensive. It should not be assumed that the property has all necessary planning, building regulation or other consents and Robsons have not tested any services, equipment or facilities. Purchasers must satisfy themselves by inspection or otherwise.