



**A SECOND FLOOR ONE BEDROOM APARTMENT WITHIN THE HEART OF
NORTHWOOD**

Frithwood Avenue, Northwood, Middlesex, HA6 3LX

ROBSONS

Frithwood Avenue, Northwood, Middlesex, HA6 3LX

SECOND FLOOR • ONE BEDROOM • ONE BATHROOM • SPACIOUS LIVING/DINING ROOM • KITCHEN • OFF-STREET PARKING • CLOSE TO NORTHWOOD TOWN AND STATION • LIGHT-FILLED ROOMS

Description

Robsons are pleased to bring to the market this charming one bedroom, one bathroom top floor apartment flooded with natural light.

The property is located on one of Northwood's most sought-after tree lined residential roads within easy reach of Northwood town centre.

The property comprises a kitchen, dining/living area, one double bedroom with cupboard storage and a family bathroom. This apartment has been designed to offer plenty of natural light to really show the spacious space it has to offer.

Other benefits include off street parking, a secure entrance point and friendly neighbours/residents.





Northwood provides a range of shopping facilities including Waitrose supermarket, a variety of restaurants and other amenities with the Metropolitan Line station providing access to Baker Street and the City. There is a plethora of state and private schooling together with a wide choice of recreational facilities, which include golf courses and fitness centres. The M1, M40 and M25 motorways are also accessible.

NB this property is situated within the proximity of the ULEZ, if your vehicle does not comply charges may apply.

Additional Information

Tenure: Leasehold

Lease Length: 125 years from 26th January 2015

Service Charge: circa £550 p/a

Local Authority: London Borough of Hillingdon

Council Tax Band: D

Energy Efficiency Rating: E

For additional information, please refer to www.robsonswb.com or call us on: 01923 835355.

Approximate Gross Internal Area
 Ground Floor = 1.7 sq m / 18 sq ft
 First Floor = 63.6 sq m / 684 sq ft
 Total = 65.3 sq m / 702 sq ft



 = Reduced headroom below 1.5m / 5'0"

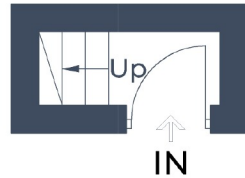

Ground Floor



First Floor

Illustration for identification purposes only,
 measurements are approximate, not to scale.
 © CJ Property Marketing Produced for Robsons

ROBSONS

7 Clive Parade, Northwood, HA6 2QF
 Tel: 01923 835355 Email: northwood@robsonswb.com
www.robsonswb.com

SCAN TO VISIT



OUR WEBSITE

Important notice: Robsons, their clients and any joint agents give notice that 1: They are not authorised to make or give any representations or warranties in relation to the property either here or elsewhere, either on their own behalf or on behalf of their client or otherwise. They assume no responsibility for any statement that may be made in these particulars. These particulars do not form part of any offer or contract and must not be relied upon as statements or representations of fact. 2: Any areas, measurements or distances are approximate. Plot sizes and dimensions are taken from Promap and are approximate. The text, photographs and plans are for guidance only and are not necessarily comprehensive. It should not be assumed that the property has all necessary planning, building regulation or other consents and Robsons have not tested any services, equipment or facilities. Purchasers must satisfy themselves by inspection or otherwise.