



WELL PRESENTED FIRST FLOOR TWO BEDROOM APARTMENT

Elder Court, 23 Green Lane, Northwood, Middlesex, HA6 2XP



Elder Court, 23 Green Lane, Northwood,
Middlesex, HA6 2XP

**FIRST FLOOR • TWO BEDROOMS • TWO
BATHROOMS • GATED DEVELOPMENT •
ALLOCATED PARKING SPACE • BALCONY •
CHAIN FREE • LIFT ACCESS • HEART OF
NORTHWOOD TOWN • COMMUNAL
GARDEN**

Description

Situated in arguably one of Northwood's most convenient purpose-built gated developments in the heart of Northwood is this two bedroom, two bathroom luxury apartment.

The apartment is positioned on the first floor and has the benefit of a private balcony accessed from the living room. The property has the advantage of a lift to all floors and an allocated gated parking space.

Further benefits include a share of the freehold with a long lease and no onward chain.





Northwood provides a range of shopping facilities, including Waitrose supermarket, a variety of restaurants and other amenities, with the Metropolitan Line station providing access to Baker Street and the City. There is a plethora of state and private schooling together with a wide choice of recreational facilities, which include golf courses and fitness centres. The M1, M40 and M25 motorways are also accessible.

NB this property is situated within the proximity of the ULEZ, if your vehicle does not comply, charges may apply.

Additional Information

Tenure: Leasehold

Lease Length: 999 years from 2003

Service Charge: £2,520 p/a

Local Authority: London Borough of Hillingdon

Council Tax Band: F

Energy Efficiency Rating: C

For additional information, please refer to www.robsonswb.com or call us on: 01923 835355.



Approximate Gross Internal Area
87.7 sq m / 944 sq ft

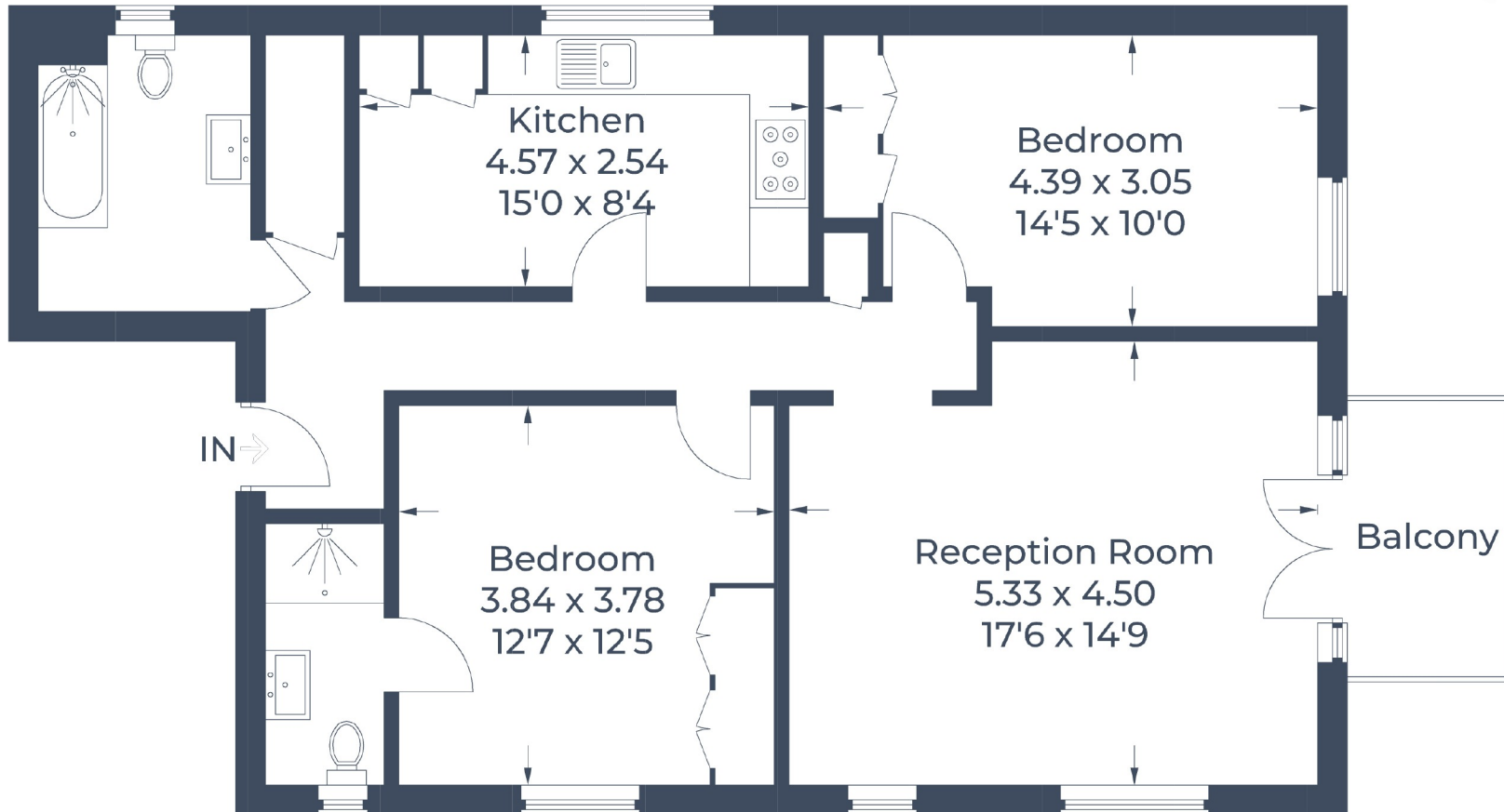

First Floor

Illustration for identification purposes only,
measurements are approximate, not to scale.
© CJ Property Marketing Produced for Robsons

ROBSONS

7 Clive Parade, Northwood, HA6 2QF
Tel: 01923 835355 Email: northwood@robsonsweb.com
www.robsonsweb.com