



END OF TERRACE TWO BEDROOM FAMILY HOME WITHIN A CUL-DE-SAC

Robina Close, Northwood Hills, Middlesex, HA6 1PS

ROBSONS

WELL PRESENTED TWO BEDROOM FAMILY HOME

Robina Close, Northwood Hills, Middlesex, HA6
1PS

**END OF TERRACE • TWO BEDROOMS •
CUL-DE-SAC LOCATION • PRIVATE REAR
GARDEN • DRIVEWAY PARKING • CLOSE TO
STATION • MODERN THROUGHOUT**

Description

Situated in a cul de sac location convenient for access to Northwood Hills shops and metropolitan line train station, this attractive two-bedroom end of terrace house is presented to a modern finish and benefits from a private rear garden and allocated off street parking.

Further benefits include a downstairs guest w/c, an open-plan living/dining room with sliding doors leading to a terrace ideal for outside entertaining.





The property is conveniently located in Northwood Hills and is perfectly positioned for highly regarded local schools including Northwood School (now an academy) and Harlyn and Hillside Primary Schools. Northwood Hills has an array of shopping facilities, restaurants and transport facilities including the Metropolitan Line station with access to Baker Street and The City. The local area is also well served with leisure facilities including golf, tennis and football clubs. The M1, M40 and M25 motorways are also easily accessible.

NB this property is situated within the proximity of the ULEZ, if your vehicle does not comply charges may apply.

Additional Information

Tenure: Freehold

Local Authority: London Borough of Hillingdon

Council Tax: D

Energy Efficiency Rating: C

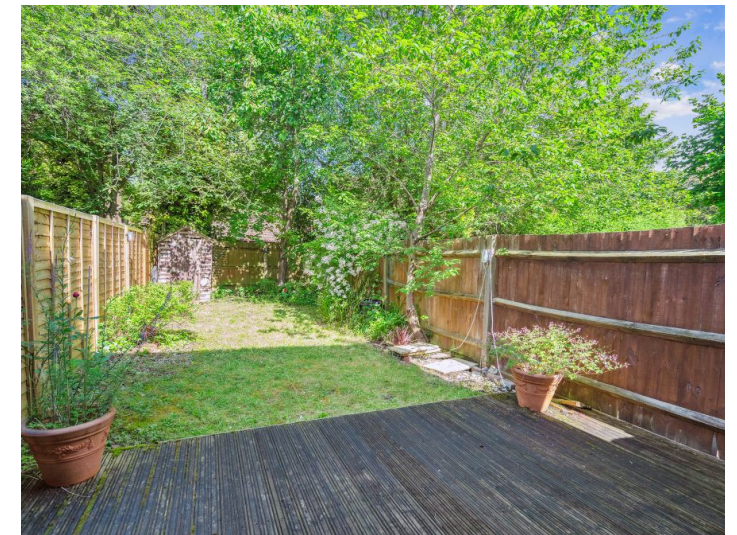

Approximate Gross Internal Area
Ground Floor = 33.7 sq m / 363 sq ft
(Including External Cupboard)
First Floor = 31.2 sq m / 336 sq ft
Total = 64.9 sq m / 699 sq ft



Ground Floor

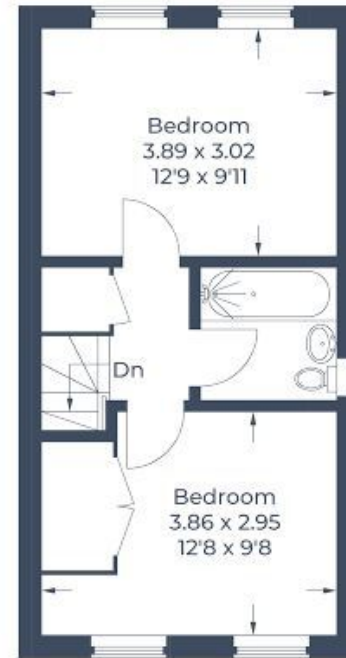

First Floor

Illustration for identification purposes only,
measurements are approximate, not to scale.
© CJ Property Marketing Produced for Robsons

ROBSONS

7 Clive Parade, Northwood, HA6 2QF
Tel: 01923 835355 Email: northwood@robsonsweb.com

www.robsonsweb.com