



DETACHED FOUR BEDROOM FAMILY HOME

Northgate, Northwood, Middlesex, HA6 2JT



DETACHED FOUR BEDROOM FAMILY HOME WITHIN THE COPSE WOOD ESTATE

Northgate, Northwood, Middlesex, HA6 2TJ

DETACHED • FOUR BEDROOMS • TWO BATHROOMS • TWO RECEPTION ROOMS • COPSE WOOD ESTATE • GATED • DRIVEWAY PARKING • PRIVATE REAR GARDEN •

Description

Positioned on a popular residential road within the favoured Copse Wood Estate, this detached four bedroom, two bathroom family home has been skilfully extended to provide modern living space set over two floors.

The property sits on a wide plot with the benefit of gated off street parking. To the rear is a private and secluded garden.

Internally, the property has been finished to a high standard and boasts an impressive living room with oversized doors leading to the garden.





Location

Northwood provides a range of shopping facilities including Waitrose supermarket, a variety of restaurants and other amenities with the Metropolitan Line station providing access to Baker Street and the City. There is a plethora of state and private schooling together with a wide choice of recreational facilities, which include golf courses and fitness centres. The M1, M40 and M25 motorways are also accessible.

NB this property is situated within the proximity of the ULEZ, if your vehicle does not comply charges may apply.

Additional Information

Tenure: Freehold

Local Authority: London Borough of Hillingdon

Council Tax: Band G

Energy Efficiency Rating: Band E



Mewburn, Northgate, Northwood
 Approximate Gross Internal Area
 Main House = 183 Sq M/1970 Sq Ft
 Outbuildings = 15 Sq M/162 Sq Ft
 Total = 198 Sq M/2132 Sq Ft

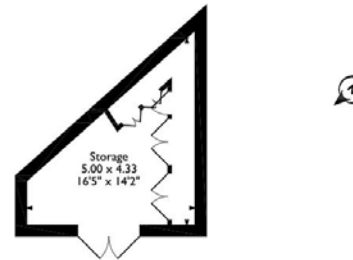

Please note that the location of doors, windows and other items are approximate and this floorplan is to be used for illustrative purposes only. Unauthorized reproduction is prohibited.



Address 7 Clive Parade, Northwood, Middlesex, HA6 2QF

Tel: 01923 835355 northwood@robsonswb.com

www.robsonswb.com