



## A FOUR BEDROOM SEMI-DETACHED HOME

---

Eastbury Road, Northwood, Middlesex, HA6 3AL

**ROBSONS**

# A FOUR BEDROOM SEMI-DETACHED HOME

Eastbury Avenue, Northwood, Middlesex, HA6 3AL

**DRIVEWAY • FOUR BEDROOMS • OFFICE  
• UTILITY ROOM • TWO LOUNGE ROOMS  
• DINING ROOM • KITCHEN • TWO  
BATHROOMS • GROUND FLOOR W/C • REAR  
GARDEN • GREEN HOUSE**

## Description

A unique and characterful property which presents a wonderful opportunity for the right buyer to acquire this charming property set moments from the heart of Northwood town centre.

The property provides over 2500 sqft of versatile accommodation set over three floors, externally there is a large and mature private garden and off street parking with access to the garage.

Potential to extend subject to planning permission.





### **Location**

Northwood provides a range of shopping facilities including Waitrose supermarket, a variety of restaurants and other amenities with the Metropolitan Line station providing access to Baker Street and the City. There is a plethora of state and private schooling together with a wide choice of recreational facilities, which include golf courses and fitness centres. The M1, M40 and M25 motorways are also accessible.

### **Additional Information**

Tenure: Freehold

Local Authority: London Borough of Hillingdon

Council Tax: Band G

Energy Efficiency Rating: Band D



Eastbury Road, Northwood  
 Approximate Gross Internal Area  
 Main House = 225 Sq M/2422 Sq Ft  
 Outbuilding = 8 Sq M/86 Sq Ft  
 Total = 233 Sq M/2508 Sq Ft

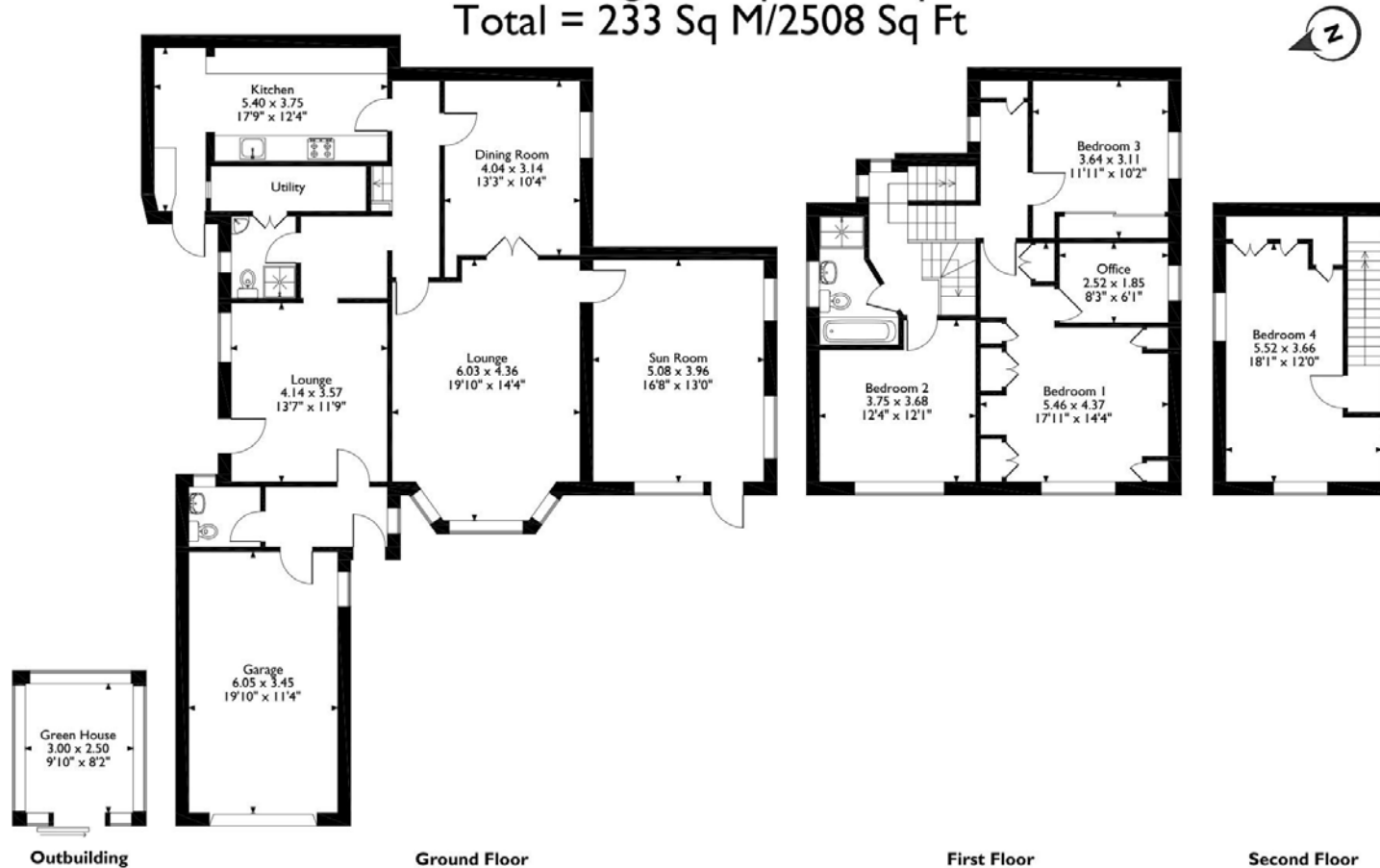

Please note that the location of doors, windows and other items are approximate and this floorplan is to be used for illustrative purposes only. Unauthorized reproduction is prohibited.



Address 7 Clive Parade, Northwood, Middlesex, HA6 2QF

Tel: 01923 835355 northwood@robsonswb.com

[www.robsonswb.com](http://www.robsonswb.com)

www.  
 the  
 londonoffice.co.uk  
 40 ST JAMES'S PLACE SW1