



LDG

CONWAY STREET
Fitzrovia



Conway Street





Conway Street



ADDRESS	POSTCODE	LOCAL AUTHORITY	RENT
Conway Street, Fitzrovia	W1T 6BW	Camden	£519 Per Week

THE SPACE

A beautiful duplex apartment with period features, wooden flooring, and a private patio on the edge of Fitzroy Square. It includes an open-plan kitchen, a spacious double bedroom with built-in wardrobes, a modern shower room, and ample storage.

Situated just off Fitzroy Square, the apartment is ideally located near Great Portland Street and Warren Street transport links. The bars, cafes, and restaurants of Fitzrovia and Marylebone, as well as Regent's Park, are a short walk away.

Specifics

ACCOMMODATION & FEATURES

- Available Now
- Duplex Apartment
- Private Patio
- Wooden Flooring
- Period Features
- Plantation Shutters
- Open-Plan Kitchen
- Managed by LDG

COMMUTE

- Great Portland Street (643m)
- Warren Street (321m)

ON YOUR DOORSTEP

- Riding House Café
- Caravan
- Honey & Co
- Pure Gym
- Regents Park

Conway Street

Conway Street, W1T 6BW

Approx. 590 sq. feet (54.81 sq. metres)

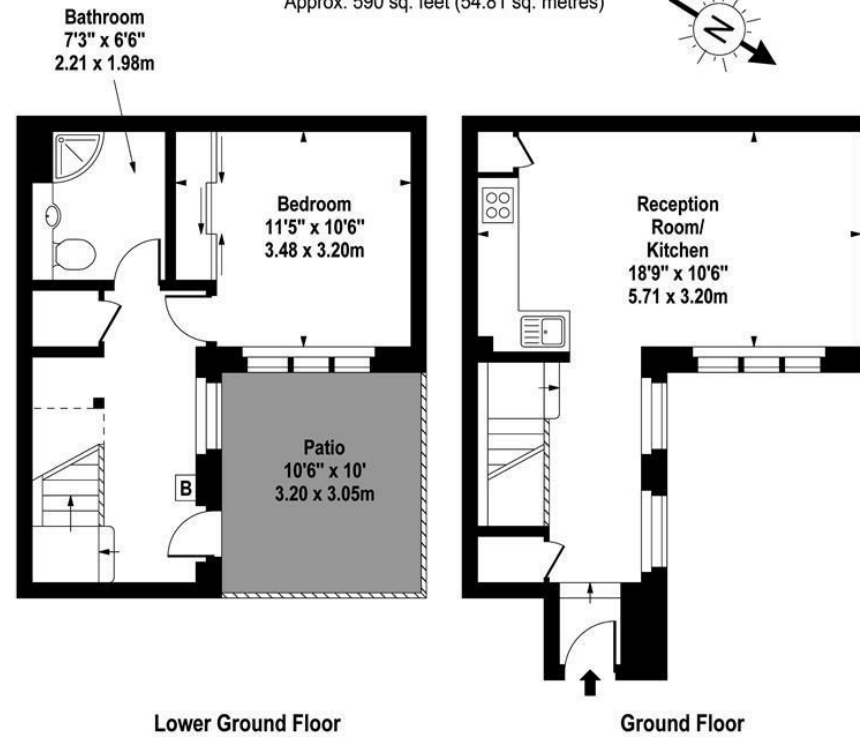
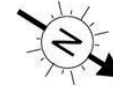

For Illustration Purposes Only - Not To Scale
www.goldens.co.uk
 Ref. No. 008389J

ldg.co.uk

Ready to talk?



**MAX
CHAUDRY**

DD: 020 7291 0998
M: 0775 687 3938
E: max@ldg.co.uk



**VAS
VASILOKONSTANTAKIS**

DD: 020 7292 0990
M: 07809 410 252
E: vas@ldg.co.uk



**THEMIS
POLLALIS**

DD: 020 4513 6751
M: 07809 410 182
E: themis@ldg.co.uk



**EMLYN
YOUNG**

DD: 020 7290 0593
M: 07881 971 315
E: emlyn@ldg.co.uk



**MINETTE
RIBEIRO SA**

DD: 0207291 0997
M: 07796 427 363
E: minette@ldg.co.uk



**GEORGIE
MACKAY-STEWART**

DD: 020 4542 4873
M: 07551 780 308
E: georgie@ldg.co.uk



**MEGAN
BATTLE**

DD: 020 7290 0598
M: 07391 852 165
E: megan@ldg.co.uk



**SHANNON
TUPPER**

DD: 020 4513 6750
M: 07920 015 392
E: shannon@ldg.co.uk

LDG | www.ldg.co.uk
53 Great Titchfield Street
London, W1W 7PJ

Conway Street

