



LDG

14 HANSON STREET  
Fitzrovia





14 Hanson Street











ADDRESS	POSTCODE	LOCAL AUTHORITY	RENT
14 Hanson Street, Fitzrovia	W1W 6UB	Westminster City Council	£519 Per Week

### THE SPACE

Located on the popular Hanson Street in the heart of Fitzrovia, this apartment is beautifully presented and finished to an excellent standard throughout. Featuring a bright reception room with beautiful feature wallpaper and a separate modern kitchen with views over Saint Charles Borromeo Church.

Located on the Hanson Street which is a quiet street in the heart of Fitzrovia, this lovely apartment also benefits from quiet surroundings and is strolling distance from Regents Park. Goodge Street and Oxford Circus underground stations are also close by. Also within a walking distance to Marylebone, Soho, Covent Garden, Bloomsbury and Mayfair areas.

Specifics

### ACCOMMODATION

#### & FEATURES

- Available 13th of September
- Beautifully Decorated
- Modern Separate Kitchen
- Quiet Street
- Wooden Flooring
- BT Tower Views
- Modern Bathroom
- Managed by LDG

### COMMUTE

Goodge Street - 640m  
Great Portland Street - 640m  
Oxford Circus - 800m

### ON YOUR DOORSTEP

Riding House Café  
Foleys  
Alex Coffee  
Kings Arms  
Pure Gym  
The Regents Park

14 Hanson Street

### Cloutsham House, Hanson Street, W1W 6UB

Approx. 368 sq. feet (34.19 sq. metres)

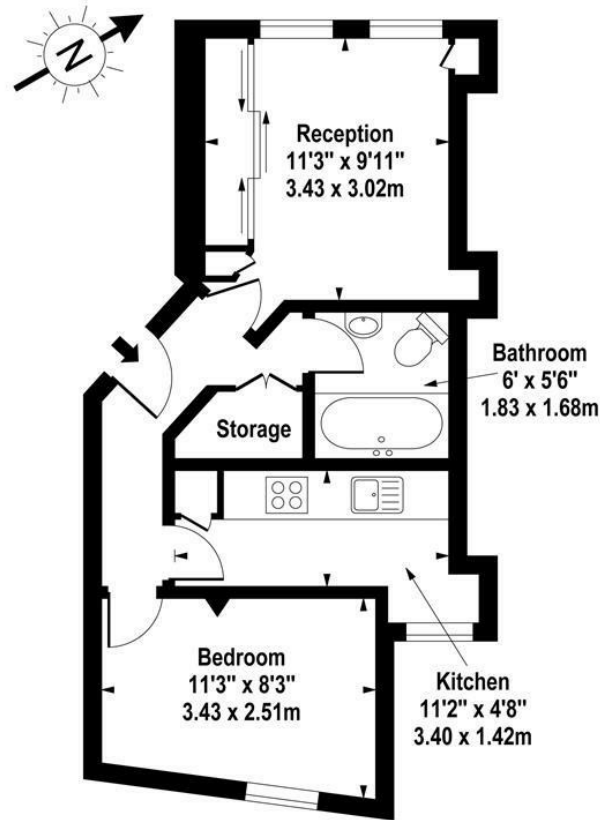

#### Third Floor

For Illustration Purposes Only - Not To Scale  
[www.goldlens.co.uk](http://www.goldlens.co.uk)  
Ref. No. 007822N

ldg.co.uk



Ready to talk?



**MAX  
CHAUDRY**

DD: 020 7291 0998  
M: 0775 687 3938  
E: max@ldg.co.uk



**VAS  
VASILOKONSTANTAKIS**

DD: 020 7292 0990  
M: 07809 410 252  
E: vas@ldg.co.uk



**THEMIS  
POLLALIS**

DD: 020 4513 6751  
M: 07809 410 182  
E: themis@ldg.co.uk



**EMLYN  
YOUNG**

DD: 020 7290 0593  
M: 07881 971 315  
E: emlyn@ldg.co.uk



**MINETTE  
RIBEIRO SA**

DD: 0207291 0997  
M: 07796 427 363  
E: minette@ldg.co.uk



**GEORGIE  
MACKAY-STEWART**

DD: 020 4542 4873  
M: 07551 780 308  
E: georgie@ldg.co.uk



**MEGAN  
BATTLE**

DD: 020 7290 0598  
M: 07391 852 165  
E: megan@ldg.co.uk



**SHANNON  
TUPPER**

DD: 020 4513 6750  
M: 07920 015 392  
E: shannon@ldg.co.uk

LDG | [www.ldg.co.uk](http://www.ldg.co.uk)  
53 Great Titchfield Street  
London, W1W 7PJ

14 Hanson Street

