



LDG

17 NEW NORTH STREET
Bloomsbury



17 New North Street







ADDRESS	POSTCODE	LOCAL AUTHORITY	RENT
New North St, Bloomsbury	WC1N 3PJ	Camden	£575 Per Week

THE SPACE

The apartment comprises of spacious living room with a decorative fireplace, a good size separate fitted kitchen, double bedroom with build-in wardrobes and a good size bathroom whilst also offering abundant natural light and neutral décor throughout.

Situated just minutes from Russell Square and Holborn Underground Station, the apartment is only a short stroll from all the local amenities of Clerkenwell and Bloomsbury.

Specifics

ACCOMMODATION

& FEATURES

- Available 29th August 2024
- Bright and Expansive
- Large Reception Room
- Separate Kitchen
- Double Bedroom
- 3rd Floor (no lift)
- Close to Holborn Tube
- Managed by LDG

COMMUTE

Holborn - 480m
Chancery Lane - 800m

ON YOUR DOORSTEP

Eat Tokyo
Noble Rot Wine Bar and Restaurant
Konditor & Cook
Catalyst
GymBox Holborn

17 New North Street

Bedford House, New North Street, WC1N 3PJ

Approx. 480 sq. feet (44.59 sq. metres)
(Including Restricted Height Area)

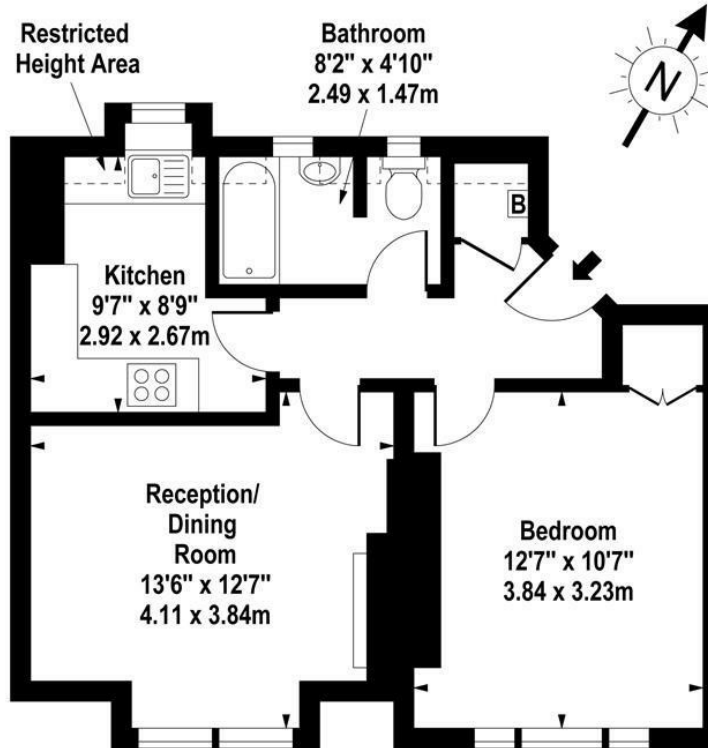

Third Floor

For Illustration Purposes Only - Not To Scale
www.goldlens.co.uk
Ref. No. 001263

ldg.co.uk

Ready to talk?



**MAX
CHAUDRY**

DD: 020 7291 0998
M: 07756 873938
E: max@ldg.co.uk



**VAS
VASILOKONSTANTAKIS**

DD: 020 7292 0990
M: 07809 410 252
E: vas@ldg.co.uk



**THEMIS
POLLALIS**

DD: 020 4513 6751
M: 07809 410 182
E: themis@ldg.co.uk



**EMLYN
YOUNG**

DD: 020 7290 0593
M: 07881 971 315
E: emlyn@ldg.co.uk