



LDG

WELLS STREET
Fitzrovia



Wells Street







ADDRESS	POSTCODE	LOCAL AUTHORITY	RENT
Wells Street, Fitzrovia	W1T 3PJ	Westminster City Council	£692 Per Week

THE SPACE

A lovely two double bedroom apartment set on the first floor of this popular period mansion block located in Fitzrovia, just moments from Oxford street. Offering a bright reception room, a separate modern kitchen and a modern bathroom suite.

Wells Street is within enviable distance of some of the capital's most sought-after amenities, with Oxford Street, Mayfair and Marylebone all close by.

Transport links include Goodge Street Underground Station (Northern Line), Oxford Circus (Central, Bakerloo and Victoria lines) and wealth of regular bus services.

ACCOMMODATION & FEATURES	COMMUTE	ON YOUR DOORSTEP
<ul style="list-style-type: none"> • Available 26th August • Two Double Bedrooms • Separate Kitchen • Wooden Flooring • Furnished • Modern Bathroom • Central Fitzrovia • Managed By LDG 	<p>Oxford Circus - 500m</p> <p>Goodge Street - 600m</p>	<p>Berners Tavern</p> <p>Riding House Cafe</p> <p>Kaffeine</p> <p>Kings Arms</p> <p>PureGym</p> <p>The Regents Park</p>

St. Andrews Chambers, Wells Street, W1T 3PJ

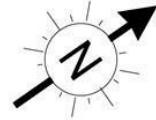

Approx. 540 sq. feet (50.17 sq. metres)

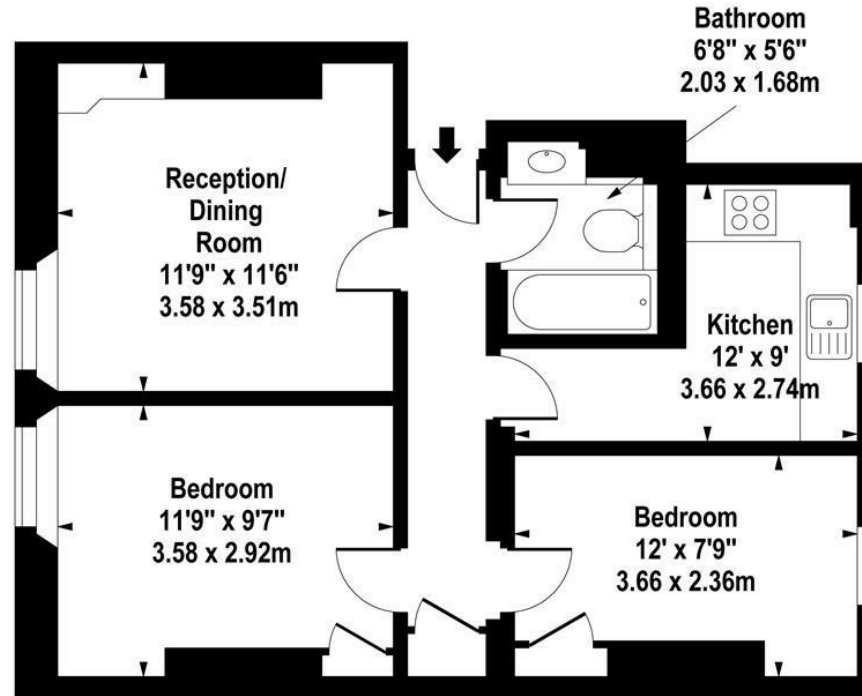

First Floor

For Illustration Purposes Only - Not To Scale
www.goldlens.co.uk
Ref. No. 001771

ldg.co.uk

Ready to talk?



**MAX
CHAUDRY**

DD: 020 7291 0998
M: 07756 873938
E: max@ldg.co.uk



**VAS
VASILOKONSTANTAKIS**

DD: 020 7292 0990
M: 07809 410 252
E: vas@ldg.co.uk



**THEMIS
POLLALIS**

DD: 020 4513 6751
M: 07809 410 182
E: themis@ldg.co.uk



**EMLYN
YOUNG**

DD: 020 7290 0593
M: 07881 971 315
E: emlyn@ldg.co.uk