



LDG

ST. PAULS ROAD
Highbury



St. Pauls Road





**ADDRESS**

St. Pauls Road, London

POSTCODE

N1 2LH

THE SPACE

The apartment has been recently re-decorated in a fantastic location on St. Pauls Road and is just a short walk to Highbury and Islington Station.

The apartment was re-decorated throughout and has a reception room with large windows and an open-plan kitchen, a modern bathroom suite with a bath and overhead shower and a double bedroom. The apartment has wooden flooring throughout and is offered furnished.

The apartment is just a short walk to a fantastic selection of local cafes, bars and restaurants as well as Highbury Fields.

RENT

£404 Per Week

LOCAL AUTHORITY

Islington

ACCOMMODATION**& FEATURES**

- Available 24th of June '24
- Recently Re-decorated
- Open-Plan Kitchen
- Private Terrace
- Wooden Flooring
- Furnished
- Bath and Shower
- Close to Highbury and Islington Station

COMMUTE

Highbury and Islington Station
(160m)

ON YOUR DOORSTEP

The Smoke House
Maison Bleue
The Famous Cock
The Brew House and Kitchen
Highbury Fields
Highbury Leisure Centre

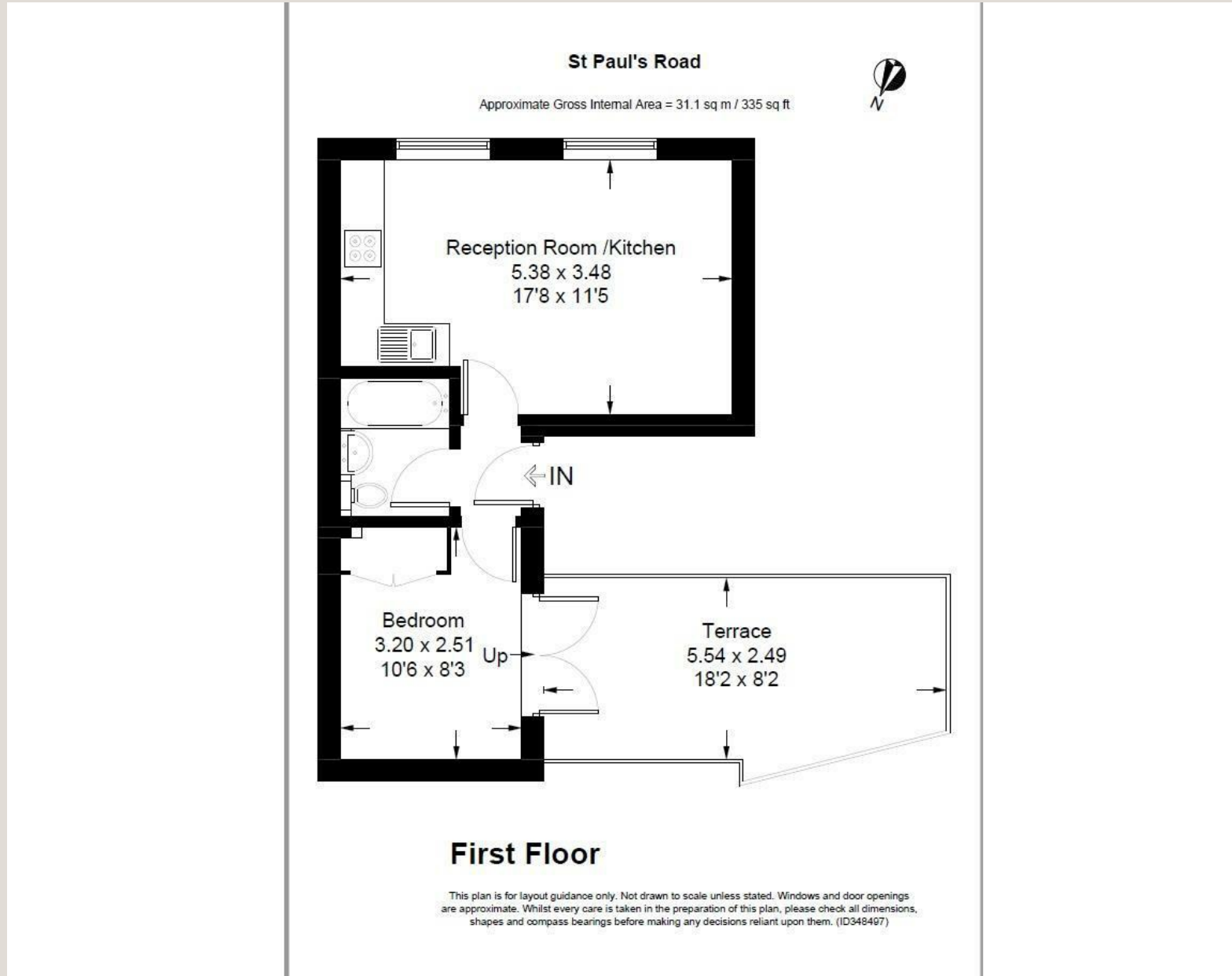

Ready to talk?



**MAX
CHAUDRY**

DD: 020 7291 0998
M: 0775 687 3938
E: max@ldg.co.uk



**VAS
VASILOKONSTANTAKIS**

DD: 020 7292 0990
M: 07809 410 252
E: vas@ldg.co.uk



**THEMIS
POLLALIS**

DD: 020 4513 6751
M: 07809 410 182
E: themis@ldg.co.uk



**EMLYN
YOUNG**

DD: 020 7290 0593
M: 07881 971 315
E: emlyn@ldg.co.uk



**MINETTE
RIBEIRO SA**

DD: 0207291 0997
M: 07342 679 424
E: minette@ldg.co.uk



**GEORGIE
MACKAY-STEWART**

DD: 020 4542 4873
M: 07551 780 308
E: georgie@ldg.co.uk



**MEGAN
BATTLE**

DD: 020 7290 0598
M: 07391 852 165
E: megan@ldg.co.uk



**SHANNON
TUPPER**

DD: 020 4513 6750
M: 07920 015 392
E: shannon@ldg.co.uk

LDG | www.ldg.co.uk
53 Great Titchfield Street
London, W1W 7PJ

St. Pauls Road

