



LDG

47 WELLS STREET  
Fitzrovia



ldg.co.uk







ADDRESS	POSTCODE	LOCAL AUTHORITY	RENT
47 Wells Street, London	W1T 3PN	Westminster City Council	£900 Per Week

### THE SPACE

A large and modern two bedroom apartment situated on the 2nd floor (with lift) of this prestigious and sought after luxury block in the heart of Fitzrovia.

This newly refurbished apartment is presented in excellent condition and benefits from two double bedrooms, two bathrooms (master en-suite), separate fully fitted kitchen, large reception room and 24 hour concierge.

West One house is a purpose built block with a small communal garden and underground parking located on the corner of Wells Street and Riding House Street, ideally located for Fitzrovia's excellent restaurants, shopping and transport amenities. The nearest Underground Stations are Oxford Circus, Great Portland Street and Goodge St.

Specifics

ACCOMMODATION & FEATURES	COMMUTE	ON YOUR DOORSTEP
<ul style="list-style-type: none"> <li>• Available 23rd July '24</li> <li>• Spacious Reception Room</li> <li>• Separate Kitchen</li> <li>• Two Double Bedrooms</li> <li>• Two Bathrooms</li> <li>• Wooden Flooring</li> <li>• Lift Access</li> <li>• Porter</li> </ul>	<p>Oxford Circus (480m) Goodge Street (640m)</p>	<p>Riding House Café Kings Arms The Arber Garden Kaffeine Pure Gym The Regents Park</p>

**West One House,  
Riding House Street, W1T 3PN**  
Approx. 815 sq. feet (75.71 sq. metres)

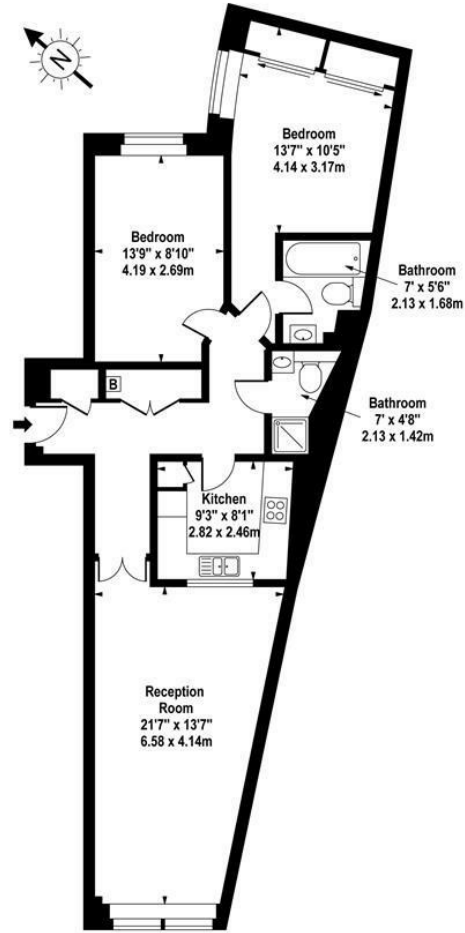

**Second Floor**

For Illustration Purposes Only - Not To Scale  
www.goldlens.co.uk  
Ref. No. 00786

ldg.co.uk

Ready to talk?



**MAX  
CHAUDRY**

DD: 020 7291 0998  
M: 0775 687 3938  
E: max@ldg.co.uk



**VAS  
VASILOKONSTANTAKIS**

DD: 020 7292 0990  
M: 07809 410 252  
E: vas@ldg.co.uk



**THEMIS  
POLLALIS**

DD: 020 4513 6751  
M: 07809 410 182  
E: themis@ldg.co.uk



**EMLYN  
YOUNG**

DD: 020 7290 0593  
M: 07881 971 315  
E: emlyn@ldg.co.uk



**MINETTE  
RIBEIRO SA**

DD: 0207291 0997  
M: 07342 679 424  
E: minette@ldg.co.uk



**GEORGIE  
MACKAY-STEWART**

DD: 020 4542 4873  
M: 07551 780 308  
E: georgie@ldg.co.uk



**MEGAN  
BATTLE**

DD: 020 7290 0598  
M: 07391 852 165  
E: megan@ldg.co.uk



**SHANNON  
TUPPER**

DD: 020 4513 6750  
M: 07920 015 392  
E: shannon@ldg.co.uk

LDG | [www.ldg.co.uk](http://www.ldg.co.uk)  
53 Great Titchfield Street  
London, W1W 7PJ

47 Wells Street

