



LDG

UNIVERSITY STREET
Bloomsbury



University Street







ADDRESS	POSTCODE	LOCAL AUTHORITY	RENT
University Street, London	WC1E 6JP	Camden	£575 Per Week

THE SPACE

The property comprises a spacious reception room with large windows and wood laminate flooring, a separate modern kitchen, a large bedroom and a modern bathroom with a bath and overhead shower.

Paramount Court is a secure development with concierge service and is conveniently located for Warren Street, Euston Square and Goodge Street underground stations and all the shops and bars of Fitzrovia and Tottenham Court Rd.

Specifics

ACCOMMODATION

& FEATURES

- Available 11th July '24
- Large Apartment
- Bright and Spacious
- Laminate Flooring
- Separate Kitchen
- Concierge
- Furnished
- Managed by LDG

COMMUTE

Warren Street (320m)
Goodge Street (160m)

ON YOUR DOORSTEP

Thai Metro
Riding House Cafe
Grafton Arms
Planet Organic
Pure Gym
The Regents Park

Paramount Court,
University Street,
Bloomsbury, WC1E 6JP
Approx. 572 sq. feet (53.14 sq. metres)



Floor Plan

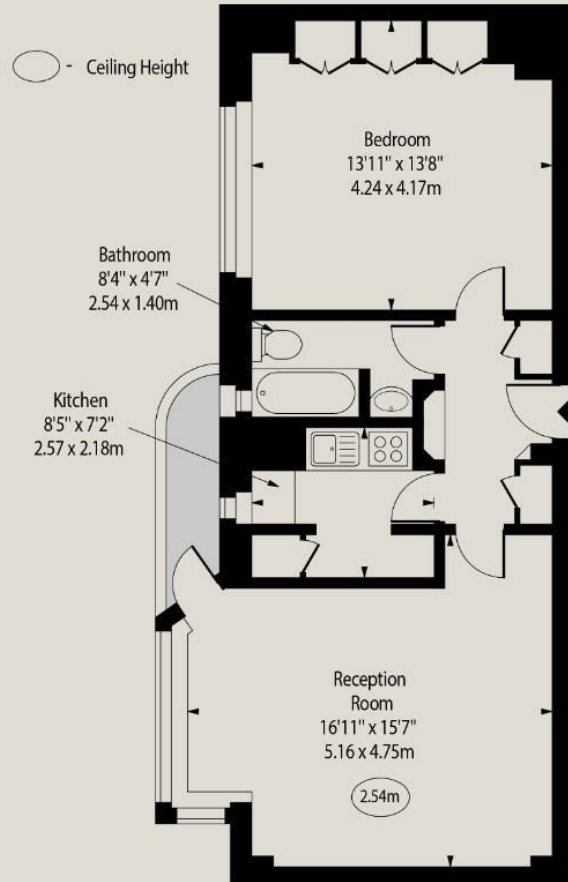

Fourth Floor

For Illustration Purposes Only - Not To Scale
www.goldlens.co.uk
Ref. No. 017666K

Ready to talk?



**MAX
CHAUDRY**

DD: 020 7291 0998
M: 07756 873938
E: max@ldg.co.uk



**VAS
VASILOKONSTANTAKIS**

DD: 020 7292 0990
M: 07809 410 252
E: vas@ldg.co.uk



**THEMIS
POLLALIS**

DD: 020 4513 6751
M: 07809 410 182
E: themis@ldg.co.uk