



LDG

53 RIDING HOUSE STREET
Fitzrovia



ldg.co.uk

53 Riding House Street





53 Riding House Street



ADDRESS	POSTCODE	LOCAL AUTHORITY	RENT
53 Riding House Street, London	W1W 7ED	Westminster City Council	£576 Per Week

THE SPACE

A beautifully presented and bright one bedroom apartment situated on the top (4th) floor of a purpose built period red brick block with South-facing roof top views located in the heart of trendy Fitzrovia.

The apartment comprises a spacious reception room with feature fireplace and window seats, a fully fitted separate kitchen, large double bedroom with double fitted storage, and a modern three piece bathroom suite.

The other benefits include the wooden floors throughout, gas central heating and a great natural light.

Located on the Riding House Street, this lovely apartment also benefits from quiet surroundings and being only moments from the café society of Great Titchfield Street and Charlotte Street, along with strolling distance from Regents Park. Goodge Street and Oxford Circus underground stations are also close by so is the Marylebone, Soho, Covent Garden, Bloomsbury and Mayfair areas.

Specifics

ACCOMMODATION & FEATURES	COMMUTE	ON YOUR DOORSTEP
<ul style="list-style-type: none"> • Available 5th of July '24 • Furnished • Spacious Reception Room • Separate Kitchen • Modern Bathroom • Period Features • Wooden Flooring • Top Floor 	<p>Goodge Street - 500m</p> <p>Oxford Circus - 550m</p> <p>Great Portland Street - 800m</p>	<p>Kings Arms</p> <p>Riding House Café</p> <p>Kaffeine</p> <p>Crown and Scepter</p> <p>Pure Gym</p> <p>The Regents Park</p>

53 Riding House Street

Lyon House, Riding House Street, W1W 7ED

Approx. 435 sq. feet (40.41 sq. metres)
(Including Restricted Height Area)

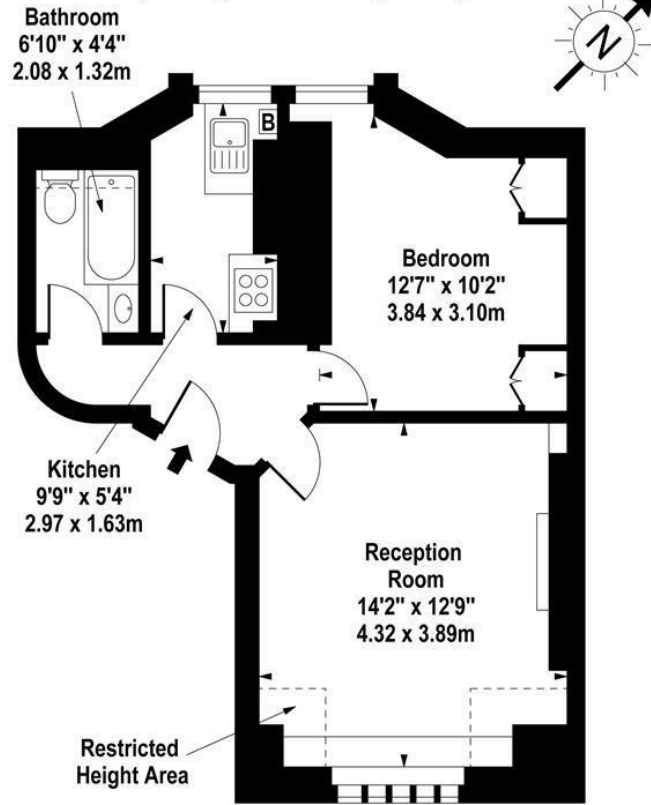

Fourth Floor

For Illustration Purposes Only - Not To Scale
www.goldlens.co.uk
Ref. No. 00496

ldg.co.uk

Ready to talk?



**MAX
CHAUDRY**

DD: 020 7291 0998
M: 07756 873938
E: max@ldg.co.uk



**VAS
VASILOKONSTANTAKIS**

DD: 020 7292 0990
M: 07809 410 252
E: vas@ldg.co.uk



**THEMIS
POLLALIS**

DD: 020 4513 6751
M: 07809 410 182
E: themis@ldg.co.uk