



LDG

30 TAVISTOCK STREET
Covent Garden



30 Tavistock Street







ADDRESS	POSTCODE	LOCAL AUTHORITY	RENT
30 Tavistock Street, London	WC2E 7PB	Westminster City Council	£519 Per Week

THE SPACE

Set on the top floor of this historic building seconds away to the attractions of Covent Garden market, this newly refurbished and well-proportioned one bedroomed flat boasts bright modern interiors throughout. The property comprises reception room with dining space and well equipped open-plan kitchen, double bedroom and shower room. If you are a Charles Dickens fan what better opportunity than to walk in his footsteps.

This is your chance to live in a piece of history in the former office and lodging of this famous author.

Specifics

ACCOMMODATION

& FEATURES

- Available 5th July '24
- Top Floor
- Covent Garden
- Period Features
- Open-Plan Kitchen
- Walk-in Shower
- Charles Dickens' Former office
- Managed by LDG

COMMUTE

Covent Garden - 500m

Leicester Square - 650m

ON YOUR DOORSTEP

Neal's Yard
 J Sheekey
 Hawksmoor Seven Dials
 Seven Dials Café
 Monmouth Coffee
 Soho Gyms Holborn

30 Tavistock Street

Tavistock Street, WC2

Approx. Gross Internal Area 358 Sq Ft - 33.26 Sq M

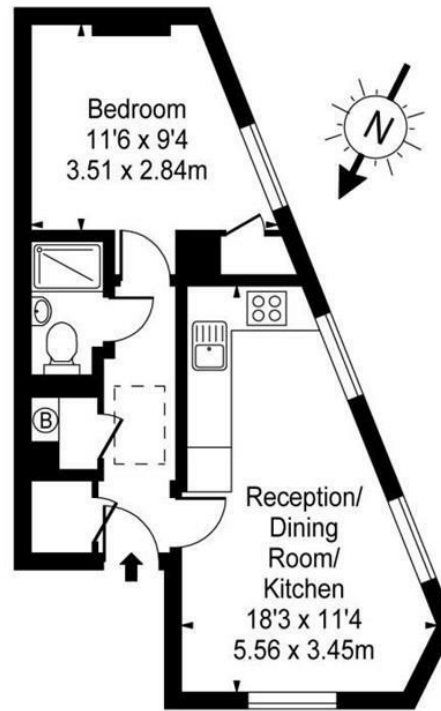

Fourth Floor

For Illustration Purposes Only - Not To Scale Floor Plan by www.pixandplans.com Ref: No.15178

This floor plan should be used as a general outline for guidance only and do not constitute in whole or in part an offer or contract. Any intending purchaser or lessee should satisfy themselves by inspection, searches, enquiries and full survey as to the correctness of each statement. Any areas, measurements or distances quoted are approximate and should not be used to value a property or be the basis of any sale or let.



Ready to talk?



**MAX
CHAUDRY**

DD: 020 7291 0998
M: 07756 873938
E: max@ldg.co.uk



**VAS
VASILOKONSTANTAKIS**

DD: 020 7292 0990
M: 07809 410 252
E: vas@ldg.co.uk



**THEMIS
POLLALIS**

DD: 020 4513 6751
M: 07809 410 182
E: themis@ldg.co.uk

LDG | www.ldg.co.uk
53 Great Titchfield Street
London, W1W 7JP

30 Tavistock Street

