



LDG

20 HANSON STREET
Fitzrovia



20 Hanson Street







ADDRESS	POSTCODE	LOCAL AUTHORITY	RENT
20 Hanson Street, London	W1W 6UF	Westminster City Council	£461 Per Week

THE SPACE

A beautiful studio apartment with a separate kitchen located on the popular Hanson Street in the heart of Fitzrovia, W1. Comprising a good size reception room with wooden flooring and lots of natural light, a separate modern kitchen and a bathroom with bath and shower.

Hanson Street is ideally located close to Great Portland Street and Oxford Street and is a very charming street within a quiet neighbourhood in the Heart of Fitzrovia. It is within close proximity to a range of fashionable shops and amenities in the local area such as Charlotte Street and Goodge Street.

Specifics

ACCOMMODATION

& FEATURES

- Available 7th of June '24
- Studio Apartment
- Separate Kitchen
- Bath and Shower
- Wooden Floor
- Lots Of Natural Light
- Quiet Street
- Close to Regents Park

COMMUTE

Oxford Circus (Central, Bakerloo and Victoria Lines) - 644m
Great Portland Street (Circle, Hammersmith & City and Metropolitan lines) - 644m
Goodge Street (Northern line) - 644m

ON YOUR DOORSTEP

Riding House Café
Foleys
Alex Coffee
Crown and Sceptre
Pure Gym
Regents Park

20 Hanson Street

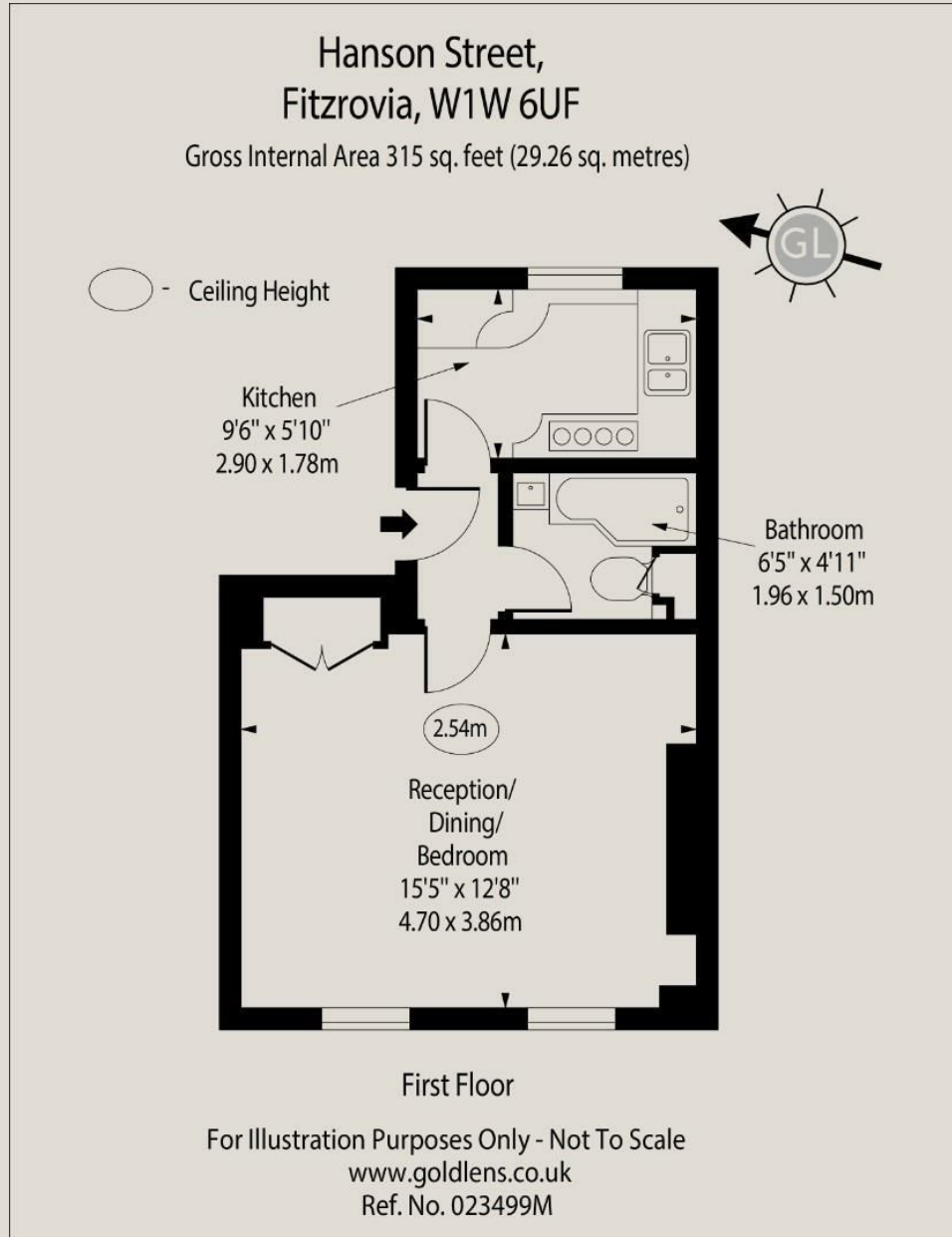



Ready to talk?



**MAX
CHAUDRY**

DD: 020 7291 0998
M: 07756 873938
E: max@ldg.co.uk



**VAS
VASILOKONSTANTAKIS**

DD: 020 7292 0990
M: 07809 410 252
E: vas@ldg.co.uk



**THEMIS
POLLALIS**

DD: 020 4513 6751
M: 07809 410 182
E: themis@ldg.co.uk

LDG | www.ldg.co.uk
53 Great Titchfield Street
London, W1W 7JP

20 Hanson Street

