



HANSON STREET, FITZROVIA, W1

STUDIO APARTMENT

£475 PER WEEK

FEES APPLY





THE SPACE

A good size studio apartment with a separate kitchen located on the popular Hanson Street in the heart of Fitzrovia, W1. Comprising a good size reception room with wooden flooring and lots of natural light, a separate modern kitchen and a bathroom with bath and shower.

Hanson Street is ideally located close to Great Portland Street and Oxford Street and is a very charming street within a quiet neighbourhood in the Heart of Fitzrovia. It is within close proximity to a range of fashionable shops and amenities in the local area such as Charlotte Street and Goodge Street.

ACCOMODATION AND FEATURES

- Available 7th of June
- Studio Apartment
- Separate Kitchen
- Bath and Shower
- Wooden Floor
- Lots Of Natural Light
- Quiet Street
- Period Bulding

FLOORPLAN

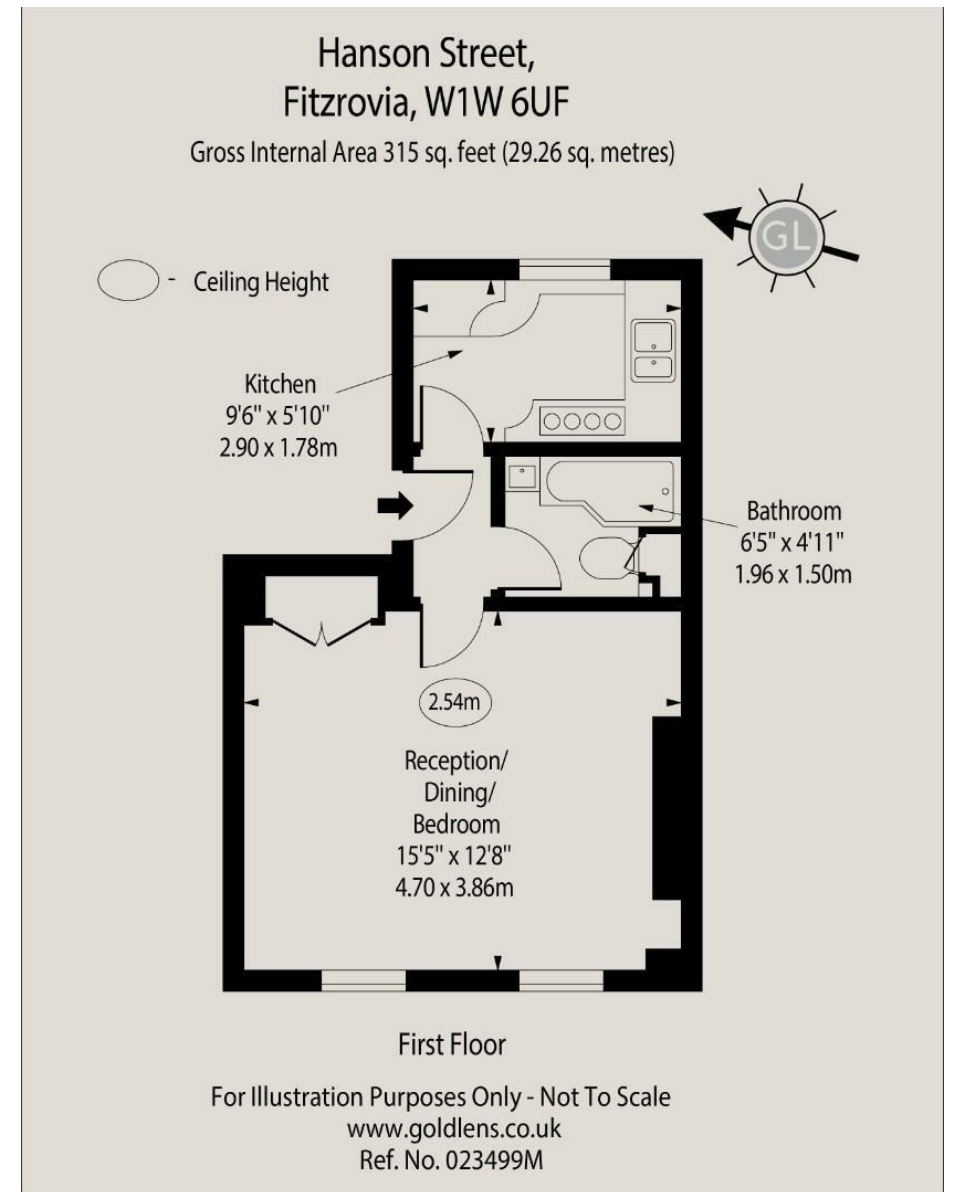

For clarification purposes we would advise purchasers that these particulars were prepared in good faith to give a general description of the property. We have not carried out a detailed survey, nor tested the services, appliances and specific fittings. Measurements are for guidance purposes and if such details are of vital importance, purchasers must make their own enquiries.

ADDRESS

Hanson Street, Fitzrovia, London

POSTCODE

W1W 6UF

LOCAL AUTHORITY

Westminster City Council

COMMUTE

Oxford Circus (Central, Bakerloo and Victoria Lines) - 644m

Great Portland Street (Circle, Hammersmith & City and Metropolitan lines) - 644m

Goodge Street (Northern line) - 644m

ON YOUR DOORSTEP

Riding House Café

Foleys

Alex Coffee

Crown and Sceptre

Pure Gym

Regents Park

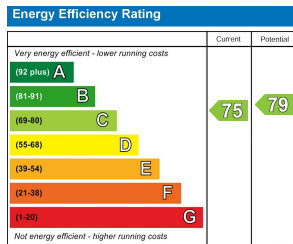

TENANT FEES SCHEDULE

Holding Deposit (per tenancy)

One week's rent. This is to reserve a property. Please Note: This will be withheld if any relevant person (including any guarantor(s)) withdraw from the tenancy, fail a Right-to-Rent check, provide materially significant false or misleading information, or fail to sign their tenancy agreement (and / or Deed of Guarantee) within 15 calendar days (or other Deadline for Agreement as mutually agreed in writing).

Security Deposit (per tenancy. Rent under £50,000 per year)

Five weeks' rent. This covers damages or defaults on the part of the tenant during the tenancy.

Security Deposit (per tenancy. Rent of £50,000 or over per year) Unpaid Rent

Six weeks' rent. This covers damages or defaults on the part of the tenant during the tenancy.

Unpaid Rent

Interest at 3% above the Bank of England Base Rate from Rent Due Date until paid in order to pursue non-payment of rent. Please Note: This will not be levied until the rent is more than 14 days in arrears.

Lost Key(s) or other Security Device(s)

Tenants are liable to the actual cost of replacing any lost key(s) or other security device(s). If the loss results in locks needing to be changed, the actual costs of a locksmith, new lock and replacement keys for the tenant, landlord any other persons requiring keys will be charged to the tenant. If extra costs are incurred there will be a charge of £15 per hour (inc. VAT) for the time taken replacing lost key(s) or other security device(s).

Variation of Contract (Tenant's Request)

£50 (inc. VAT) per agreed variation. To cover the costs associated with taking landlord's instructions as well as the preparation and execution of new legal documents.

Change of Sharer (Tenant's Request)

£50 (inc. VAT) per replacement tenant or any reasonable costs incurred if higher. To cover the costs associated with taking landlord's instructions, new tenant referencing and Right-to-Rent checks, deposit registration as well as the preparation and execution of new legal documents.

Early Termination (Tenant's Request)

Should the tenant wish to leave their contract early, they shall be liable to the landlord's costs in re-letting the property as well as all rent due under the tenancy until the start date of the replacement tenancy. These costs will be no more than the maximum amount of rent outstanding on the tenancy.

IF YOU HAVE ANY QUESTIONS REGARDING OUR FEES, PLEASE ASK A MEMBER OF STAFF

