



LDG

GRAFTON WAY
Bloomsbury



Grafton Way







ADDRESS	POSTCODE	LOCAL AUTHORITY	RENT
Grafton Way, Bloomsbury	WC1E 6DY	Camden	£595 Per Week

THE SPACE

This beautiful apartment offers stylish and practical living. Perched upon the 7th floor, the whole apartment is bathed in southerly light. This bright accommodation features a spacious double bedroom, a modern (semi-open plan) kitchen with full size fridge/freezer and a generous reception room with views of the BT Tower.

30-40 Grafton Way is the residential element of Maple House, an iconic granite and mosaic faced building based in Bloomsbury/Fitzrovia border and was designed by the distinguished Seifert and Partners, who created London’s most iconic buildings of the modern era – such as the nearby Centre Point Tower

Within a short stroll of the culinary delights of Charlotte Street and the village atmosphere of Store Street. Warren Street, Euston Square, St Pancras and Kings Cross stations, Euston and Kings Cross station are all close by.

Specifics

ACCOMMODATION & FEATURES	COMMUTE	ON YOUR DOORSTEP
<ul style="list-style-type: none"> • Available Now • Newly Refurbished • Semi Open Plan Kitchen • 7th Floor - Lift • Great Views of the BT Tower • Spacious Double Bedroom • Abundant Built in Storage • Managed by LDG 	<p>Warren Street Station 170m</p> <p>Euston Square Station 350m</p>	<p>Honey & Spice</p> <p>The Life Goddess</p> <p>Planet Organic</p> <p>Rathbone Boxing Club</p>

Grafton Way,
Bloomsbury, WC1E 6DY

Gross Internal Area 499 sq. feet (46.36 sq. metres)

○ - Ceiling Height

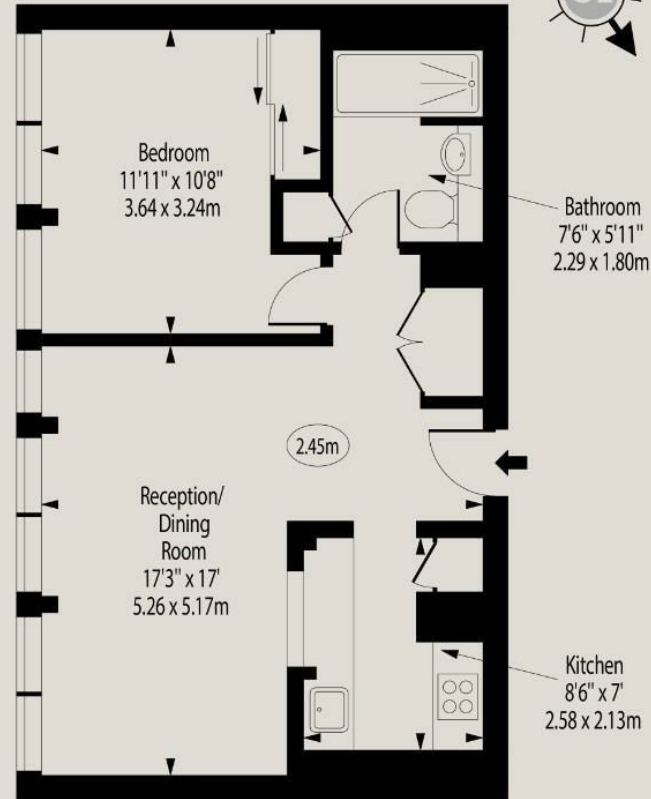

Seventh Floor

For Illustration Purposes Only - Not To Scale
www.goldlens.co.uk
Ref. No. 023354MS

Floor Plan

Ready to talk?



**MAX
CHAUDRY**

DD: 020 7291 0998
M: 07756 873938
E: max@ldg.co.uk



**VAS
VASILOKONSTANTAKIS**

DD: 020 7292 0990
M: 07809 410 252
E: vas@ldg.co.uk



**THEMIS
POLLALIS**

DD: 020 4513 6751
M: 07809 410 182
E: themis@ldg.co.uk

LDG | www.ldg.co.uk
53 Great Titchfield Street
London, W1W 7JP

Grafton Way

