



LDG

UNIVERSITY STREET

Bloomsbury

£625,000 STC





ldg.co.uk

ldg.co.uk

LDG.CO.UK



Energy Efficiency Rating		
	Current	Potential
Very energy efficient - lower running costs		
(92 plus) A		
(81-91) B		82
(69-80) C	73	
(55-68) D		
(39-54) E		
(21-38) F		
(1-20) G		
Not energy efficient - higher running costs		
England & Wales	EU Directive 2002/91/EC	

**ADDRESS**

University Street, London

POSTCODE

WC1E 6JW

THE SPACE

This stylish and spacious west-facing one-bedroom apartment is situated on the fifth floor of a highly regarded Art Deco block, in Fitzrovia. With open roof top views, the property features a generously proportioned reception and bedroom, and an eat-in kitchen.

Paramount Court is a secure development with concierge. Just a short stroll from Warren Street and Goodge Street Stations, you are close by to the culinary delights of Charlotte Street and the village atmosphere of Store Street. The greenery of The Regents Park is also nearby.

ACCOMMODATION**& FEATURES**

- Share of Freehold
- Portered Block
- Service Charge Includes Heating and Hot Water
- Sinking Fund
- Fifth Floor - Two Lifts
- Good Natural Light
- Eat-In Kitchen
- Spacious Bedroom
- Smart Communal Areas

ON YOUR DOORSTEP

Honey & Spice
The Life Goddess
Planet Organic
The Regents Park

PRICE

£625,000, subject to contract

TENURE

83 year Leasehold - Share of Freehold

SERVICE CHARGE

£8,310.66

March 23 - March 24 includes heating, hot water, porter and a reverse fund contribution of £2499.

GROUND RENT

Peppercorn

COUNCIL TAX

Camden London Borough Council
Band E

RESIDENTS PARKING

TBC

COMMUTE

Warren Street 290m
Goodge Street 350m
Euston Square 350m
Great Portland Street 700m

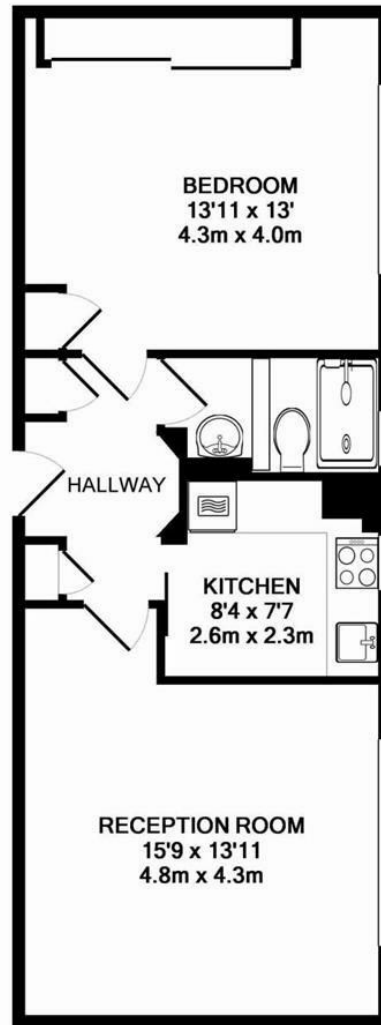

PARAMOUNT COURT WC1
TOTAL APPROX. FLOOR AREA 532 SQ.FT. (49.5 SQ.M.)
Measurements are approximate. Not to scale. Illustrative purposes only

Ready to talk?



**BEN
EVEREST**

DD: 020 7290 0592
M: 07944 967637
E: ben@ldg.co.uk



**DAVID
CALDEIRA**

DD: 020 4513 6756
M: 07368 333 545
E: david@ldg.co.uk



**EMLYN
YOUNG**

DD: 020 7290 0593
M: 07881 971 315
E: emlyn@ldg.co.uk



**DEE
LY**

DD: 020 4542 4872
T 020 7580 1010
E: dee@ldg.co.uk