



**Rousies Close, Hadleigh,
Suffolk, IP7 5SR
Offers In Excess Of £260,000
Freehold**

This well presented three bedroom detached property is situated in the much sought after Hadleigh location and is set back in a quiet cul-de-sac. The property benefits from a large blocked paved driveway which offers off-road parking for multiple vehicles and a generous rear garden. As agents, we recommend the earliest possible internal viewing to appreciate the quality of accommodation on offer which comprises entrance hall, lounge, dining room, conservatory, kitchen, first floor landing, three bedrooms and a family bathroom.

Hadleigh is an ancient market town in South Suffolk situated next to the River Brett between the larger towns of Sudbury and Ipswich. The town has many amenities including shops, pubs, churches, schools, outdoor recreational facilities, equestrian centre and paintball centre. Hadleigh is home to some 246 listed buildings and the Grade II listed Topplesfield Bridge, over the River Brett, is the oldest in the country still carrying vehicles. One of the oldest one-day agricultural shows in East Anglia is also held annually in Hadleigh.

- Detached Property
- Three Bedrooms
- Two Reception Rooms
- Conservatory
- Good Sized Rear Garden
- Off-Road Parking

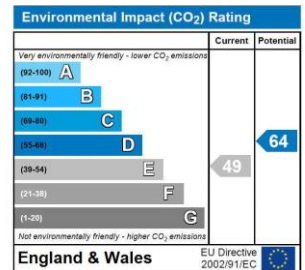
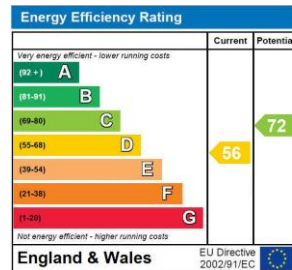
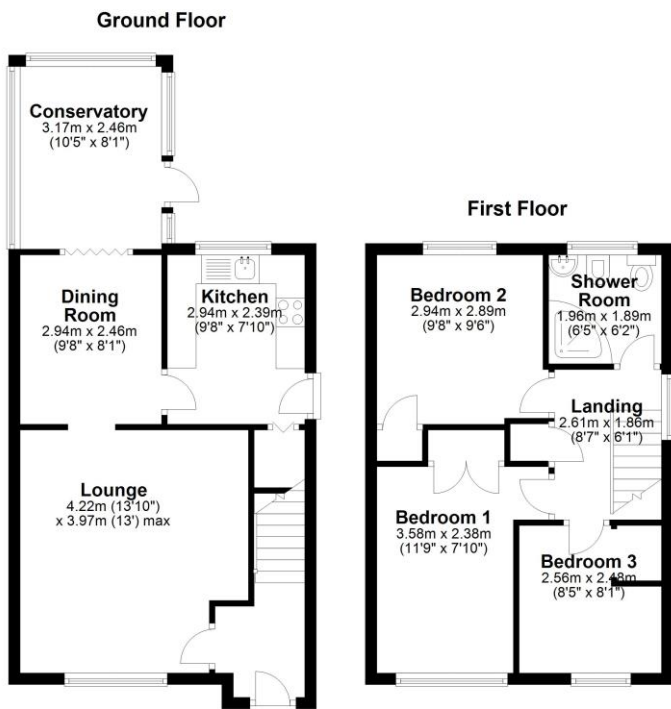

Palmer and Partners would like to draw your attention to the following: I] these particulars do not constitute part of an offer or contract. II] these particulars and any pictures or plans represent the opinion of the author and are given in good faith for guidance only and must not be construed as statement or fact. III] nothing in these particulars shall be deemed a statement that the property is not in good condition or otherwise. We have not carried out a structural survey of the property and have not tested services, appliances and special fittings IV] measurements are generally taken by the use of a sonic measuring machine and will usually be the largest measurements of the room in question.