

Tudor

syrfewyr siartredig | gwerthwyr eiddo | rheolwyr meddiannau
chartered surveyors | estate agents | property managers



Gwenlli 11 Glanerch, Abererch, LL53 6AX

£875 Per calendar month

- Semi-Detached Bungalow
- Only a Few Miles to Pwllheli
- Large Rear Garden with Stream Boundary
- Small Rural Village
- 2 Bedrooms on Ground Floor & 2 Loft Bedrooms
- Parking & Garage



Gwenlli 11 Glanerch, Abererch, LL53 6AX

This semi-detached bungalow is located in a cul-de-sac in a small rural village which is only a few miles from Pwllheli the market town for the glorious Llyn Peninsula.

Pwllheli boasts excellent amenities including leisure centre, golf course and award winning marina.

The accommodation has the benefit of gas central heating, UPVC double glazed windows and briefly comprises of the following:

Hall. Lounge. Kitchen-Diner. Shower Room. Two bedrooms. Two Loft Bedrooms & Toilet on the first floor. The property has the advantage of ample parking area and garden to the front. Garage. Useful Hobby Room. Large Rear Garden with stream boundary.

Council Tax Band 'D'. Deposit £950

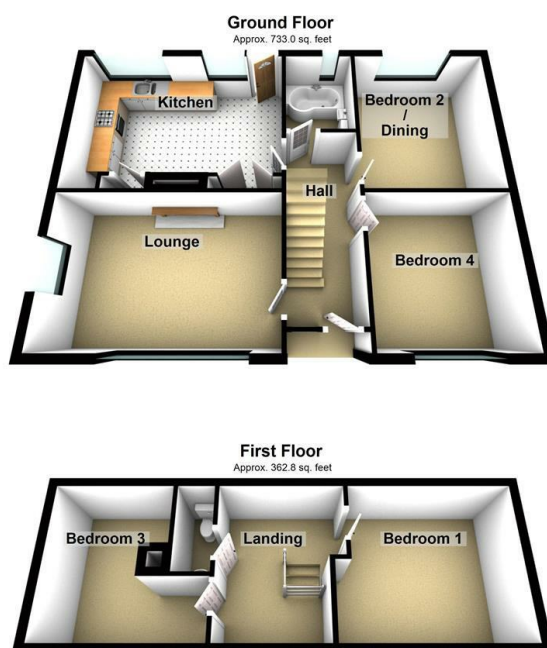

Total area: approx. 1095.7 sq. feet
Copyright Tudor Estate Agents. For room identification only.
Plan produced using PlanUp.

Gwenlli, Glan Erch, Abererch, Pwllheli

From Pwllheli proceed east on the A497, after leaving the 30 mile an hour limit on Abererch Road (proceeding on in the directions of Criccieth) take the left turning sign posted Abererch, proceed into the village pass the school and then take the next left turn into Glanerch, proceed into the small estate and Gwenlli is on the left. O. S Ref: SH 398 367 Sat Nav Ref: LL53 6AX



Tudor

Plas Y Ward, Y Maes, Pwllheli, Gwynedd, LL53 5DA

T: 01758 701 100

E: info@huwtudor.co.uk

www.huwtudor.co.uk