



Finchleys are proud to present this one bedroom maisonette located in a lovely secluded private development within a few minutes walk from Finchley Central station. The property offers spacious and bright accommodation, including a bright reception room, a spacious bedroom, a fitted kitchen, a bathroom suite with shower over bath and is located moments from the vast array of shops, restaurants and supermarkets on Ballards Lane.

The property comes with allocated parking.

A viewing is highly recommended.

Dorset Mews, London, N3

**£1,600 Per  
Per Calendar**

1  1  1  C 



**FINCHLEYS  
ESTATES**

CLIENT FOCUSED. RESULTS DRIVEN.





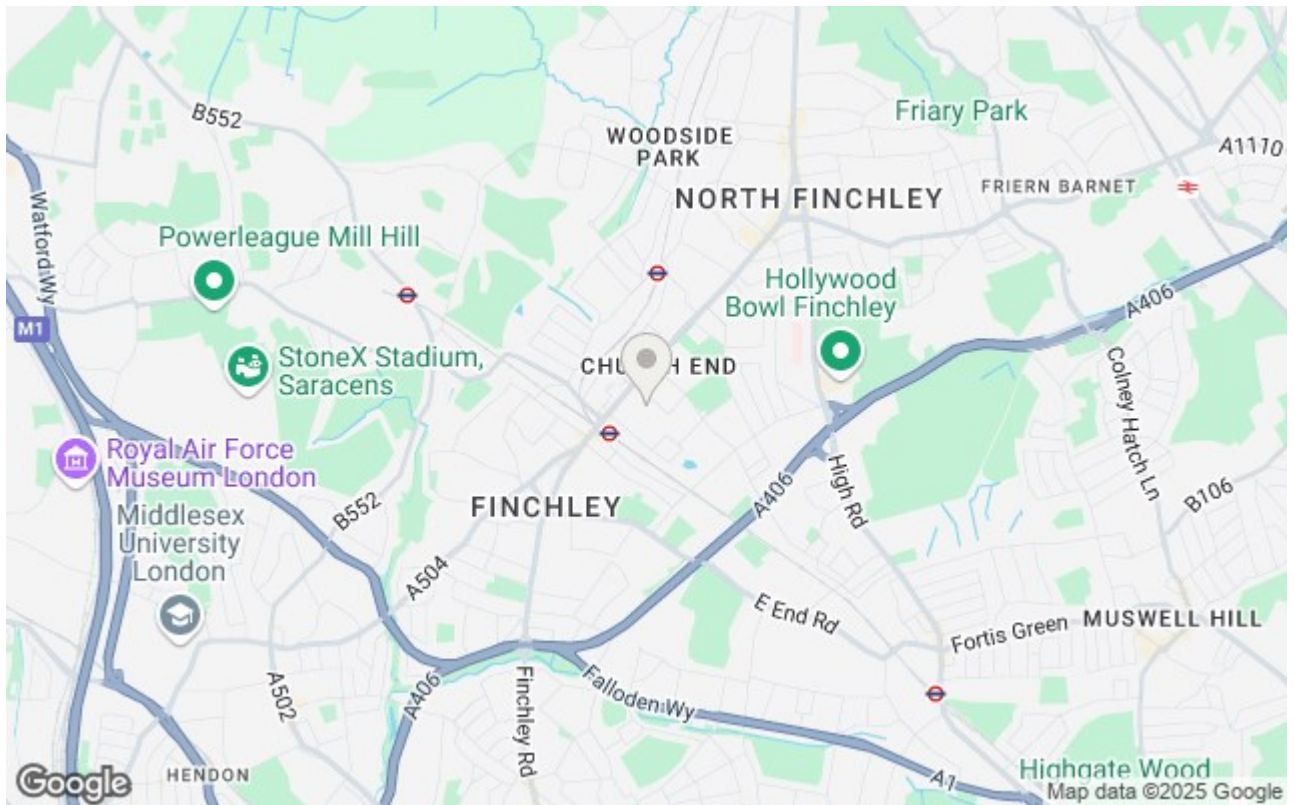

**Dorset Mews, N3**

CAPTURE DATE 23/11/2021 LASER SCAN POINTS 1,250,979

GROSS INTERNAL AREA

40.60 sqm / 437.01 sqft

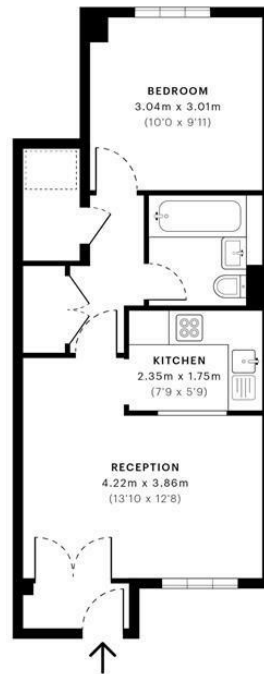

— Ground Floor

GROSS INTERNAL AREA (GIA)  
The footprint of the property  
40.60 sqm / 437.01 sqft

NET INTERNAL AREA (NIA)  
Excludes walls and external features  
Includes windows, restricted head height  
37.82 sqm / 407.09 sqft

EXTERNAL STRUCTURAL FEATURES  
Balconies, terraces, verandas etc.  
0.00 sqm / 0.00 sqft

RESTRICTED HEAD HEIGHT  
Limited use area under 1.5m  
0.70 sqm / 7.53 sqft



Speco Verified floor plans are produced in accordance with Royal Institution of Chartered Surveyors' Property Measurement Standards. Plots and gardens are illustrative only and excluded from all area calculations. Due to rounding, numbers may not add up precisely. All measurements shown for the individual room lengths and widths are the maximum points of measurements captured in the scan.

IPWS 3B RESIDENTIAL 41.04 sqm / 441.75 sqft  
IPWS 3C RESIDENTIAL 38.45 sqm / 413.87 sqft

spec id: 619b65af3ba0850d9b5cf73



11 STATION ROAD  
FINCHLEY  
LONDON  
N3 2SB  
02083461180