



Montpelier Road, London, N3

3 bedroom semi-detached house with great potential! This lovely property boasts 2 reception rooms, 3 bedrooms, and 1 bathroom, providing ample space for comfortable living.

Situated in a sought-after location close to Manorside Primary School, this home is perfect for families with young children.

One of the standout features of this property is the scope for a loft conversion, offering the opportunity to further enhance the living space and add value to the home. Additionally, being chain-free means a smoother and quicker process for potential buyers.

As the sole agents for this property, we are excited to present this wonderful opportunity to own a home in this desirable area. Don't miss out on the chance to make this house your own and create a space that truly reflects your style and needs. Contact us today to arrange a viewing and take the first step towards owning your dream home in Montpelier Road!

Offers Over
£600,000

3  1  2  



**FINCHLEYS
ESTATES**

CLIENT FOCUSED. RESULTS DRIVEN.

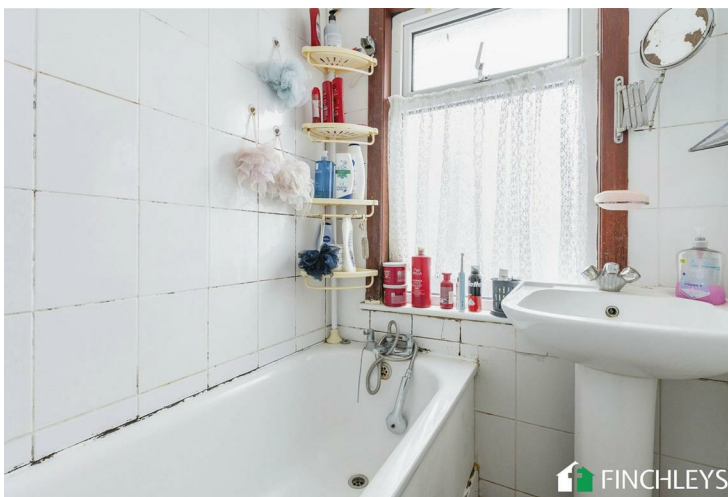

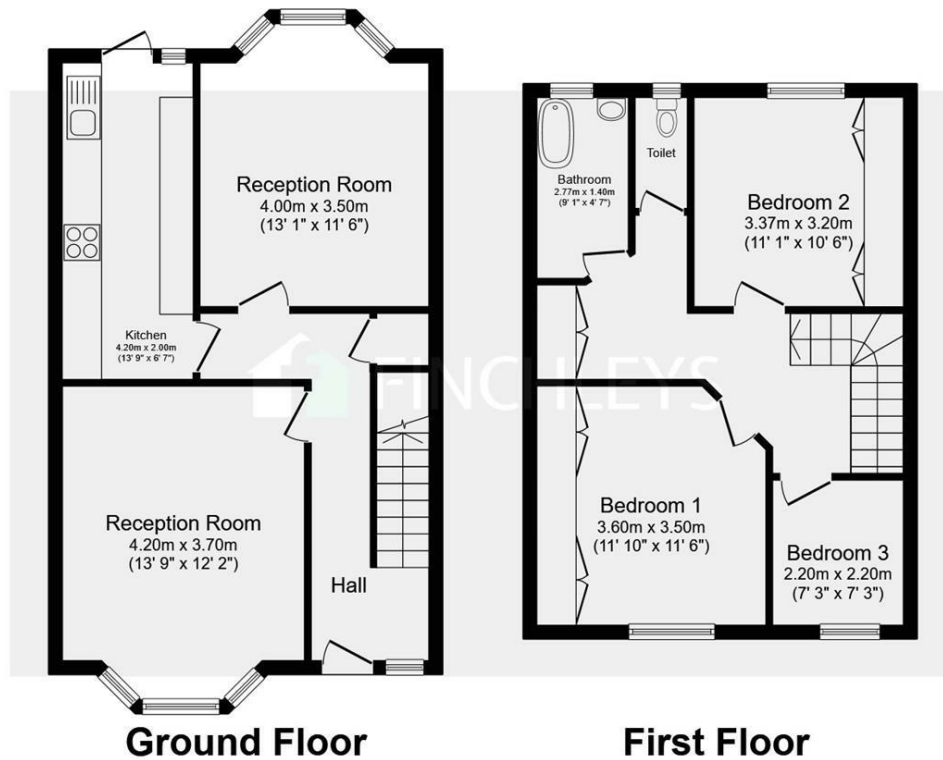
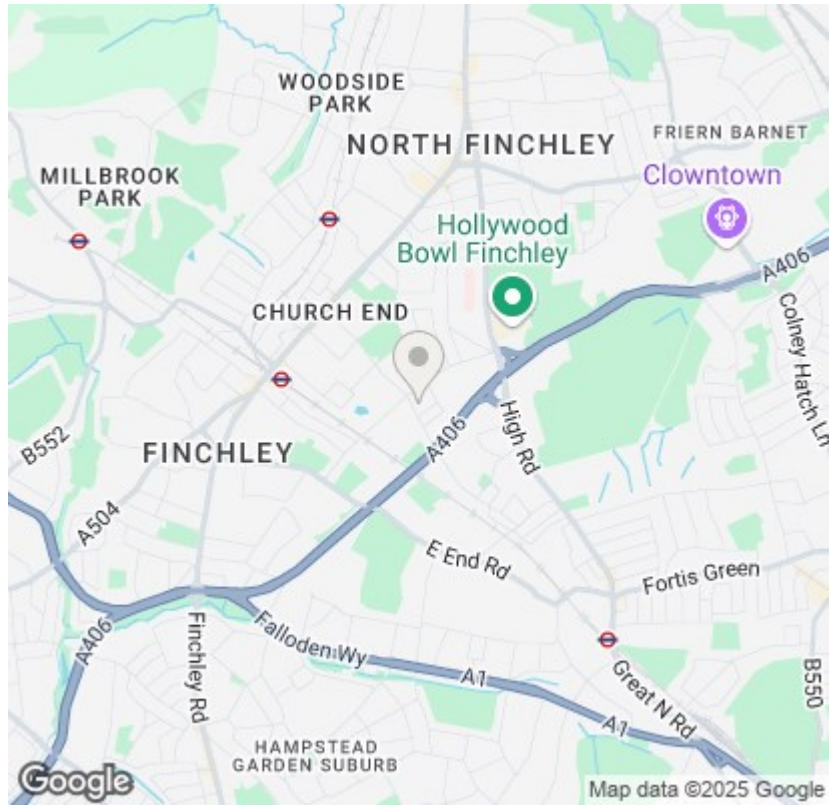

Total floor area 98.5 sq.m. (1,060 sq.ft.) approx

This floor plan is for illustrative purposes only. It is not drawn to scale. Any measurements, floor areas (including any total floor area), openings and orientation are approximate. No details are guaranteed, they cannot be relied upon for any purpose and they do not form part of any agreement. No liability is taken for any error, omission or misstatement. A party must rely upon its own inspection(s).
Powered by www.focalagent.com



11 STATION ROAD
FINCHLEY
LONDON
N3 2SB
02083461180