



Welcome to this charming first floor studio flat located on Nether Street in the sought-after area of Finchley Central, N3.

Upon entering, you are greeted by a spacious reception room with high ceilings, creating an airy and bright atmosphere. The property boasts a separate kitchen, perfect for whipping up your favourite meals.

This larger than average studio is in excellent condition, ensuring a comfortable and convenient living space.

Situated close to Finchley Central Tube station, commuting is a breeze, making this property ideal for professionals or those who enjoy exploring the city.

Don't miss out on the opportunity to rent this delightful studio flat in a prime location. Book a viewing today!

Nether Street, London, N3

£1,350
Per Calendar
Month

1  1  1  



**FINCHLEYS
ESTATES**
CLIENT FOCUSED. RESULTS DRIVEN.



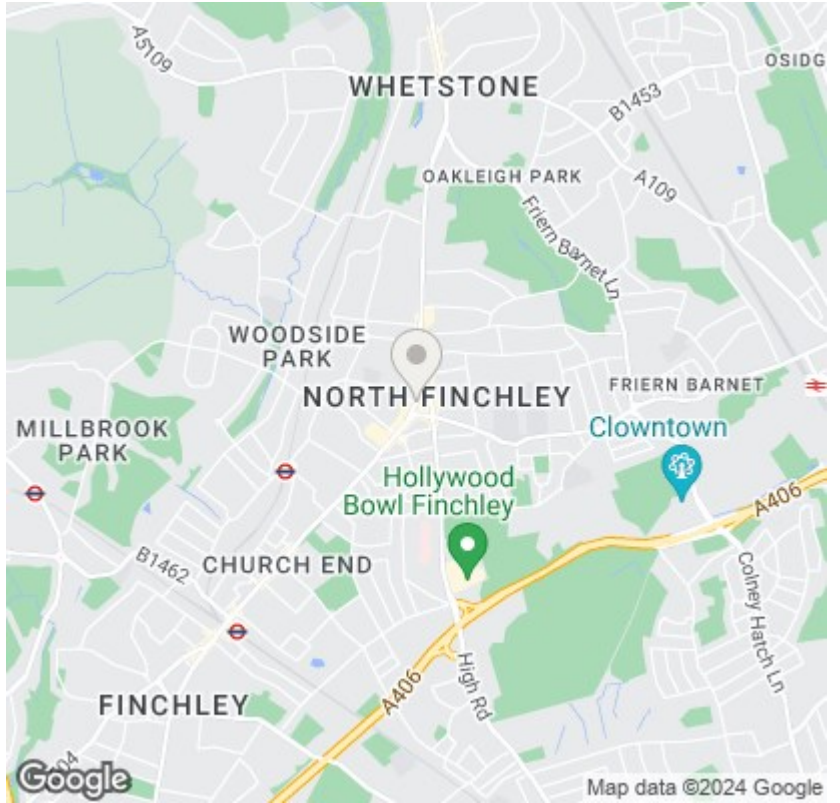

Nether Street, N3

CAPTURE DATE: 21/04/2021 LASER SCAN POINTS: 875,113

GROSS INTERNAL AREA

38.21 sqm / 411.29 sqft

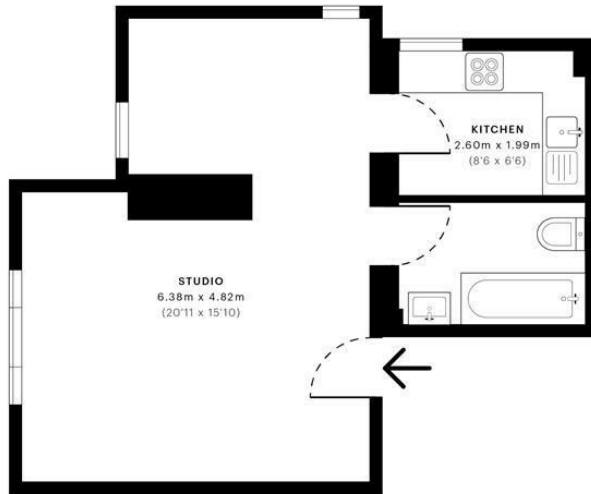

— First Floor

GROSS INTERNAL AREA (GIA)
The footprint of the property
38.21 sqm / 411.29 sqft

NET INTERNAL AREA (NIA)
Excludes walls and external features
includes mezzanines, restricted head height
35.40 sqm / 381.04 sqft

EXTERNAL STRUCTURAL FEATURES
Balconies, terraces, verandas etc.
0.00 sqm / 0.00 sqft

RESTRICTED HEAD HEIGHT
Limited use area under 1.5 m
0.00 sqm / 0.00 sqft



Speco Verified floor plans are produced in accordance with Royal Institution of Chartered Surveyors' Property Measurement Standards. Plots and gardens are illustrative only and excluded from all area calculations. Due to rounding, numbers may not add up precisely. All measurements shown for the individual room lengths and widths are the maximum points of measurements captured in the scan.

IPMS 3B RESIDENTIAL 38.65 sqm / 416.03 sqft
IPMS 3C RESIDENTIAL 35.92 sqm / 386.64 sqft

spec id: 607664021079e50dbafaa262



11 STATION ROAD
FINCHLEY
LONDON
N3 2SB
02083461180