

TO LET

7, Beech Grove, Beech Hill, WN6 8PD

REGAN &
HALLWORTH
The Professional Estate & Letting Agents



7, Beech Grove, Beech Hill, WN6 8PD

Modern and spacious three bed semi-detached home located in Beech Hill.



- Modern semi-detached family home
- Open plan kitchen / dining room
- Family bathroom / shower over bath
- Close to schools and amenities
- Great sized reception room
- Two double and one single bedroom
- Front and rear gardens / driveway
- 823 SQ. FT.

Now available to let and located in the popular area of Beech Hill in Wigan is this impressive, three bed semi-detached home. Beech Grove has been finished to a great standard throughout offering spacious accommodation set over two floors. The property offers easy access to a range of local amenities, schools for all ages, town centre and great public transport links.

In brief the accommodation comprises entrance hallway, large formal lounge / sitting room with windows to the front and rear then a modern fitted, open plan kitchen / breakfast room with the kitchen offering a range of wall, base and drawer units. Up on the first floor there are two large double bedrooms, one single bedroom and a family bathroom with shower over bath.

Externally Beech Grove has a walled and gated front garden with driveway whilst to the rear there is a large, private and enclosed garden with patio and lawn. Internal inspection is highly recommended to fully appreciate the properties size, finish and great location.



GROUND FLOOR
411 sq.ft. (38.2 sq.m.) approx.

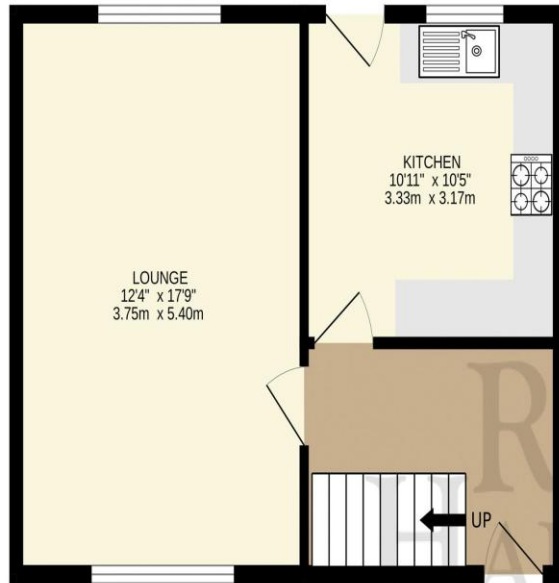

1ST FLOOR
411 sq.ft. (38.2 sq.m.) approx.

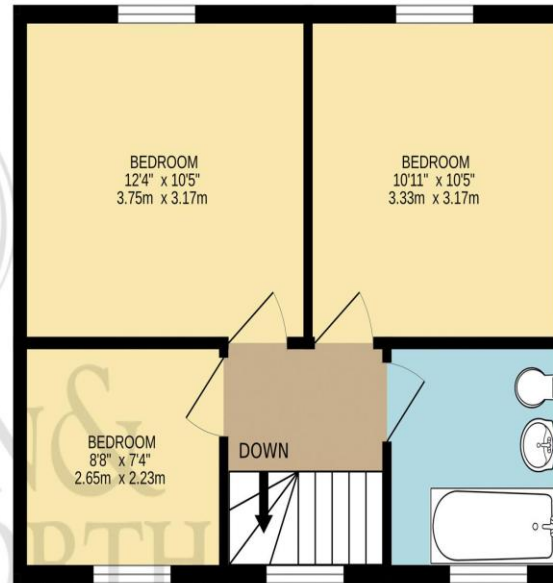

TOTAL FLOOR AREA : 823 sq.ft. (76.4 sq.m.) approx.

Whilst every attempt has been made to ensure the accuracy of the floorplan contained here, measurements of doors, windows, rooms and any other items are approximate and no responsibility is taken for any error, omission or mis-statement. This plan is for illustrative purposes only and should be used as such by any prospective purchaser. The services, systems and appliances shown have not been tested and no guarantee as to their operability or efficiency can be given.
Made with Metropix ©2025

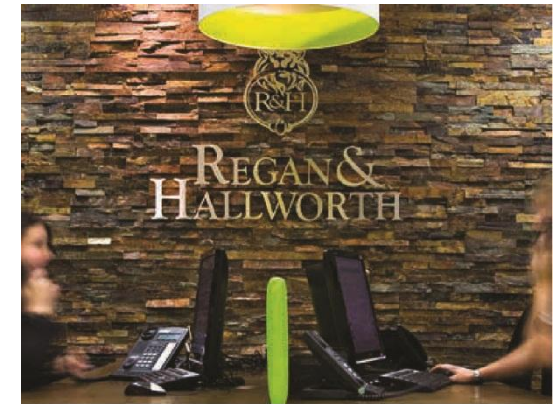

WIGAN OFFICE

4-6 Library Street, Wigan
Lancashire WN1 1NN
01942 205555
wigan@reganandhallworth.com

STANDISH OFFICE

8 High Street, Standish
Wigan WN6 0HL
01257 473727
standish@reganandhallworth.com

PARBOLD OFFICE

5-7 Station Road, Parbold Village
Lancashire WN8 7NU
01257 464644
parbold@reganandhallworth.com

rightmove

onTheMarket.com

The Property Ombudsman

LR Finance

We do our best to ensure that our sales particulars are accurate and are not misleading. We also ask our clients to check their own sales particulars and verify the information contained in them is correct. However, fixtures and fittings and appliances have not been tested and therefore no guarantee can be given that they are in working order. All measurements and land sizes are quoted approximately. **Tenure** - Regan & hallworth have not had sight of the title documents and therefore the buyer is advised to obtain verification from their solicitors or surveyor. **Council Tax** - You are advised to contact the local authority for details. **Wigan:** 01942 244991 | **West Lancashire:** 01695 585258 | **Chorley:** 01257 515151. If there is any point of particular interest to you please contact us and we will be pleased to check the information.

@reganhallworth

Regan & Hallworth

@reganandhallworth

@reganhallworth

www.reganandhallworth.com