



Waterside Heights, Waterside Park, Booth Road, Royal Docks, E16

Price **£415 per week** | Furnished



Waterside Heights, Waterside Park, Booth Road, Royal Docks, E16



1 Bedroom



1 Bathroom



1 Reception



Large Private Terrace



Riverside Development



24-Hour Concierge



Gymnasium



Next to the Thames Barrier Park



0.2 MI Pontoon Dock

A wonderfully light one bedroom apartment with a large terrace within the Waterside Park development located on the bank of the Thames. This furnished apartment includes an open-plan living and dining area, fitted kitchen with integrated appliances, wood flooring, a good sized bedroom, fitted wardrobe for maximal space, modern bathroom décor and a large private terrace.

Residents benefit from a prime location close to the River Thames as well as on-site amenities such as a 24-hour concierge and a gym.

The nearby Thames Barrier Park provides an ideal green space for leisure activities or a quiet walk. There are plenty of amenities nearby including shops such as Sainsbury's, cafes and restaurants.

The development is located a short distance from Pontoon Dock DLR station (6mins walk), providing a valuable transport link for commutes across London. Custom House Station which is just over a mile from the property provides access to the high speed Crossrail (Elizabeth Line) to Heathrow Airport, central London or even as far as Essex.

Local Authority: Newham London

Council Tax Band: C

EPC: C

Security deposit: equivalent to 5 weeks' rent

Floorplan

42.7 sq ft | 460 sq m

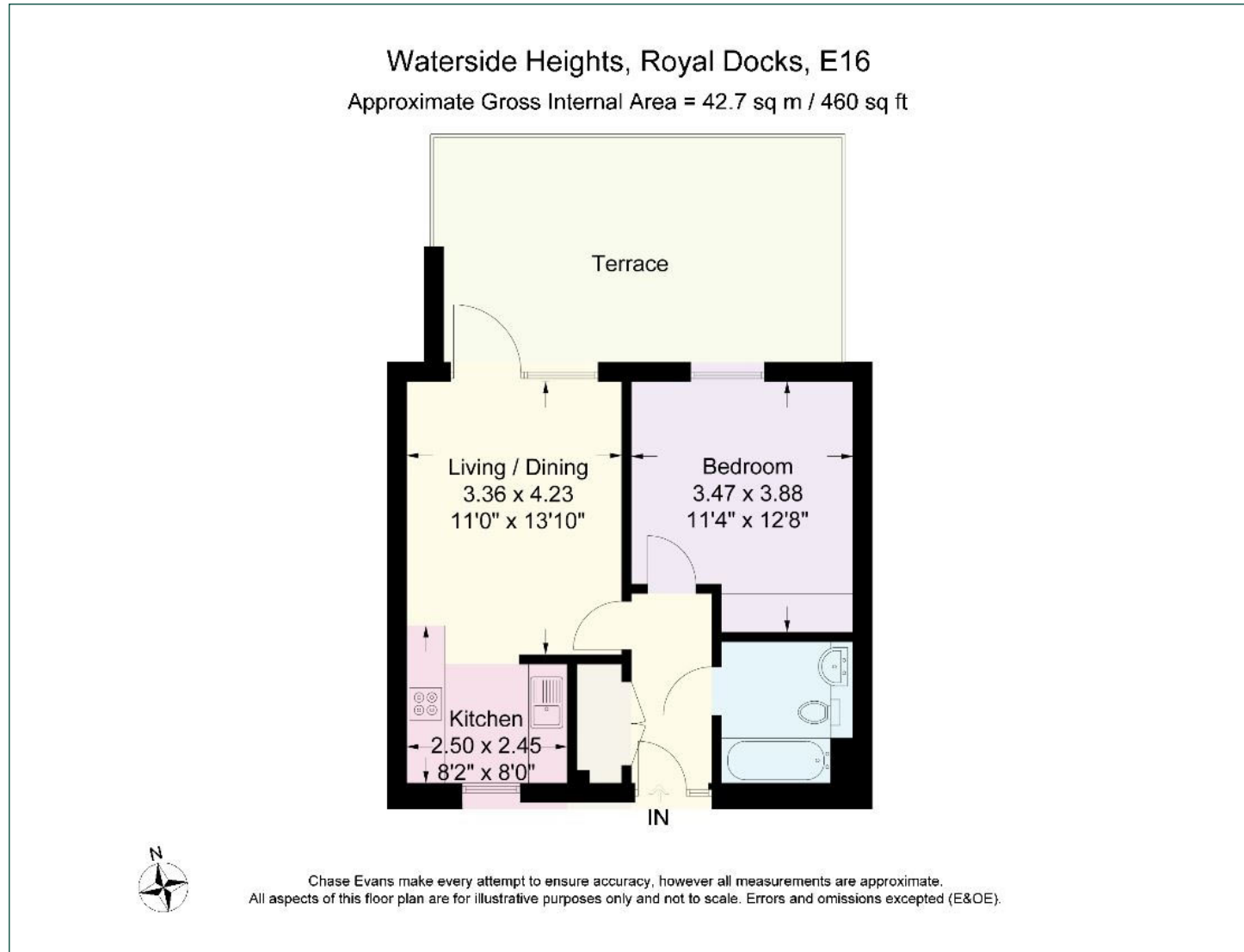

Docklands

St David's Square, 320 Westferry Road, London, E14 3QL

Lettings

020 7510 8444 | docklands.lettings@chaseevans.co.uk

We're here to help.

IMPORTANT NOTICE - These particulars have been prepared in good faith and they are not intended to constitute part of an offer or contract. We have not performed a structural survey on this property and the services, appliances and specific fittings have not been tested. All photographs, measurements, floor plans and distances referred to are given as a guide and should not be relied upon.

[chaseevans.com](https://www.chaseevans.com)

 Chase Evans