



## St Davids Square, Isle of Dogs, E14

Price **£750 per week** | Furnished



# St Davids Square, Isle of Dogs, E14



3 Bedrooms



2 Bathrooms



2 Receptions



Balcony



Terrace



Gymnasium



Local Amenities



24-Hour Concierge



0.3 MI Island Gardens

A delightfully spacious three bedroom, two bathroom riverside apartment with a large private terrace and a balcony in this sought-after, contemporary residential development close to Island Gardens DLR station. This apartment measures approx. 1043 sq. ft. and comprises a separate, fully integrated galley kitchen, a bright living room with direct views of the Thame and three double bedrooms served by a full size bathroom.

St David's Square is a gated development with an on site gym, swimming pool, landscaped gardens

and 24-hour concierge services. DLR connections with Canary Wharf and Greenwich are excellent. Nearby the development is the Greenwich Foot Tunnel linking the location with rich maritime heritage along the south bank of the Thames.

**Local Authority:**

Tower Hamlets

**Council Tax Band:**

G

**EPC:**

C

**Security deposit:**

equivalent to 5 weeks' rent

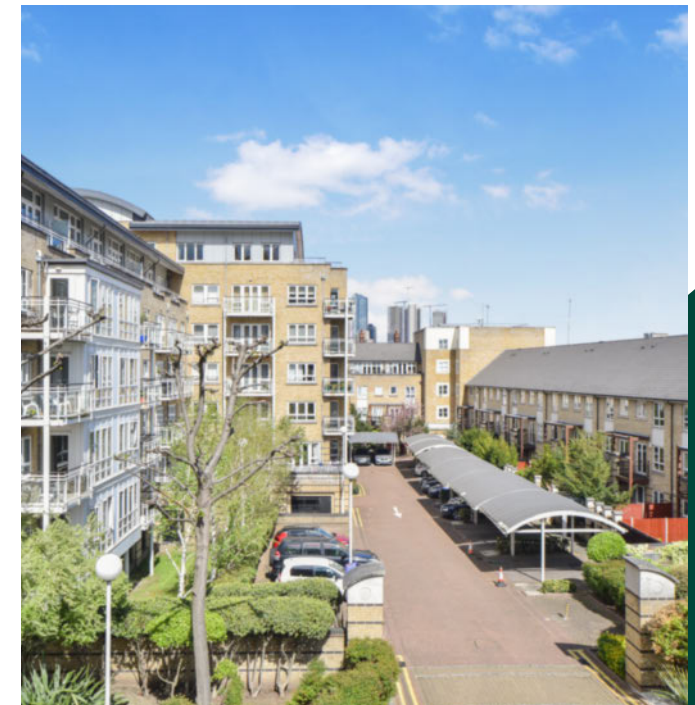

# Floorplan

1,043 sq ft | 96.89 sq m

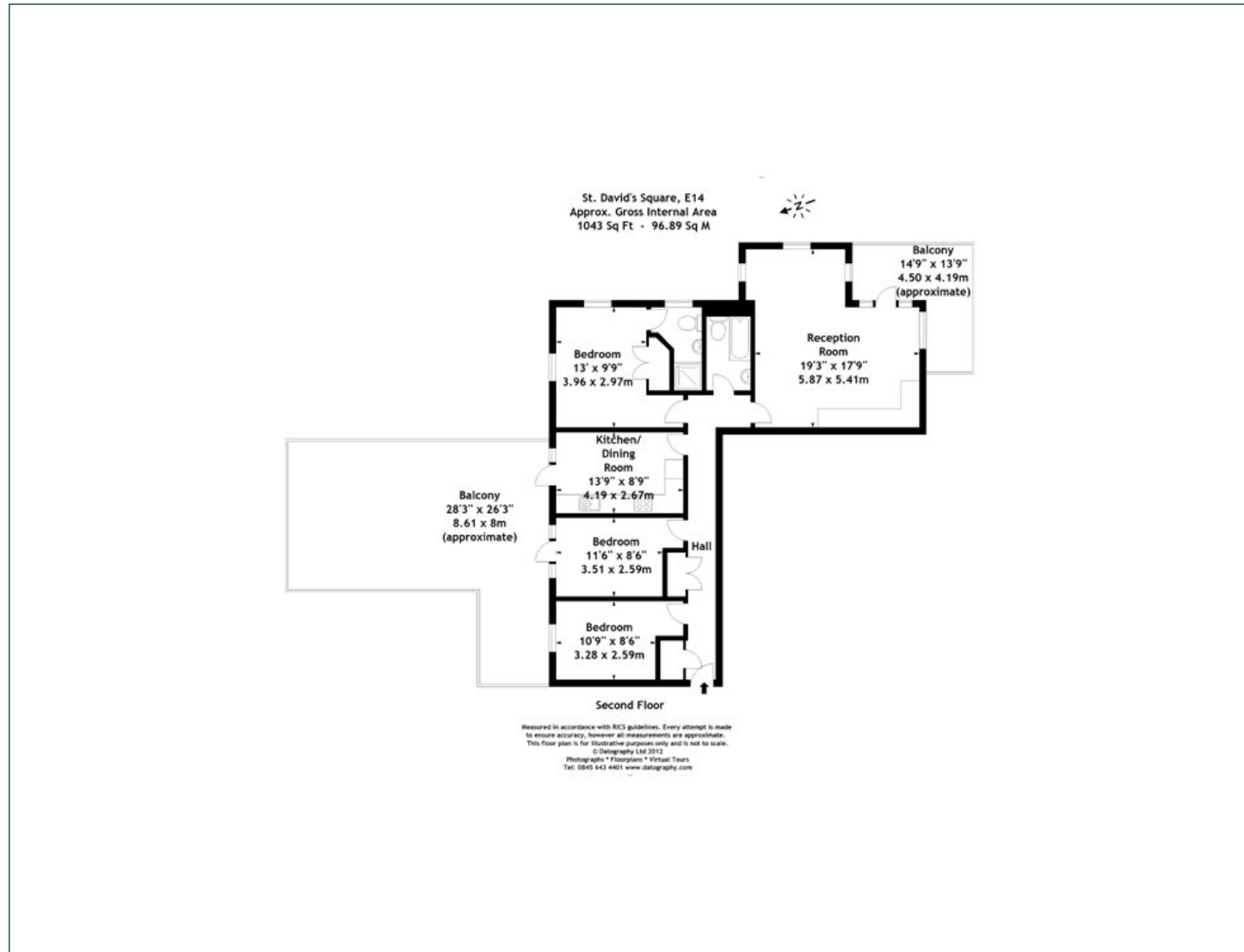

## Docklands

St David's Square, 320 Westferry Road, London, E14 3QL

## Lettings

020 7510 8444 | [docklands.lettings@chaseevans.co.uk](mailto:docklands.lettings@chaseevans.co.uk)

## We're here to help.

IMPORTANT NOTICE - These particulars have been prepared in good faith and they are not intended to constitute part of an offer or contract. We have not performed a structural survey on this property and the services, appliances and specific fittings have not been tested. All photographs, measurements, floor plans and distances referred to are given as a guide and should not be relied upon.

[chaseevans.com](http://chaseevans.com)