



Heritage Tower, East Ferry Road, Isle Of Dogs, E14

OIEO **£700,000** | Leasehold



Heritage Tower, East Ferry Road, Isle Of Dogs, E14



2 Bedrooms



2 Bathrooms



1 Reception



Balcony



Gymnasium



Local Amenities



24-Hour Concierge



0.1 MI Crossharbour

A superb two bedroom, two bathroom property arranged over 897 sq ft on the 14th floor of a high specification development built in 2019 in E14. The property features a bright living room with floor-to-ceiling windows and engineered oak timber flooring, a well equipped modern kitchen with fitted appliances with under light cabinets, underfloor heating and a private balcony. Both bedrooms are double in size and have built-in wardrobes with the master bedroom also having an en suite shower room. Ample storage throughout.

The Heritage Tower offers residents a concierge service, gymnasium and bicycle storage. Conveniently located next to Crossharbour DLR station which provides access to Canary Wharf station and Canary Wharf Shopping Centre in 4 minutes. Canary Wharf Station links include the Jubilee Line and Crossrail (Elizabeth Line) service for high speed connection around the capital.



Tenure: Leasehold (994 years remaining) **Local Authority:** Tower Hamlets

Ground Rent: £325 p.a. **Council Tax Band:** F

Service Charge: £4,800 p.a. **EPC:** B

Floorplan

897 sq ft | 83.4 sq m

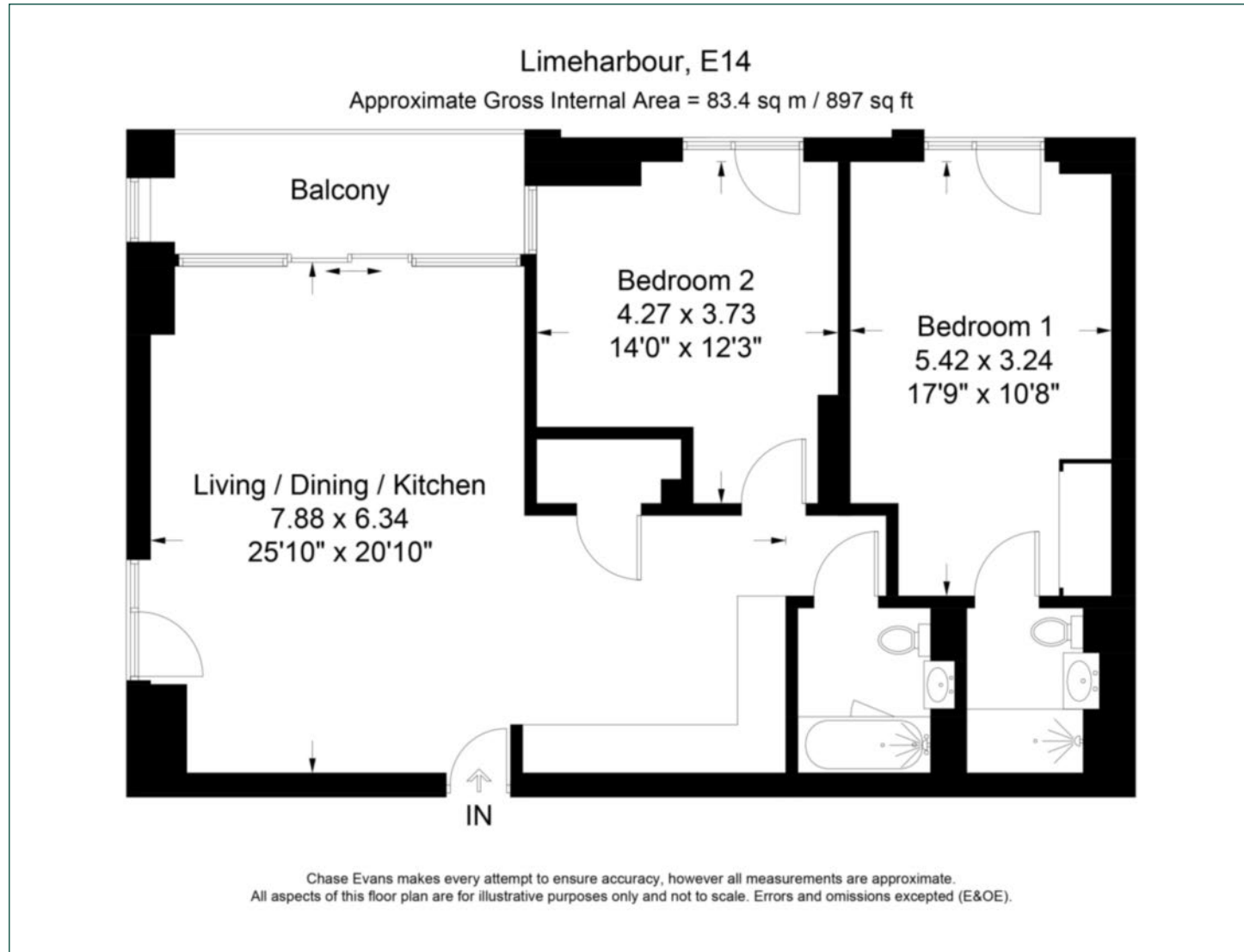

Docklands

St David's Square, 320 Westferry Road, London, E14 3QL

Sales

020 7510 8445 | docklands.sales@chaseevans.com

We're here to help.

IMPORTANT NOTICE - These particulars have been prepared in good faith and they are not intended to constitute part of an offer or contract. We have not performed a structural survey on this property and the services, appliances and specific fittings have not been tested. All photographs, measurements, floor plans and distances referred to are given as a guide and should not be relied upon.

chaseevans.com

 Chase Evans