



Fawley Lodge, Millennium Drive, Docklands, E14

Asking price **£400,000** | Leasehold



Fawley Lodge, Millennium Drive, Docklands, E14



2 Bedrooms



1 Bathroom



1 Reception



Balcony



Secure Non Allocated Parking



Local Amenities



0.5 MI Island Gardens

A lovely two bedroom apartment situated in Fawley Lodge, E14. Comprising an inviting living area with north-west facing full height windows leading to a generous private balcony with Canary Wharf views and an enclosed kitchen with integrated appliances.

Two sizable bedrooms offering a bright and airy feel, master bedroom with fitted wardrobe, plus a modern family bathroom suite. Ample hallway storage.

Residents benefit from secure non allocated parking. The property is located moments from Island Gardens (9mins walk) and Mudchute DLR stations (11mins walk), Thames Clipper services, Greenwich Foot Tunnel and other local transport links. With Millwall Park just 5mins away, an open green space to escape the urban scene, or play sports, is never far away.

Tenure: Leasehold (973 years remaining)

Local Authority: Tower Hamlets

Ground Rent: £25 p.a.

Council Tax Band: D

Service Charge: £2,200 p.a.

EPC: C

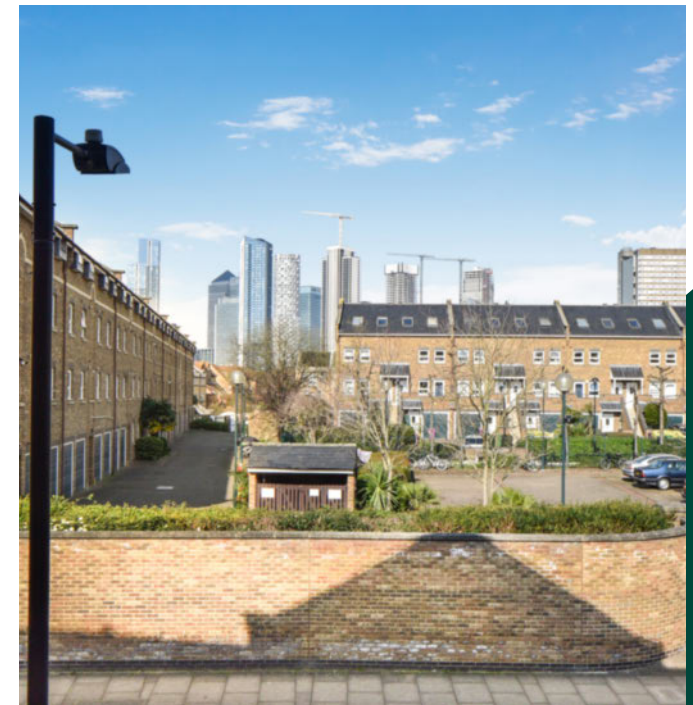
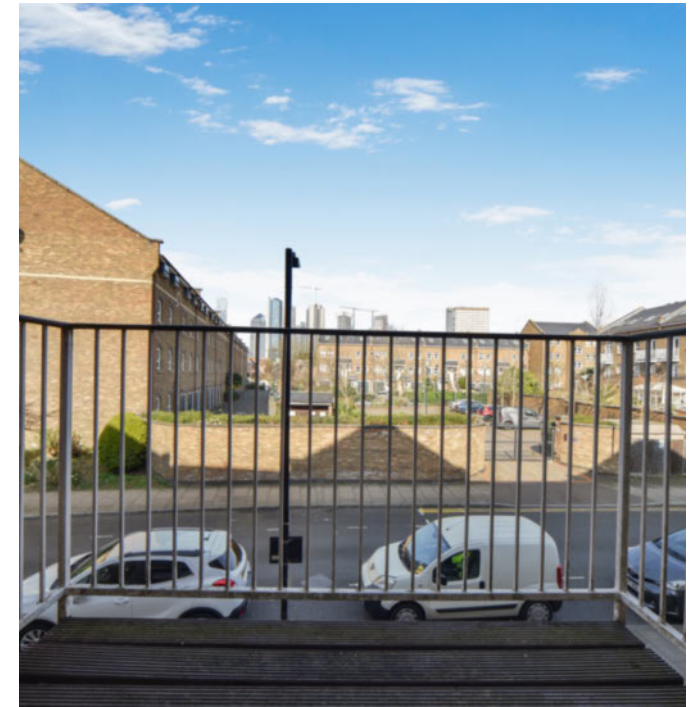

Floorplan

590 sq ft | 54.8 sq m

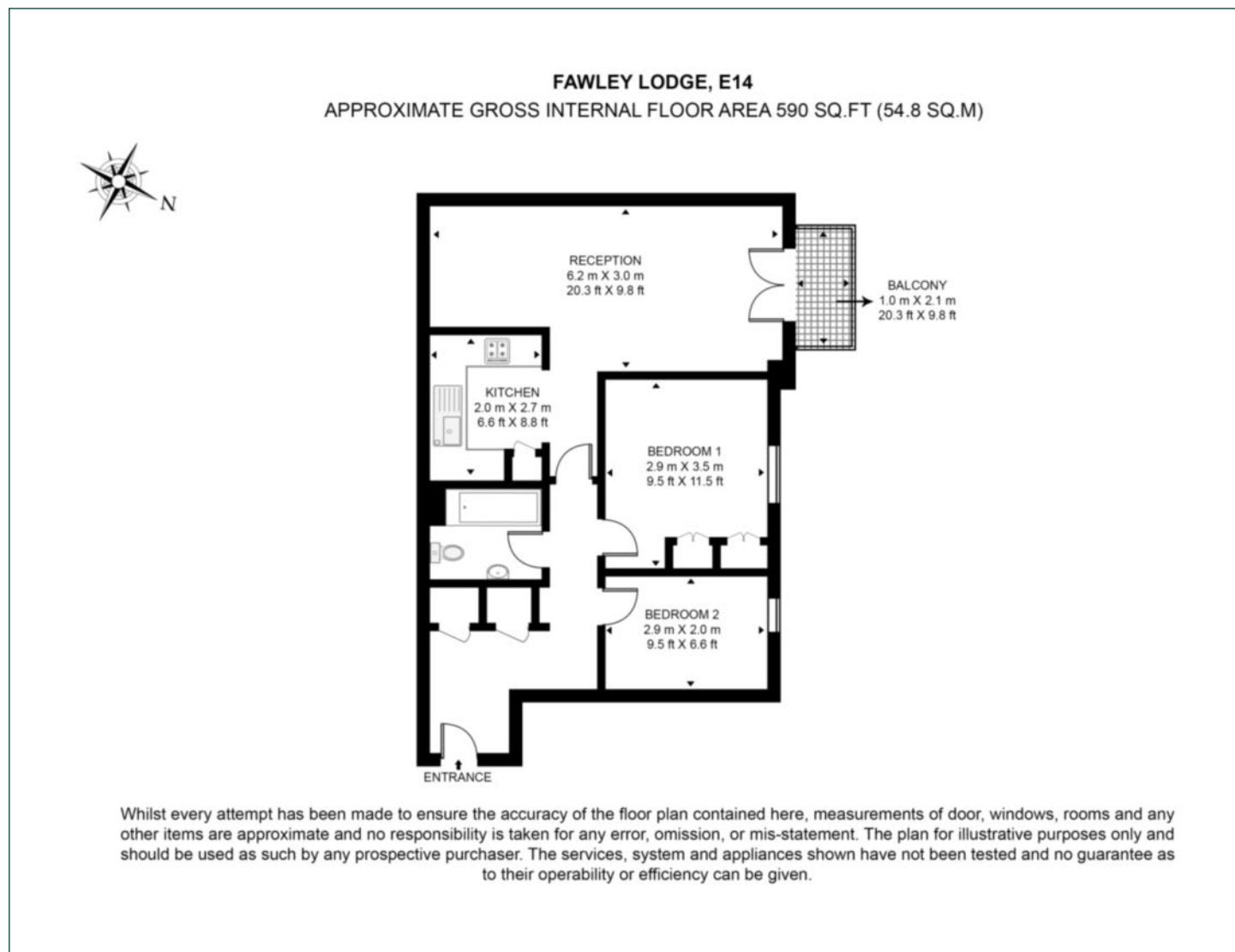

Docklands

St David's Square, 320 Westferry Road, London, E14 3QL

Sales

020 7510 8445 | docklands.sales@chaseevans.co.uk

We're here to help.

IMPORTANT NOTICE - These particulars have been prepared in good faith and they are not intended to constitute part of an offer or contract. We have not performed a structural survey on this property and the services, appliances and specific fittings have not been tested. All photographs, measurements, floor plans and distances referred to are given as a guide and should not be relied upon.

chaseevans.com

 Chase Evans