



## Westgate Apartments, Western Gateway, Royal Docks, E16

Asking price **£300,000** | Leasehold





# Westgate Apartments, Western Gateway, Royal Docks, E16



1 Bedroom



1 Bathroom



1 Reception



Gymnasium



Local Amenities



Concierge Services



0.2 MI Royal Victoria

Modern one bedroom apartment set within Westgate Apartments, Royal Docks E16. This apartment benefits from high specification fittings and fixtures throughout, spacious living area, wood flooring, large fitted kitchen with integrated appliances, floor-to-ceiling windows, recessed lighting, generous sized bedroom, tiled bathroom.

The development provides concierge services, access to residents' gym and communal terrace. The apartment is a stroll from the tranquil dock waters. The nearest station is Royal Victoria DLR station, only 0.2 miles away. And 0.3 miles to

Custom House station, served by DLR and Elizabeth lines. Also a short walk away from the Cable Car transport to Greenwich and the O2 Arena, as well as from the Excel Exhibition Centre.

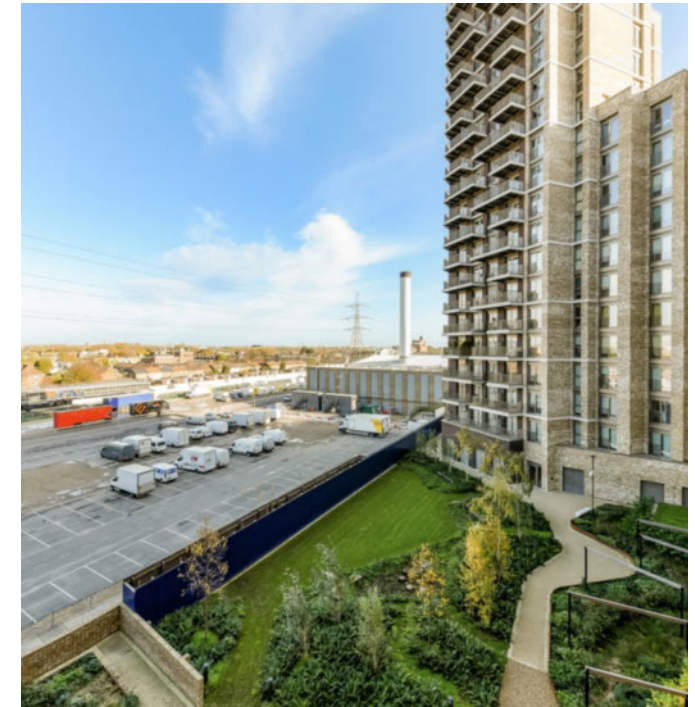

**Tenure:** Leasehold (175 years remaining) **Local Authority:** Newham London

**Ground Rent:** £350 p.a. **Council Tax Band:** C

**Service Charge:** £1,900 p.a. **EPC:** C

# Floorplan

507 sq ft | 47.10 sq m

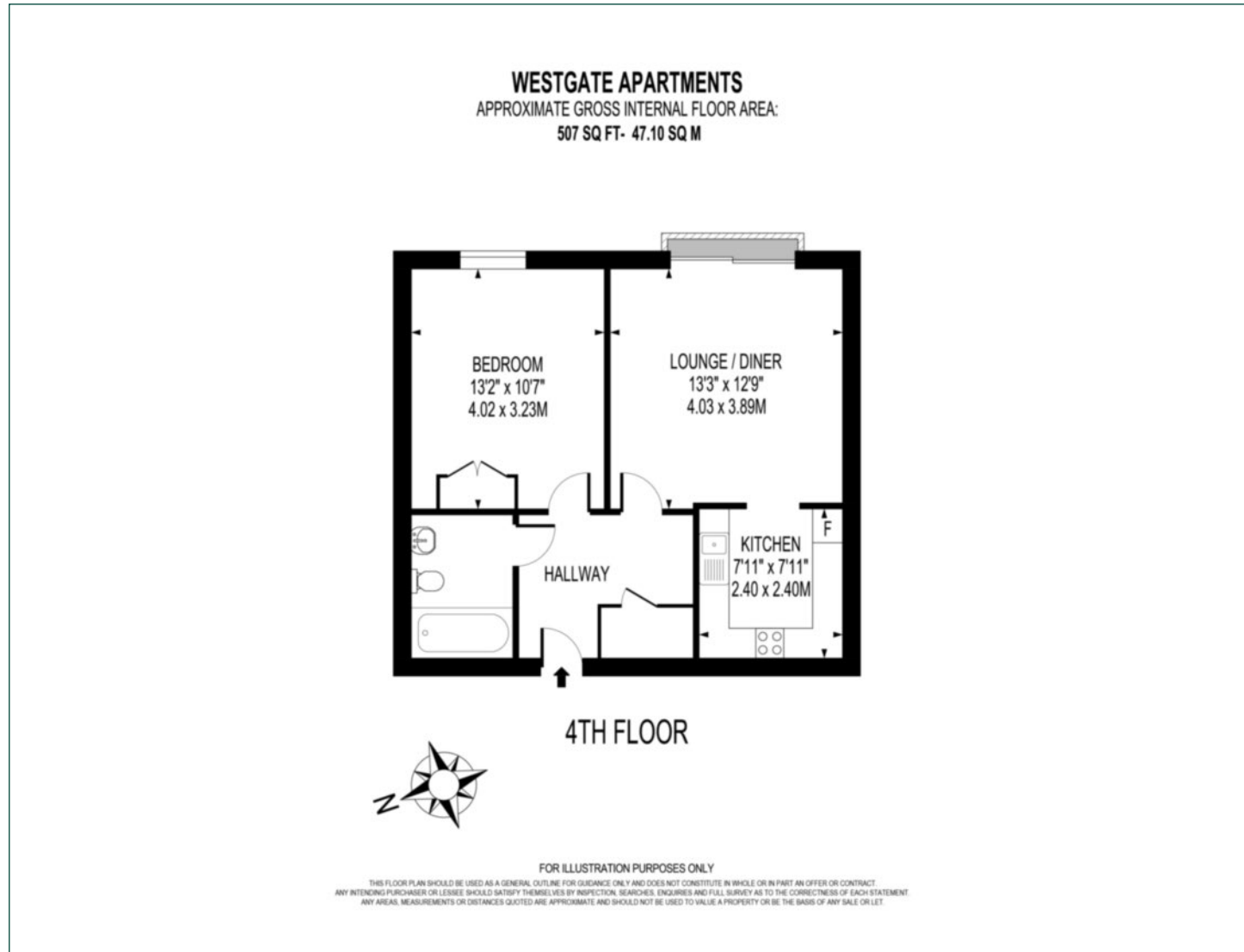

## Docklands

St David's Square, 320 Westferry Road, London, E14 3QL

## Sales

020 7510 8445 | [docklands.sales@chaseevans.co.uk](mailto:docklands.sales@chaseevans.co.uk)

## We're here to help.

IMPORTANT NOTICE - These particulars have been prepared in good faith and they are not intended to constitute part of an offer or contract. We have not performed a structural survey on this property and the services, appliances and specific fittings have not been tested. All photographs, measurements, floor plans and distances referred to are given as a guide and should not be relied upon.

[chaseevans.com](https://www.chaseevans.com)