



## East Tower, 3 Tidal Basin Road, Royal Docks, E16

Asking price **£408,000** | Leasehold



# East Tower, 3 Tidal Basin Road, Royal Docks, E16



1 Bedroom



1 Bathroom



1 Reception



Balcony



Gymnasium



Local Amenities



24-Hour Concierge



0.1 MI Royal Victoria

Modern one bedroom apartment in Hoola, a modern development located on the Royal Docks. This furnished apartment includes a bright, open living and dining area, fitted kitchen with integrated appliances and breakfast bar, tiled flooring, floor-to-ceiling windows, separate dressing area, tiled bathroom suite and a spacious private balcony.

Residents also have access to a 24-hour concierge service and a residents' gymnasium. There are amenities located nearby including restaurants, cafés and shops. The development is located near

Royal Victoria DLR station, providing a valuable transport link for commutes towards Canary Wharf and the City.

**Tenure:** Leasehold (995 years remaining) **Local Authority:** Newham London

**Ground Rent:** TBC **Council Tax Band:** C

**Service Charge:** TBC **EPC:** B

# Floorplan

635 sq ft | 59 sq m

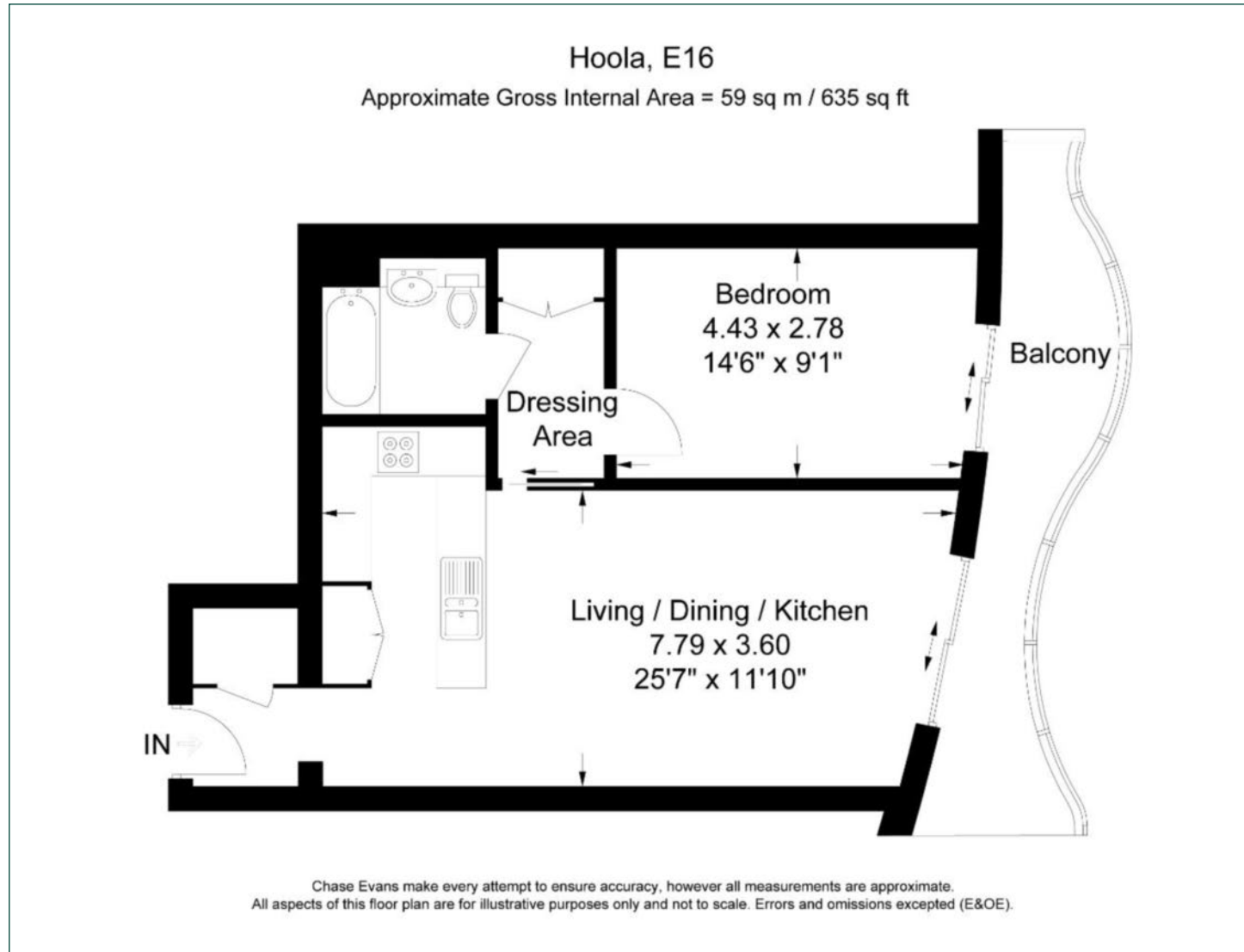

## Docklands

St David's Square, 320 Westferry Road, London, E14 3QL

## Sales

020 7510 8445 | [docklands.sales@chaseevans.co.uk](mailto:docklands.sales@chaseevans.co.uk)

## We're here to help.

IMPORTANT NOTICE - These particulars have been prepared in good faith and they are not intended to constitute part of an offer or contract. We have not performed a structural survey on this property and the services, appliances and specific fittings have not been tested. All photographs, measurements, floor plans and distances referred to are given as a guide and should not be relied upon.

[chaseevans.com](https://chaseevans.com)