



# Church Farm, Ripley

Three-bedroom detached  
house  
available to buy through  
shared ownership



“  
A home of your  
own at a price  
you can afford



ncha

# Specifications

## Kitchen

- Fitted modern kitchen
- Integrated oven and hob
- Stainless steel extractor hood
- Contemporary mixer taps
- Vinyl flooring

## Bathroom

- White suite with chrome fittings
- Tiling to ceiling around the bath
- Shower over bath
- Glass shower screen
- Vinyl flooring

## Heating

- Gas fired central heating
- Thermostatic radiator valves
- Double glazed windows

## External

- Parking space for two cars
- Enclosed rear garden
- EV car charging point
- Fitted security alarm

## Decoration

- White emulsion walls and ceilings
- White gloss painted woodwork
- Carpeted throughout

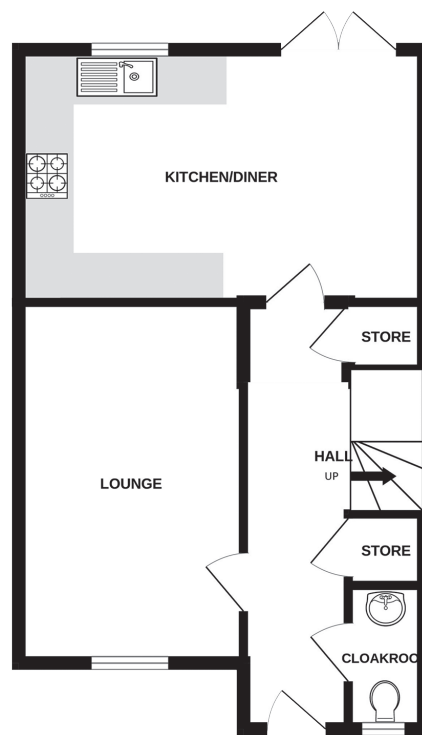

Ground floor

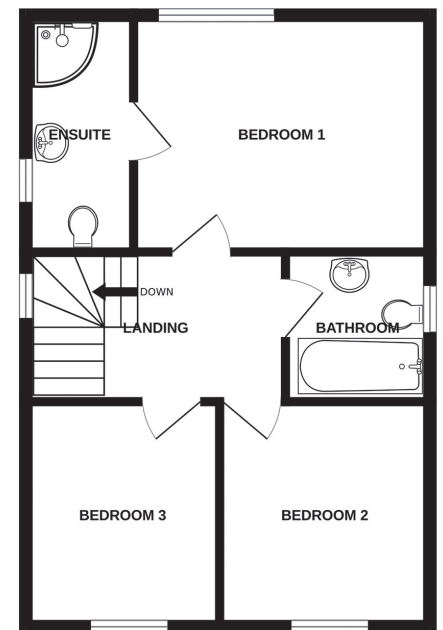

First floor

# Energy assessment

- Predicted energy assessment – A

# Key dimensions

Room	Dimensions
Living room	4.791m x 2.971m
Kitchen/diner	5.221m x 3.297m
Bedroom 1	4.121m x 3.092m
Bedroom 2	2.756m x 2.870m
Bedroom 3	2.933m x 2.325m

Any measurements quoted are approximate and must be checked on site and against the layout, which may vary due to unforeseen circumstances. Floor plans may be mirror handed. These details have been produced for illustrative purposes only and does not form any part of a contract or constitute an offer. Actual specification may vary from that shown in floor plan.

## How to find us

The development is located on Church Farm in Ripley. If using a SatNav, the postcode is DE5 3TR.

## Buying more shares

The homes are sold on a standard shared ownership lease, so you can purchase more shares to 100% and acquire the freehold.



0345 650 1204  
nchasales@ncha.org.uk  
www.ncha.org.uk

@NCHASalesTeam  
@NCHASales