

FOR SALE



Greenwood Court, Upper Holly Walk, Leamington Spa

4 Bedrooms, 1 Bathroom, Mid Terraced House

£450,000

MARTIN&CO



- Four bedrooms
- Kitchen / dining room
- Downstairs cloakroom
- Spacious first floor living room
- Ideal family home
- Secluded location close to town
- Garage and off road parking

This four bedroom three storey town house is located in the heart of Leamington Spa tucked away in a quiet spot with easy access to Newbold Comyn and the open countryside. With four well proportioned bedrooms, open plan kitchen dining room, downstairs cloakroom and spacious living room on the first floor. Externally there is a secluded rear garden, garage and off road parking. The property is situated perfectly for access to the town, station, schools and local amenities.

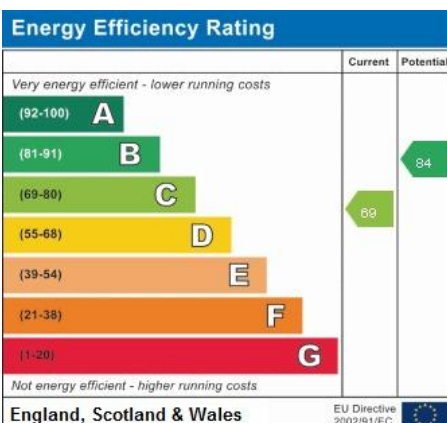



Approach Path and driveway leading to the front door.

Hallway With understairs cupboard, tiled flooring, radiator, further storage cupboard and doors to cloakroom and kitchen dining room.

Cloakroom With low level w.c., wash hand basin, tiled flooring and single glazed window to the front.

Kitchen Dining Room Fitted with a range of wall and base mounted units having complementary work surfaces over incorporating a sink and drainer unit, tiling to the splashback areas, gas cooker point, space and plumbing for washing machine, space for fridge freezer, double glazed patio doors and double glazed window to the rear.

First Floor Landing With stairs rising from hallway, stairs rising to the second floor, cupboard housing central heating boiler and doors to living room and bedroom.

Bedroom One With radiator, double glazed window to the front and alcove with low level W.C and wash hand basin.

Living Room With radiator, double glazed window to the rear and built in cupboard.



Second Floor Landing With stairs rising from the first floor landing and doors off to the bedrooms and bathroom.

Bedroom Two With radiator and two double glazed windows to the front.

Bedroom Three With radiator and double glazed window to the rear.

Bedroom Four With radiator and double glazed window to the rear.

Bathroom Fitted with a suite comprising of a panelled bath with Bristan electric shower over, wash hand basin, low level W.C., heated towel rail and wood laminate flooring.

Garage With up and over door.

Outside To the front there is a driveway.

To the rear of the property is a fence enclosed mature garden, with stepping stones leading to the bottom of the garden and to the gate giving rear access to the property.

Council tax band - D

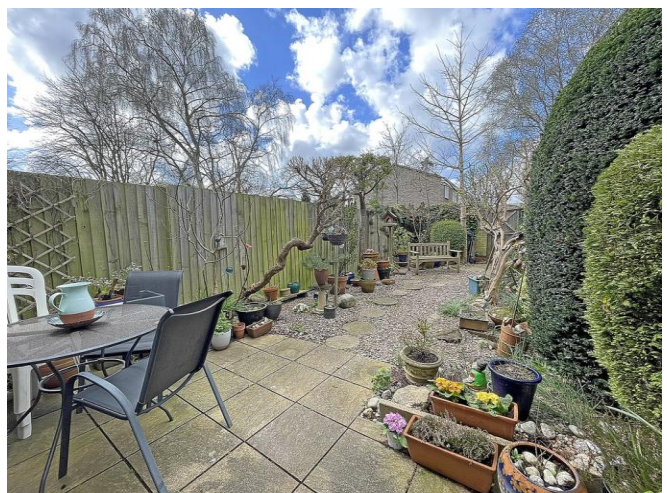

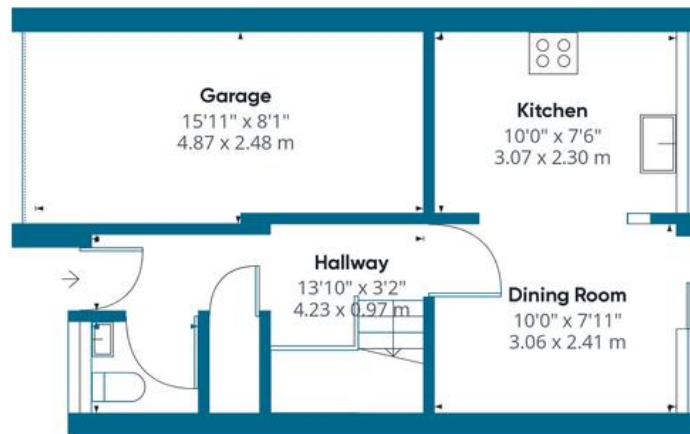
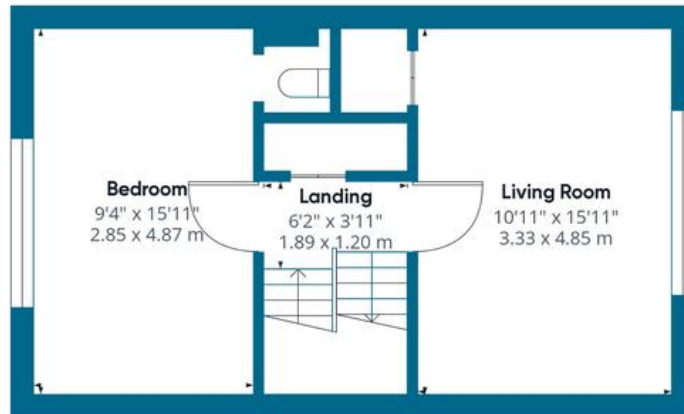
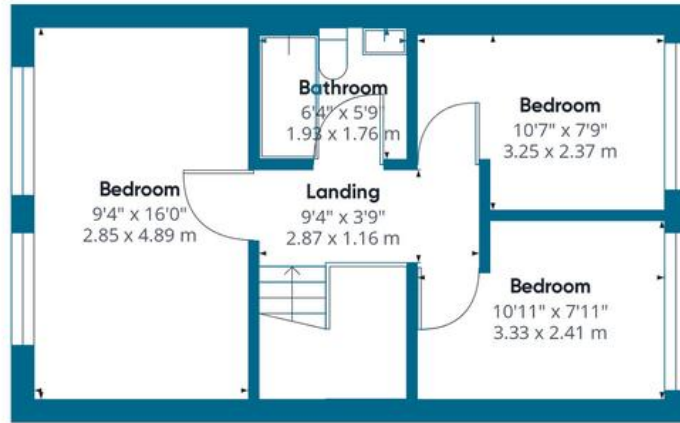

Approximate total area

1203.5 ft²

111.81 m²

Martin & Co Leamington Spa **01926 889 054**
 38 Hamilton Terrace • Holly Walk • Leamington Spa •
 CV32 4LY <http://www.martinco.com>
 T: 01926 889 054 • E: leamingtonspa@martinco.com



Accuracy: References to the Tenure of a Property are based on information supplied by the Seller. The Agent has not had sight of the title documents. A Buyer is advised to obtain verification from their Solicitor. Items shown in photographs including but not limited to carpets, fixtures and fittings are not included unless specifically mentioned within the sales particulars. They may however be available by separate negotiation. Buyers must check the availability of any property and make an appointment to view before embarking on any journey to see a property. No person in the employment of the agent has any authority to make any representation about the property, and accordingly any information given is entirely without responsibility on the part of the agents, sellers(s) or lessors(s). Any property particulars are not an offer or contract, nor for any part of one. **Sonic / Laser Tape:** Measurements taken using a sonic / Laser tape measure may be subject to a small margin of error. **All Measurements:** All Measurements are Approximate. **Services Not tested:** The Agent has not tested any apparatus, equipment, fixtures and fittings or services and so cannot verify that they are in working order or fit for the purpose. A Buyer is advised to obtain verification from their Solicitor or Surveyor.