



jordanfishwick

Apt 2 Regents Court, 6 Oldham Street, M1
£1,250 Per Calendar Month



Regents Court Northern Quarter M1 1JQ

£1,250 Per Calendar Month



The Property

PLEASE NOTE - 6 MONTH TENANCY ONLY

Available Late January. Jordan Fishwick presents this renovated 1st floor one bedroom apartment is located on Oldham St, a bustling street in the Northern Quarter. The 850 sq.ft property has to be one of the biggest one beds in the area and benefits from secondary glazing and wet electric heating. Entrance hall with deep storage cupboard, fully fitted kitchen with appliances and breakfast bar, spacious living room, large double bedroom with fitted rails, shower room has walk in shower with rain and body attachment. No Parking. Tax Band D. EPC rating D.

VIDEO/ PHOTO OFFERS NOT ACCEPTED - PLEASE CALL TO BOOK A VIEWING

- Available Late January - 6 month tenancy ONLY
- 1st Floor Apartment - 850 Sq.Ft
- Large Living Area
- Bedroom With Dressing Area
- EPC Rating D
- Council Tax Band D
- Wet Electric Heating
- Modern Shower Room
- Great Location



Energy Efficiency Rating		
	Current	Potential
Very energy efficient - lower running costs		
(92 plus) A		
(81-91) B		
(69-80) C		
(55-68) D	57	62
(39-54) E		
(21-38) F		
(1-20) G		
Not energy efficient - higher running costs		
England & Wales	EU Directive 2002/91/EC 	



GROUND FLOOR

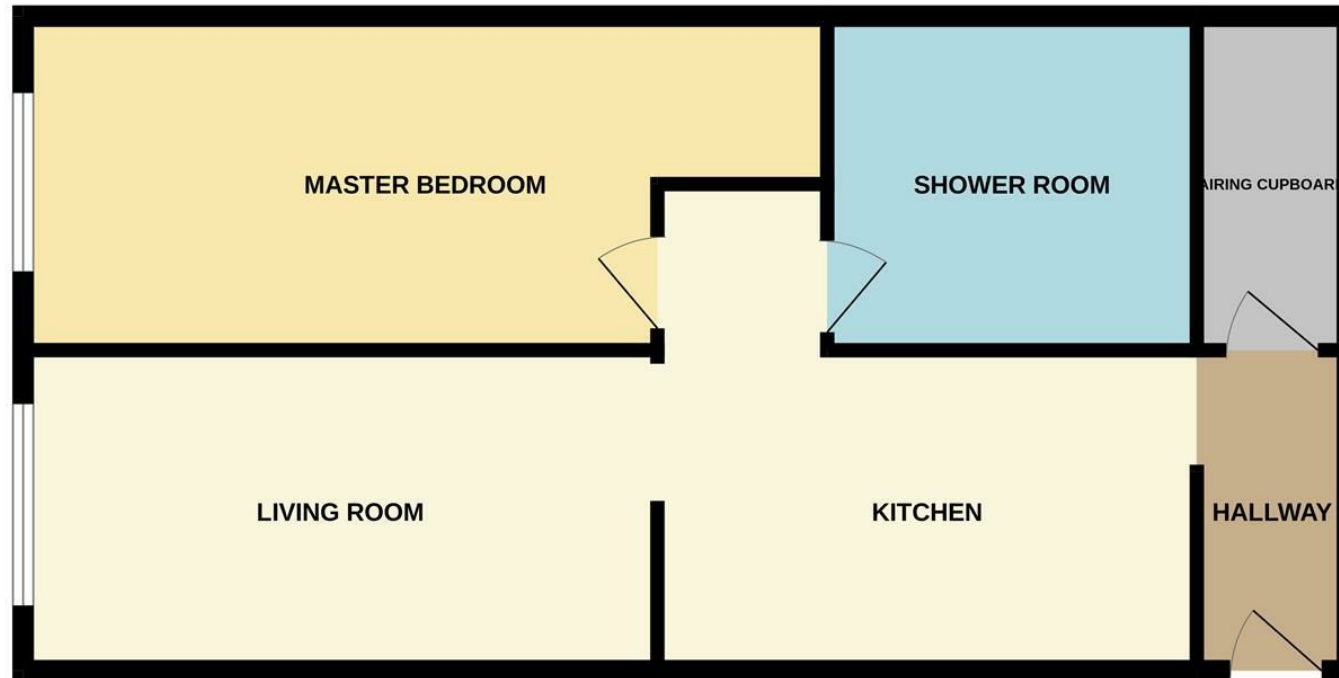

Measurements are approximate. Not to scale. Illustrative purposes only
Made with Metropix ©2025



These particulars are believed to be accurate but they are not guaranteed and do not form a contract. Neither Jordan Fishwick nor the vendor or lessor accept any responsibility in respect of these particulars, which are not intended to be statements or representations of fact and any intending purchaser or lessee must satisfy himself by inspection or otherwise as to the correctness of each of the statements contained in these particulars. Any floorplans on this brochure are for illustrative purposes only and are not necessarily to scale.

Offices at: Offices at Chorlton, Didsbury, Disley, Hale, Glossop, Macclesfield, Manchester Deansgate, Manchester Whitworth Street, New Mills, Sale, Wilmslow and Withington